

STAGE 2 CONSTRUCTION SCHEDULE
(FOR INFORMATION ONLY)

F.A.P. RTE.	SECTION	COUNTY	TOTAL SHEETS	SHEET NO.
95	*	JASPER	546	115
STA. 710+00.00		TO STA. 740+00.00		
FED. ROAD DIST. NO.		ILLINOIS	FED. AID PROJECT	
*(5,6)Y,RS-2,6BR-7				
CONTRACT NO. 94437				

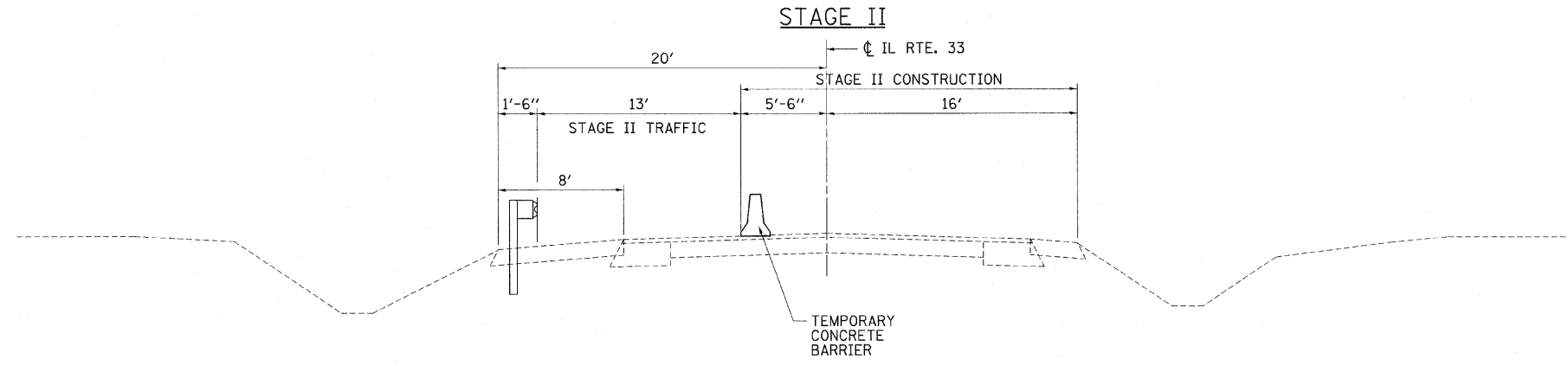

STAGING TYPICAL SECTION
STA. 904+25 TO 912+50

PAVEMENT REMOVAL

BOGOTA ROAD	=	2945	SQ. YD.
TOTAL	=	2945	SQ. YD.

TEMPORARY PAVEMENT MARKING - LINE 4" ***

STA. 1175+07 TO STA. 1181+43 (YELLOW)	=	1,272	FOOT
TOTAL	=	1,272	FOOT

RELOCATE TEMPORARY CONCRETE BARRIER

STA. 1176+90 TO STA. 1179+40	=	250	FOOT
TOTAL	=	250	FOOT

TEMPORARY PAVEMENT MARKING - LINE 24" ***

RT. STA. 1175+07	=	12	FOOT
RT. STA. 1181+33	=	12	FOOT
TOTAL	=	24	FOOT

IMPACT ATTENUATORS, RELOCATE (NON-REDIRECTIVE), TEST LEVEL 2

LT. STA. 1176+67	=	1	EACH
LT. STA. 1179+63	=	1	EACH
TOTAL	=	2	EACH

GUARDRAIL REMOVAL

LT. STA. 1176+13 TO STA. 1178+48	=	235	FOOT
RT. STA. 1175+41 TO STA. 1178+01	=	285	FOOT
TOTAL	=	520	FOOT

WORK ZONE PAVEMENT MARKING REMOVAL **

STA. 1175+07, RT.	=	24	SQ. FT.
STA. 1175+07 TO STA. 1181+43	=	424	SQ. FT.
STA. 1181+43, LT.	=	24	SQ. FT.
TOTAL	=	472	SQ. FT.

PAVEMENT PATCHING, TYPE IV 14"

RT. STA. 1178+20	=	65	SQ. YD.
TOTAL	=	65	SQ. YD.

HOT-MIX ASPHALT SHOULDERS, 8"

RT. STA. 1177+95 TO STA. 1178+40	=	15	SQ. YD.
TOTAL	=	15	SQ. YD.

- NOTE:**
- SEE SHEET NO. 97 FOR ADDITIONAL QUANTITIES.
 - REMOVED UPON COMPLETION OF STAGE 2
 - PAID FOR UNDER TRAFFIC CONTROL AND PROTECTION, STANDARD 701321.

ILLINOIS DEPARTMENT OF TRANSPORTATION
STAGE 2 CONSTRUCTION SCHEDULE OF QUANTITIES
BOGOTA ROAD CONSTRUCTION

FAP ROUTE 95 (IL RTE. 33)
SECTION (5,6)Y,RS-2,6BR-7
JASPER COUNTY

SCALE: VERT. _____
HORIZ. _____
DATE: 04/15/03

DESIGNED BY: BISHOP
CHECKED BY: COLBROOK

COMPUTER FILE NO.
STG2.CULV - 02

PROJECT 01256
1/18/10-FAV

GREENE & BRADFORD, INC.
CONSULTING ENGINEERS
OF SPRINGFIELD
PROFESSIONAL & STRUCTURAL ENGINEERING CORPORATION
1075 VES-2000, 207 1/2 WEST 41ST ST., SPRINGFIELD, ILLINOIS 62761

REVISIONS	
NAME	DATE

DESIGN		
INT.	DATE	REASON

PLOTS & CHECKS		
INT.	DATE	REASON

CHECKS		
INT.	DATE	REASON