

DESIGN		
INT.	DATE	REASON

F.A.P. RTE.	SECTION	COUNTY	TOTAL SHEETS	SHEET NO.
95		JASPER	546	122
STA. 925+00.00		TO STA. 955+00.00		
FED. ROAD DIST. NO.		ILLINOIS	FED. AID PROJECT	
*15,61Y,RS-2,6BR-7				
CONTRACT NO. 94437				

PLOTS & CHECKS		
INT.	DATE	REASON

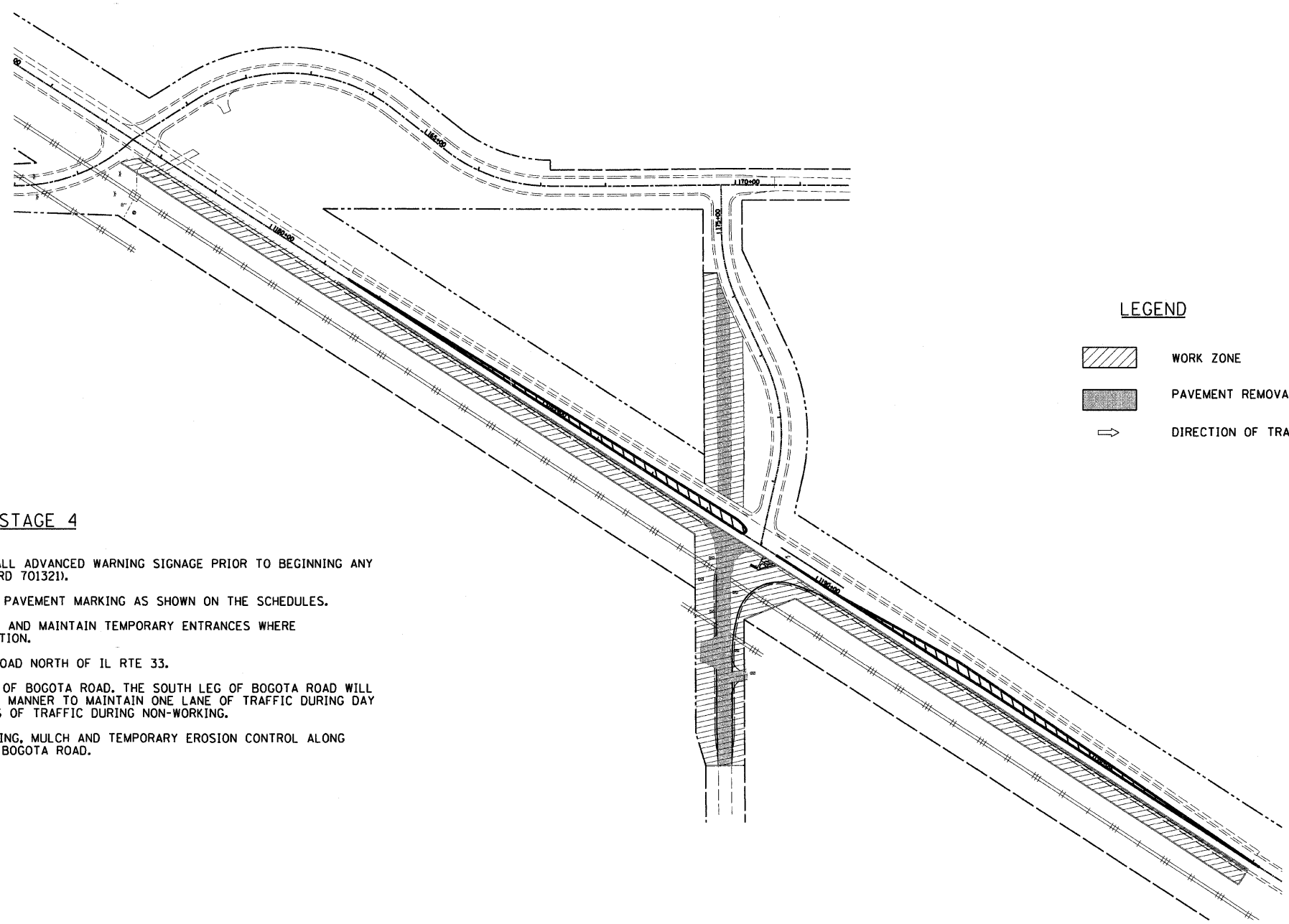
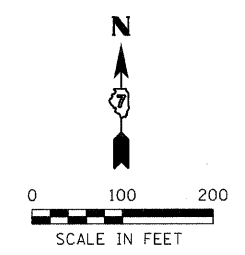

- LEGEND**
- WORK ZONE
  - PAVEMENT REMOVAL
  - DIRECTION OF TRAFFIC

**STAGE 4**

1. CONTRACTOR SHALL PLACE ALL ADVANCED WARNING SIGNAGE PRIOR TO BEGINNING ANY CONSTRUCTION (SEE STANDARD 701321).
2. CONSTRUCT ALL TEMPORARY PAVEMENT MARKING AS SHOWN ON THE SCHEDULES.
3. CONTRACTOR SHALL PROVIDE AND MAINTAIN TEMPORARY ENTRANCES WHERE REQUIRED DURING CONSTRUCTION.
4. REMOVE EXISTING BOGOTA ROAD NORTH OF IL RTE 33.
5. CONSTRUCT THE SOUTH LEG OF BOGOTA ROAD. THE SOUTH LEG OF BOGOTA ROAD WILL BE CONSTRUCTED IN SUCH A MANNER TO MAINTAIN ONE LANE OF TRAFFIC DURING DAY TIME HOURS AND TWO LANES OF TRAFFIC DURING NON-WORKING.
6. CONSTRUCT REMAINING SEEDING, MULCH AND TEMPORARY EROSION CONTROL ALONG IL RTE 33, P.R. 1000N AND BOGOTA ROAD.

CHECKS		
INT.	DATE	REASON

REVISIONS	
NAME	DATE

ILLINOIS DEPARTMENT OF TRANSPORTATION  
**STAGE 4 CONSTRUCTION**  
**PLAN OVERVIEW**  
**BOGOTA ROAD CONSTRUCTION**

FAP ROUTE 95 (IL RTE. 33)  
SECTION (5,61Y,RS-2,6BR-7)  
JASPER COUNTY

SCALE: VERT. \_\_\_\_\_  
HORIZ. \_\_\_\_\_  
DATE: 04/15/03

DRAWN BY: BISHOP  
DESIGNED BY: COLBROOK  
CHECKED BY: COLBROOK

**GREENE & BRADFORD, INC.**  
OF SPRINGFIELD  
CONSULTING ENGINEERS  
PROFESSIONAL ENGINEER NO. 121-0019  
PROFESSIONAL SURVEYOR NO. 121-0019  
2011-2014, 2017-2020 FILE NO. 121-0019-0001

COMPUTER FILE NO. STG4\_CULV - 100  
PROJECT 01256  
2/26/10-FAV