

DESIGN		
INT.	DATE	REASON

F.A.P. RTE.	SECTION	COUNTY	TOTAL SHEETS	SHEET NO.
95	•	JASPER	546	150
STA. 925+00.00 TO STA. 940+00.00				
FED. ROAD DIST. NO. ILLINOIS FED. AID PROJECT				
*15,61Y,RS-2,6BR-7				
CONTRACT NO. 94437				

EROSION CONTROL	
LOCATION	TEMPORARY DITCH CHECKS
	FOOT
STA. 930+00, LT.	10
STA. 930+00, RT.	10
STA. 935+00, LT.	10
STA. 935+00, RT.	10
STA. 939+85, LT.	10
STA. 939+85, RT.	10
TOTALS	60

- LEGEND**
- INLET AND PIPE PROTECTION
 - TEMPORARY DITCH CHECK
 - PERIMETER EROSION BARRIER
 - SEEDING, CLASS 1
 - SEEDING, CLASS 2
 - SEEDING, CLASS 5 (SPECIAL)
 - EROSION CONTROL BLANKET
 - TURF REINFORCEMENT MAT

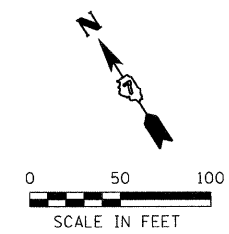

PLOTS & CHECKS		
INT.	DATE	REASON

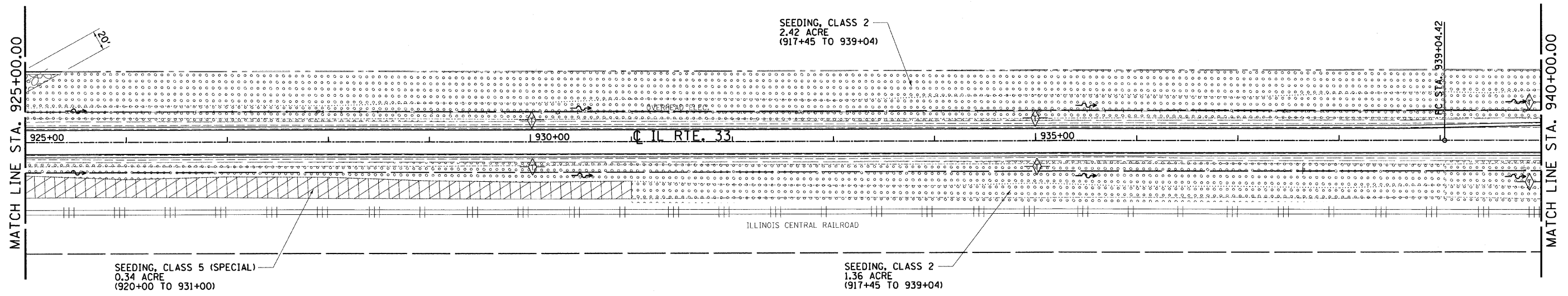

CHECKS		
INT.	DATE	REASON

REVISIONS		
NAME	DATE	
MDS	9/4/09	
ADD SEED, CL 5		

ILLINOIS DEPARTMENT OF TRANSPORTATION
EROSION AND SEDIMENT CONTROL PLANS
 FAP ROUTE 95 (IL RTE. 33)
 SECTION (5,6)Y,RS-2,6BR-7
 JASPER COUNTY

SCALE: VERT. _____
 HORIZ. _____
 DATE: 09/16/02

DRAWN BY: BISHOP
 DESIGNED BY: COLBROOK
 CHECKED BY: COLBROOK

COMPUTER FILE NO.
 EC-12 - A - 50
 PROJECT 01256
 2/26/10-FAV

GREENE & BRADFORD, INC.
 OF SPRINGFIELD