

DESIGN		
INT.	DATE	REASON

EROSION CONTROL		
LOCATION	TEMPORARY	INLET AND PIPE PROTECTION
	DITCH CHECKS	
	FOOT	EACH
STA. 1135+00, LT.	10	
STA. 1135+00, RT.	10	
STA. 1136+65, LT.		1
STA. 1138+87, RT.		2
STA. 1142+00, LT.	10	
STA. 1142+00, RT.	10	
STA. 1147+00, LT.	10	
STA. 1147+00, RT.	10	
STA. 1153+46, LT.		2
STA. 1153+90, RT.		2
STA. 1154+20, LT.		2
TOTALS	60	9

- LEGEND**
- INLET AND PIPE PROTECTION
 - TEMPORARY DITCH CHECK
 - PERIMETER EROSION BARRIER
 - SEEDING, CLASS 1
 - SEEDING, CLASS 2
 - EROSION CONTROL BLANKET
 - TURF REINFORCEMENT MAT

F.A.P. RTE.	SECTION	COUNTY	TOTAL SHEETS	SHEET NO.
95		JASPER	546	158
STA. 1130+00.00 TO STA. 1160+00.00				
FED. ROAD DIST. NO. ILLINOIS FED. AID PROJECT				
*15,61Y,RS-2,6BR-7				
CONTRACT NO. 94437				

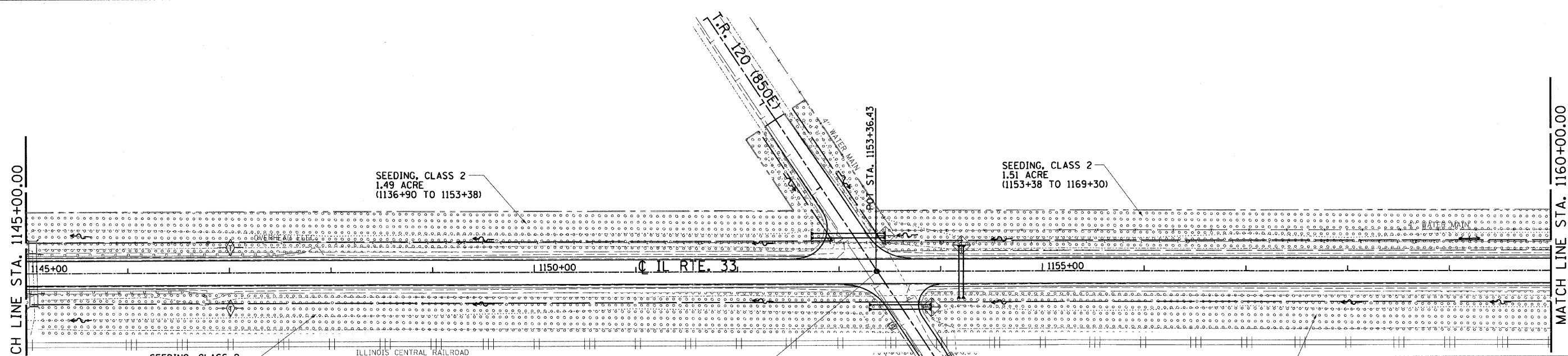
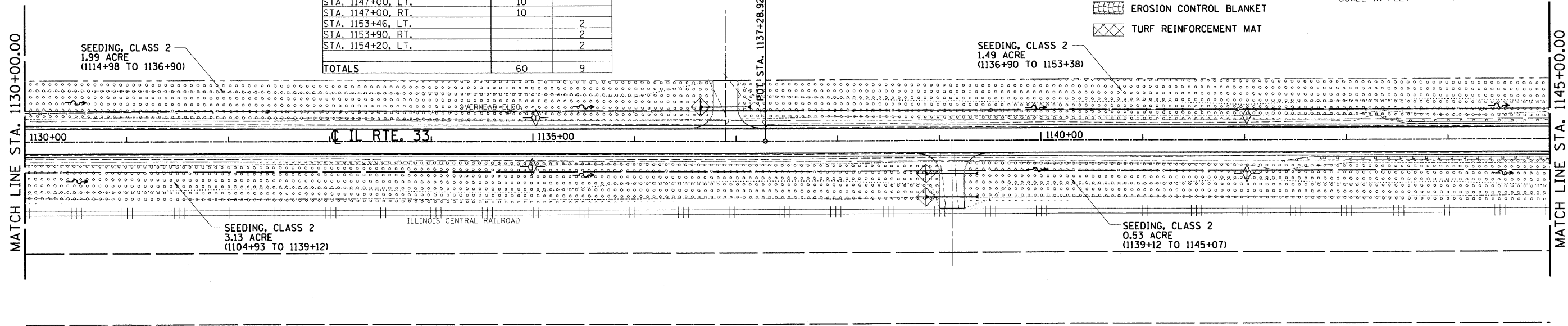
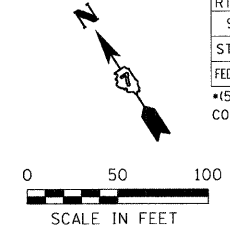

PLOTS & CHECKS		
INT.	DATE	REASON

CHECKS		
INT.	DATE	REASON

REVISIONS	
NAME	DATE

ILLINOIS DEPARTMENT OF TRANSPORTATION
EROSION AND SEDIMENT CONTROL PLANS
 FAP ROUTE 95 (IL RTE. 33)
 SECTION (5,61Y,RS-2,6BR-7)
 JASPER COUNTY

SCALE: VERT. _____
 HORIZ. _____
 DATE: 09/16/02

DRAWN BY: BISHOP
 DESIGNED BY: COLBROOK
 CHECKED BY: COLBROOK

COMPUTER FILE NO.
 EC-19 - 50
 PROJECT 01256
 2/26/10-FAV

GREENE & BRADFORD, INC.
 OF ENGINEERS
 CIVIL ENGINEERS
 SPRINGFIELD, ILLINOIS 62701
 PROFESSIONAL ENGINEERS NO. 0207
 ILLINOIS PROFESSIONAL ENGINEERS ASSOCIATION
 401 N. 5TH ST., 2ND FLOOR, ST. LOUIS, MO 63102-1000