

DESIGN		
INT.	DATE	REASON

PLOTS & CHECKS		
INT.	DATE	REASON

CHECKS		
INT.	DATE	REASON

F.A.P. RTE.	SECTION	COUNTY	TOTAL SHEETS	SHEET NO.
95	.	JASPER	546	159
STA. 1160+00.00		TO STA. 1172+50.00		
FED. ROAD DIST. NO.		ILLINOIS	FED. AID PROJECT	
+15,61Y,RS-2,6BR-7				
CONTRACT NO. 94437				

EROSION CONTROL		
LOCATION	TEMPORARY DITCH CHECKS	INLET AND PIPE PROTECTION
	FOOT	EACH
STA. 1165+00, L.T.	10	
STA. 1165+00, RT.	10	
STA. 1168+87, L.T.		1
STA. 1169+46, RT.		1
TOTALS	20	2

LEGEND	
	INLET AND PIPE PROTECTION
	TEMPORARY DITCH CHECK
	PERIMETER EROSION BARRIER
	SEEDING, CLASS 1
	SEEDING, CLASS 2
	EROSION CONTROL BLANKET
	TURF REINFORCEMENT MAT

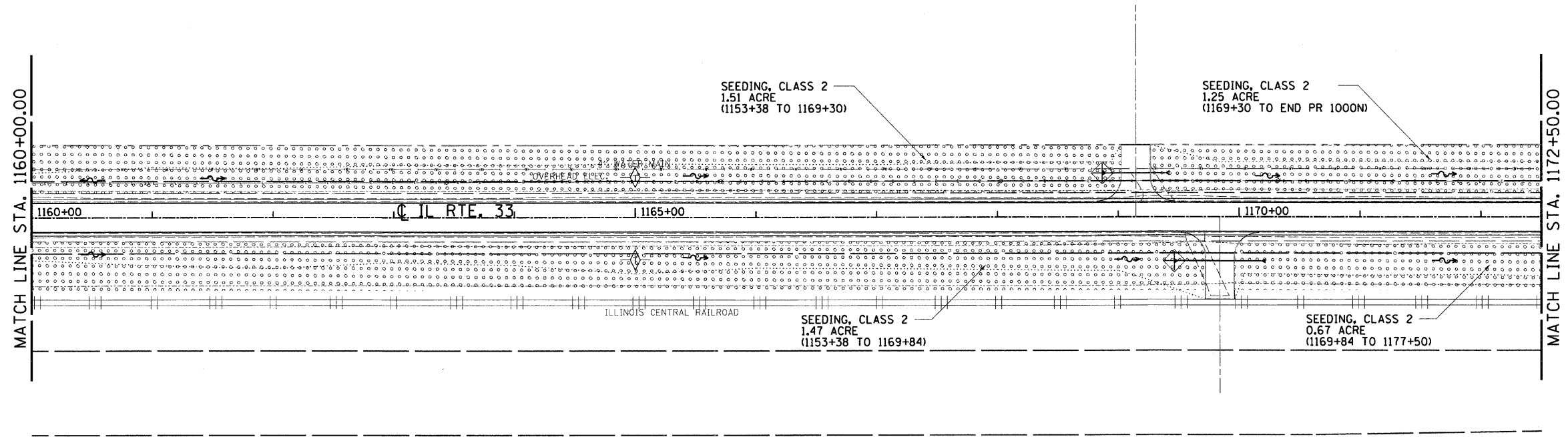
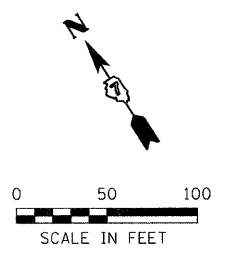

ILLINOIS DEPARTMENT OF TRANSPORTATION
EROSION AND SEDIMENT CONTROL PLANS
 FAP ROUTE 95 (IL RTE. 33)
 SECTION (5,6)Y,RS-2,6BR-7
 JASPER COUNTY

SCALE: VERT. _____
 HORIZ. _____
 DATE: 09/16/02

DRAWN BY: BISHOP
 DESIGNED BY: COLBROOK
 CHECKED BY: COLBROOK

COMPUTER FILE NO.
 EC-20 - A - 50

PROJECT 01256
 2/26/10-FAV

GREENE & BRADFORD, INC.
 OF SPRINGFIELD
 REGISTERED PROFESSIONAL ENGINEERS
 ILLINOIS NO. 121147 & 121148

REVISIONS	
NAME	DATE