

DESIGN		
INT.	DATE	REASON

F.A.P. RTE.	SECTION	COUNTY	TOTAL SHEETS	SHEET NO.
95	*	JASPER	546	160
STA. 1172+50.00		TO STA. 1185+00.00		
FED. ROAD DIST. NO.		ILLINOIS FED. AID PROJECT		
*5,6Y,RS-2,6BR-7		CONTRACT NO. 94437		

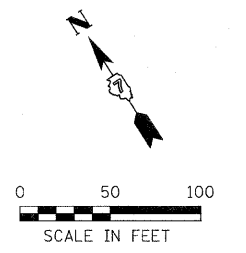

EROSION CONTROL		
LOCATION	TEMPORARY DITCH CHECKS	INLET AND PIPE PROTECTION
	FOOT	EACH
STA. 1173+00, LT.	10	
STA. 1173+00, RT.	10	
STA. 1176+75, RT.		1
STA. 1177+39, LT.		1
STA. 1178+80, RT.	10	
STA. 1183+00, LT.	10	
STA. 1183+00, RT.	10	
T.R. 201 (1000N)		
STA. 158+42, LT.		1
STA. 161+80, RT.		2
TOTALS	50	5

PLOTS & CHECKS		
INT.	DATE	REASON

- LEGEND**
- INLET AND PIPE PROTECTION
 - TEMPORARY DITCH CHECK
 - PERIMETER EROSION BARRIER
 - SEEDING, CLASS 1
 - SEEDING, CLASS 2
 - EROSION CONTROL BLANKET
 - TURF REINFORCEMENT MAT

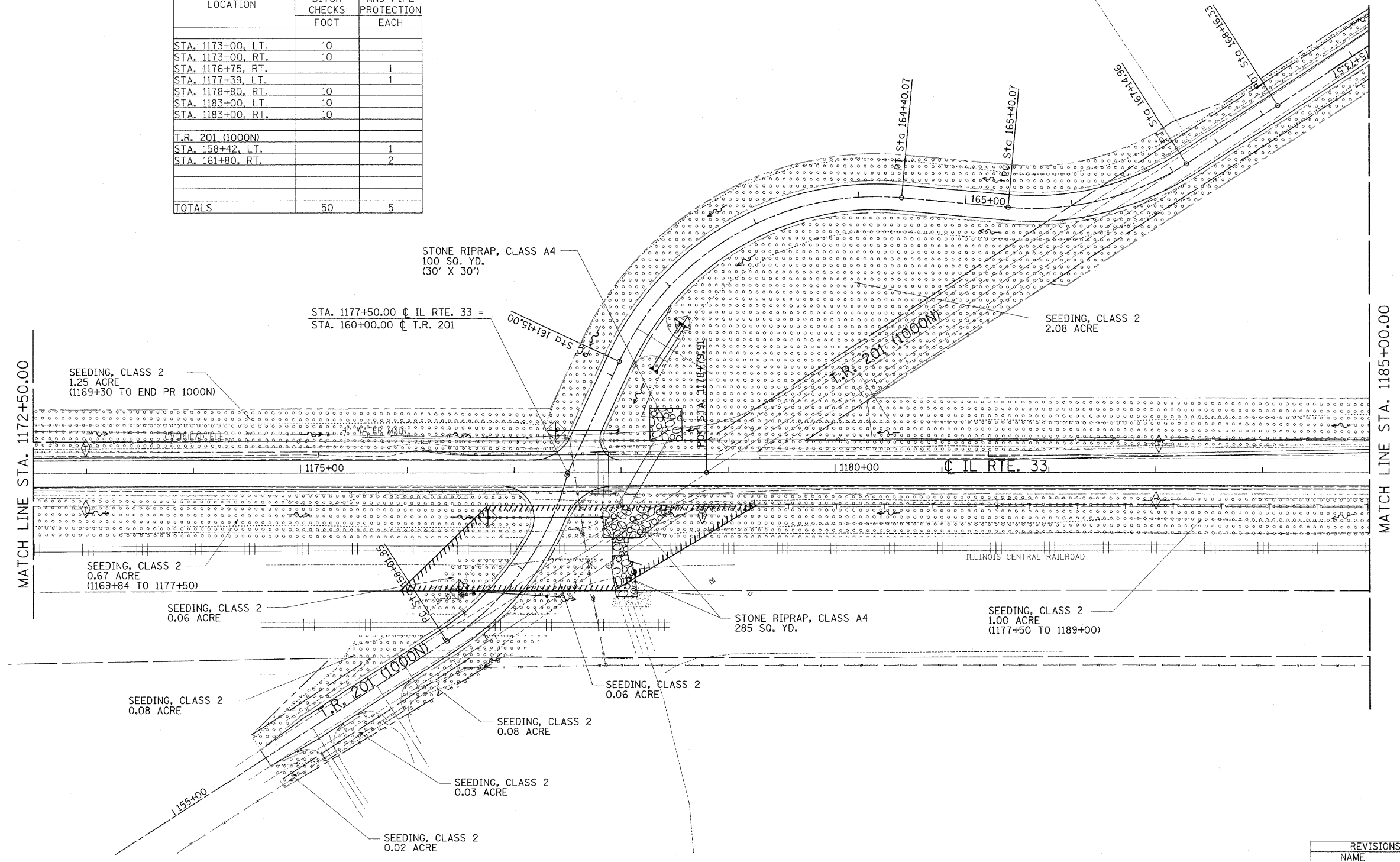

CHECKS		
INT.	DATE	REASON

REVISIONS	
NAME	DATE

ILLINOIS DEPARTMENT OF TRANSPORTATION
EROSION AND SEDIMENT CONTROL PLANS
 FAP ROUTE 95 (IL RTE. 33)
 SECTION (5,6)Y,RS-2,6BR-7
 JASPER COUNTY

SCALE: VERT. _____
 HORIZ. _____
 DATE: 09/16/02

DRAWN BY: BISHOP
 DESIGNED BY: COLBROOK
 CHECKED BY: COLBROOK

COMPUTER FILE NO.
 EC-20 - B - 50

PROJECT 01256
 3/10/10-MDS

GREENE & BRADFORD, INC.
 10 SPRINGFIELD
 CONSULTING ENGINEERS
 PROFESSIONAL ENGINEERS LICENSE NO. 021-000000
 PROFESSIONAL DESIGNER LICENSE NO. 021-000000
 PROFESSIONAL SURVEYOR LICENSE NO. 021-000000