

DESIGN		
INT.	DATE	REASON

F.A.P. RTE.	SECTION	COUNTY	TOTAL SHEETS	SHEET NO.
95	•	JASPER	546	164
STA. 1225+00.00 TO STA. 2235+00.00				
FED. ROAD DIST. NO. ILLINOIS FED. AID PROJECT				
*15,61Y,RS-2,6BR-7				
CONTRACT NO. 94437				

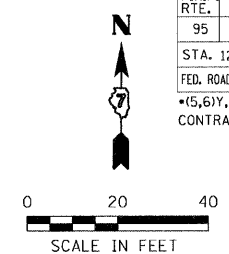

LEGEND

- INLET AND PIPE PROTECTION
- TEMPORARY DITCH CHECK
- PERIMETER EROSION BARRIER
- SEEDING, CLASS 1
- SEEDING, CLASS 2
- EROSION CONTROL BLANKET
- TURF REINFORCEMENT MAT

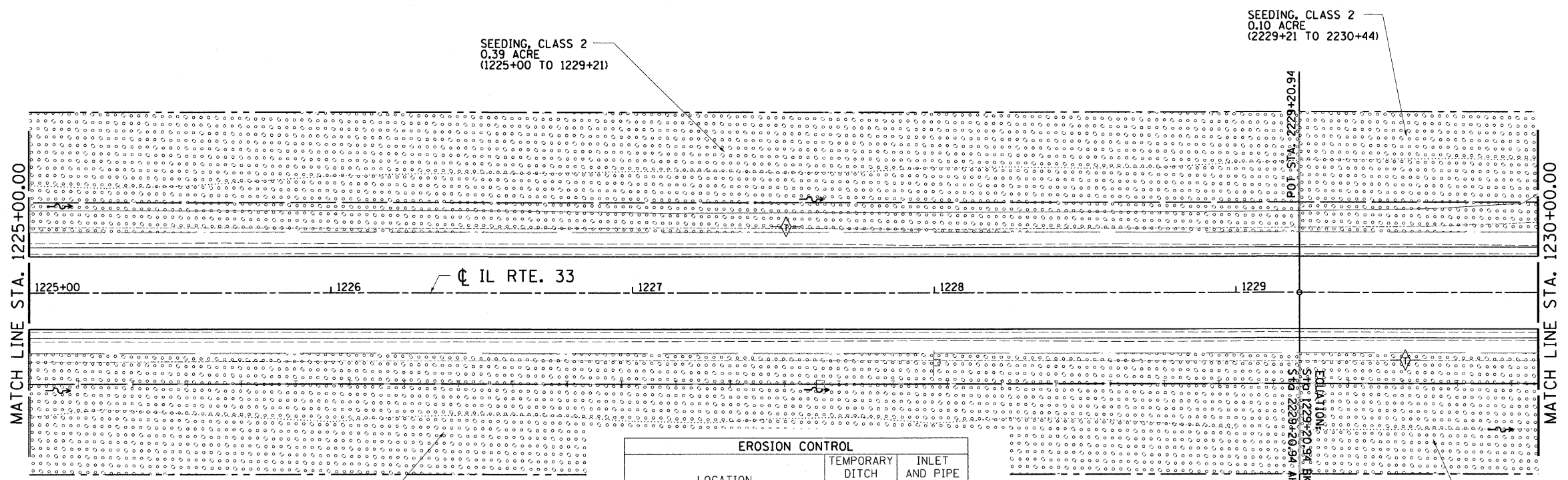

EROSION CONTROL		
LOCATION	TEMPORARY DITCH CHECKS FOOT	INLET AND PIPE PROTECTION EACH
STA. 1227+50, LT.	10	
STA. 2229+50, RT.	10	
STA. 2230+16, LT.		1
STA. 2231+40, RT.		1
STA. 2232+81, LT.		1
STA. 2234+87, RT.		1
TOTALS	20	4

PLOTS & CHECKS		
INT.	DATE	REASON

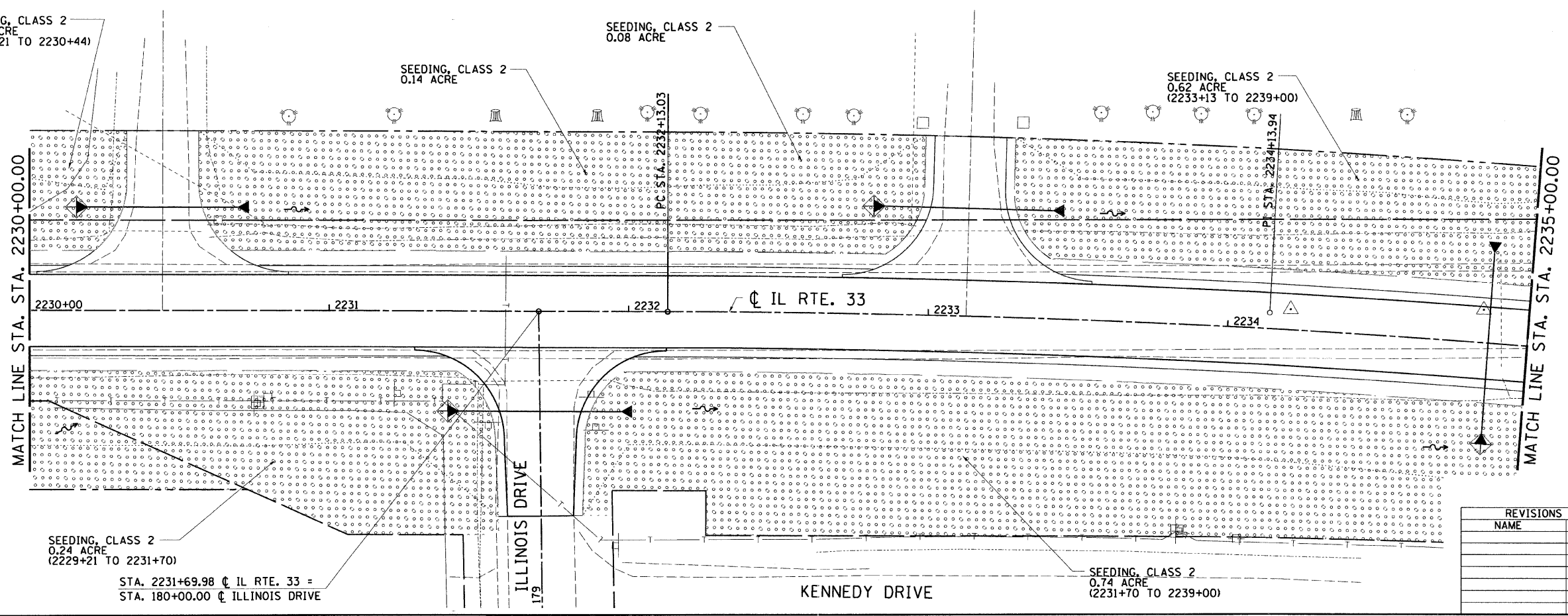

REVISIONS	
NAME	DATE

ILLINOIS DEPARTMENT OF TRANSPORTATION
EROSION AND SEDIMENT CONTROL PLANS
 FAP ROUTE 95 (IL RTE. 33)
 SECTION (5,61Y,RS-2,6BR-7)
 JASPER COUNTY

SCALE: VERT. 1"=20'
 HORIZ. 1"=40'
 DATE: 09/16/02

DRAWN BY: BISHOP
 DESIGNED BY: COLBROOK
 CHECKED BY: COLBROOK

GREENE & BRADFORD, INC.
 OF SPRINGFIELD

COMPUTER FILE NO. EC-23 - 20
 PROJECT 01256
 2/26/10-FAV

CHECKS		
INT.	DATE	REASON