

DESIGN		
INT.	DATE	REASON

PLOTS & CHECKS			
INT.	DATE	NO.	REASON

CHECKS		
INT.	DATE	REASON

F.A.P. RTE.	SECTION	COUNTY	TOTAL SHEETS	SHEET NO.
95	*	JASPER	546	165
STA. 2235+00.00		TO STA. 2245+00.00		
FED. ROAD DIST. NO. ILLINOIS FED. AID PROJECT				
*5,6Y,RS-2,6BR-7				
CONTRACT NO. 94437				

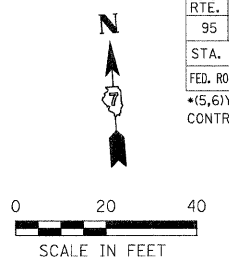

LEGEND

- INLET AND PIPE PROTECTION
- TEMPORARY DITCH CHECK
- PERIMETER EROSION BARRIER
- SEEDING, CLASS 1
- SEEDING, CLASS 2

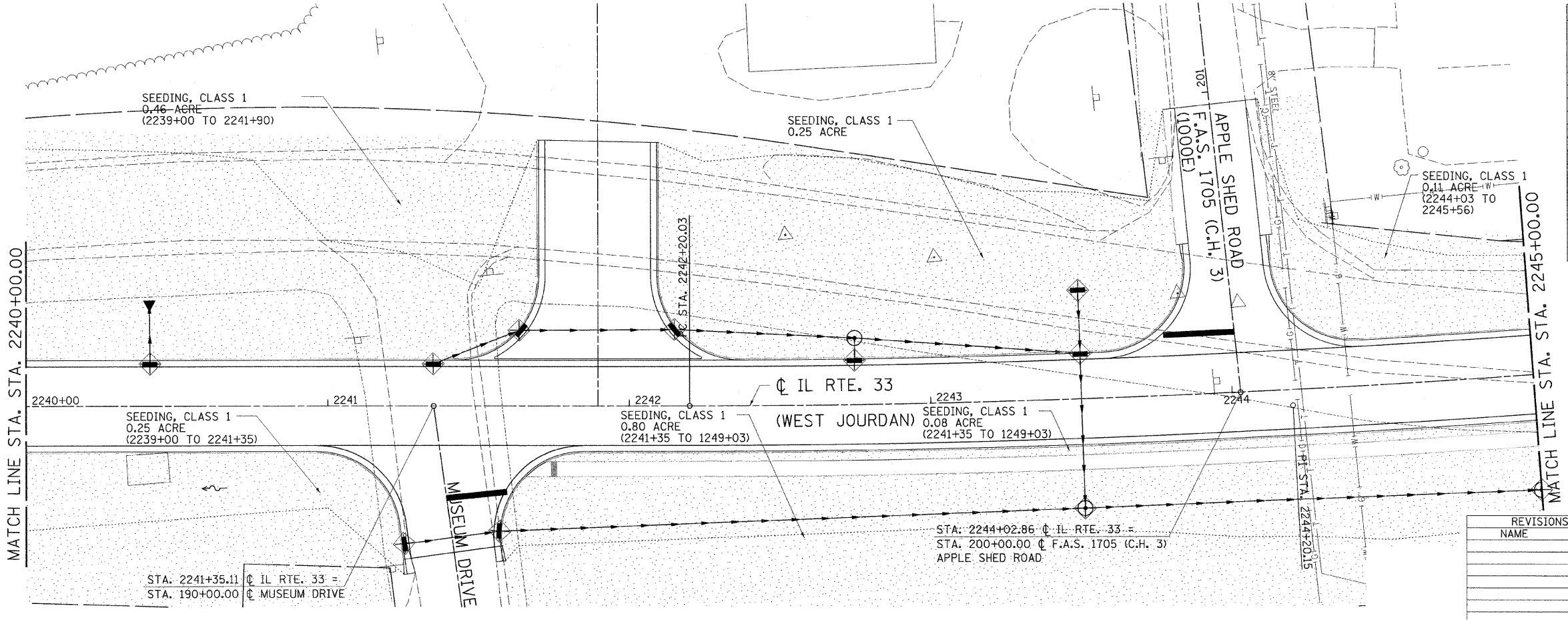
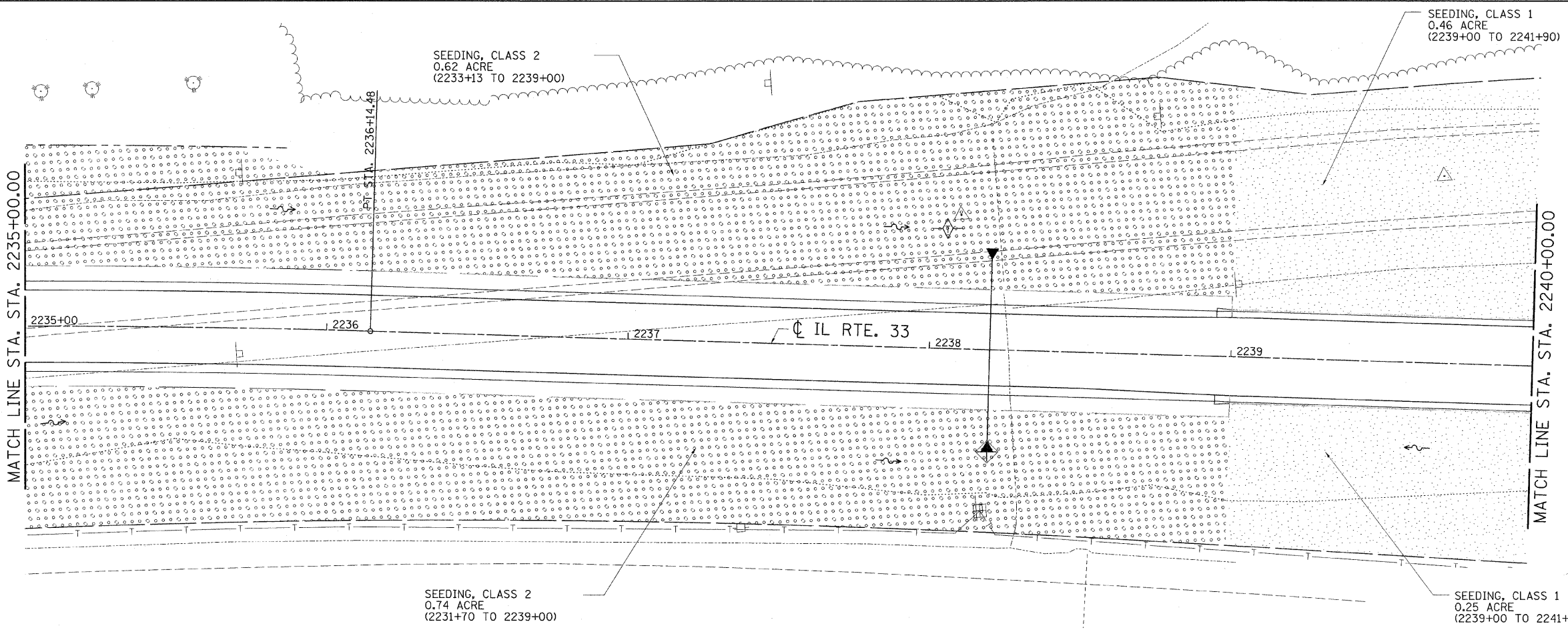

EROSION CONTROL		
LOCATION	TEMPORARY DITCH CHECKS FOOT	INLET AND PIPE PROTECTION EACH
STA. 2238+00, LT	10	1
STA. 2238+20, RT.		1
STA. 2240+41, 14' LT		1
STA. 2241+25.35, 45.94' RT.		1
STA. 2241+35, 14' LT.		1
STA. 2241+57, 41.68' RT.		1
STA. 2241+63.54, 25' LT.		1
STA. 2242+15.53, 25.21' LT.		1
STA. 2242+73, 14' LT.		1
STA. 2243+50, 14' LT.		1
STA. 2243+50, LT.		1
STA. 2243+50, RT.		1
STA. 2245+00, RT.		1
TOTALS	10	12

ILLINOIS DEPARTMENT OF TRANSPORTATION
EROSION AND SEDIMENT CONTROL PLANS
 FAP ROUTE 95 (IL RTE. 33)
 SECTION (5,6)Y,RS-2,6BR-7
 JASPER COUNTY

SCALE: VERT. _____
 HORIZ. _____
 DATE: 09/16/02

DRAWN BY: BISHOP
 DESIGNED BY: COLBROOK
 CHECKED BY: COLBROOK

COMPUTER FILE NO. EC-24 - 20
 PROJECT 01256
 2/26/10-FAV

GREENE & BRADFORD, INC.
 OF SPRINGFIELD
 REGISTERED PROFESSIONAL ENGINEERS
 PROFESSIONAL SEAL NO. 061722
 PROFESSIONAL SEAL NO. 061722
 PROFESSIONAL SEAL NO. 061722
 PROFESSIONAL SEAL NO. 061722

REVISIONS	
NAME	DATE