

DESIGN		
INT.	DATE	REASON

PLOTS & CHECKS			
INT.	DATE	NO.	REASON

CHECKS		
INT.	DATE	REASON

F.A.P. RTE.	SECTION	COUNTY	TOTAL SHEETS	SHEET NO.
95	*	JASPER	546	168
STA. 1265+00.00		TO STA. 1275+00.00		
FED. ROAD DIST. NO.		ILLINOIS	FED. AID PROJECT	
(5,6)Y,RS-2,6BR-7		CONTRACT NO. 94437		

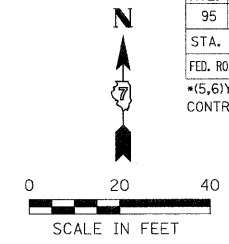

LEGEND

- INLET AND PIPE PROTECTION
- TEMPORARY DITCH CHECK
- PERIMETER EROSION BARRIER
- SEEDING, CLASS 1
- SEEDING, CLASS 2

EROSION CONTROL		
LOCATION	PERIMETER EROSION BARRIER FOOT	INLET AND PIPE PROTECTION EACH
STA. 1266+25, 14' LT.		1
STA. 1266+25, LT.		1
STA. 1266+25, RT.		1
STA. 1266+25, 14' RT.		1
STA. 1267+00, LT.		1
STA. 1268+50, 14' LT.		1
STA. 1268+50, RT.		1
STA. 1268+50, 14' RT.		1
STA. 1269+75, 14' LT.		1
STA. 1269+75, RT.		1
STA. 1269+75, 14' RT.		1
STA. 1270+50, LT.		1
STA. 1270+50, RT.		1
STA. 1270+55, 14' LT.		1
STA. 1270+55, 14' RT.		1
STA. 1270+84, 26' RT.		1
STA. 1270+84.07, 27.11' LT.		1
STA. 1270+87, 78' LT.		1
STA. 1271+23.02, 25.95' RT.		1
STA. 1271+26.69, 25.82' LT.		1
STA. 1271+43, 14' LT.		1
STA. 1271+43, 14' RT.		1
STA. 1272+00, TO STA. 1273+70, LT.	170	
STA. 1272+00, 14' RT.		1
STA. 1272+25, 14' LT.		1
STA. 1272+75, RT.		1
STA. 1272+75, 14' RT.		1
STA. 1273+00, 14' LT.		1
STA. 1274+55, 14' LT.		1
STA. 1274+55, RT.		1
STA. 1274+55, 14' RT.		1
TOTALS	170	30

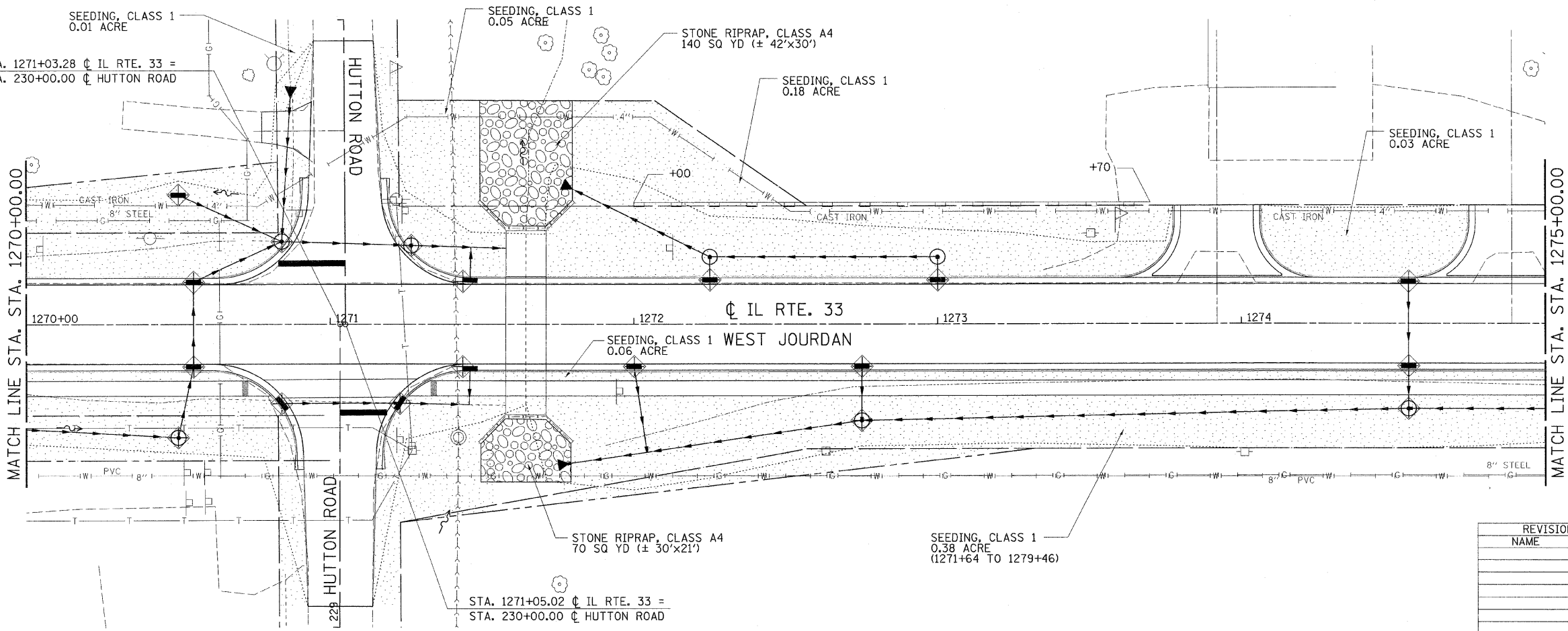
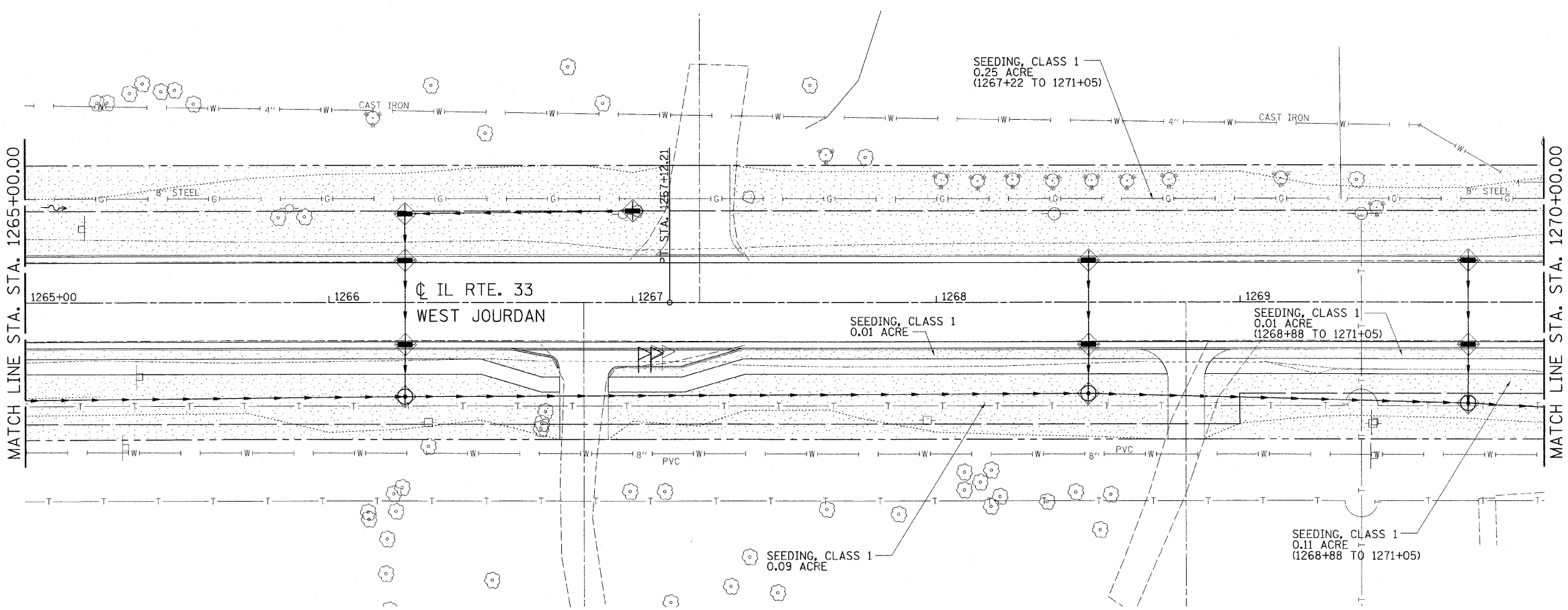

REVISIONS	
NAME	DATE

ILLINOIS DEPARTMENT OF TRANSPORTATION
EROSION AND SEDIMENT CONTROL PLANS
 FAP ROUTE 95 (IL RTE. 33)
 SECTION (5,6)Y,RS-2,6BR-7
 JASPER COUNTY

SCALE: VERT. _____
 HORIZ. _____
 DATE: 09/16/02

DRAWN BY: BISHOP
 DESIGNED BY: COLBROOK
 CHECKED BY: COLBROOK

COMPUTER FILE NO.
 EC-27 - 20
 PROJECT 01256
 9/20/10-MDS

GREENE & BRADFORD, INC.
 OF SPRINGFIELD
 CONSULTING ENGINEERS
 1800 W. STATE ST., SUITE 200
 SPRINGFIELD, ILL. 62702
 PROFESSIONAL ENGINEERS
 LICENSE NO. 021-0000001
 REGISTERED PROFESSIONAL ENGINEERS
 LICENSE NO. 021-0000001