

DESIGN		
INT.	DATE	REASON

PLOTS & CHECKS		
INT.	DATE	REASON

CHECKS		
INT.	DATE	REASON

F.A.P. RTE.	SECTION	COUNTY	TOTAL SHEETS	SHEET NO.
95		JASPER	546	169

STA. 1275+00.00 TO STA. 1286+00.00
 FED. ROAD DIST. NO. ILLINOIS FED. AID PROJECT
 (5,6)Y,RS-2,6BR-7
 CONTRACT NO. 94437

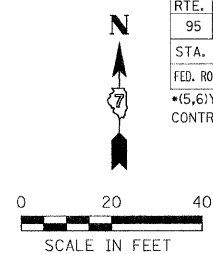

- LEGEND**
- INLET AND PIPE PROTECTION
 - TEMPORARY DITCH CHECK
 - PERIMETER EROSION BARRIER
 - SEEDING, CLASS 1
 - SEEDING, CLASS 2

EROSION CONTROL		
LOCATION	PERIMETER EROSION BARRIER FOOT	INLET AND PIPE PROTECTION EACH
STA. 1275+10, TO STA. 1275+85, LT.	75	
STA. 1276+63, RT.		1
STA. 1276+65, 14' LT.		1
STA. 1276+65, 14' RT.		1
STA. 1278+00, 14' LT.		1
STA. 1278+00, RT.		1
STA. 1278+00, 14' RT.		1
STA. 1280+35, 14' LT.		1
STA. 1280+35, LT.		1
STA. 1280+35, RT.		1
STA. 1280+35, 14' RT.		1
STA. 1282+85, 14' LT.		1
STA. 1282+85, LT.		1
STA. 1282+85, RT.		1
STA. 1282+85, 14' RT.		1
STA. 1285+49.73, 23.43' RT.		1
TOTALS	75	15

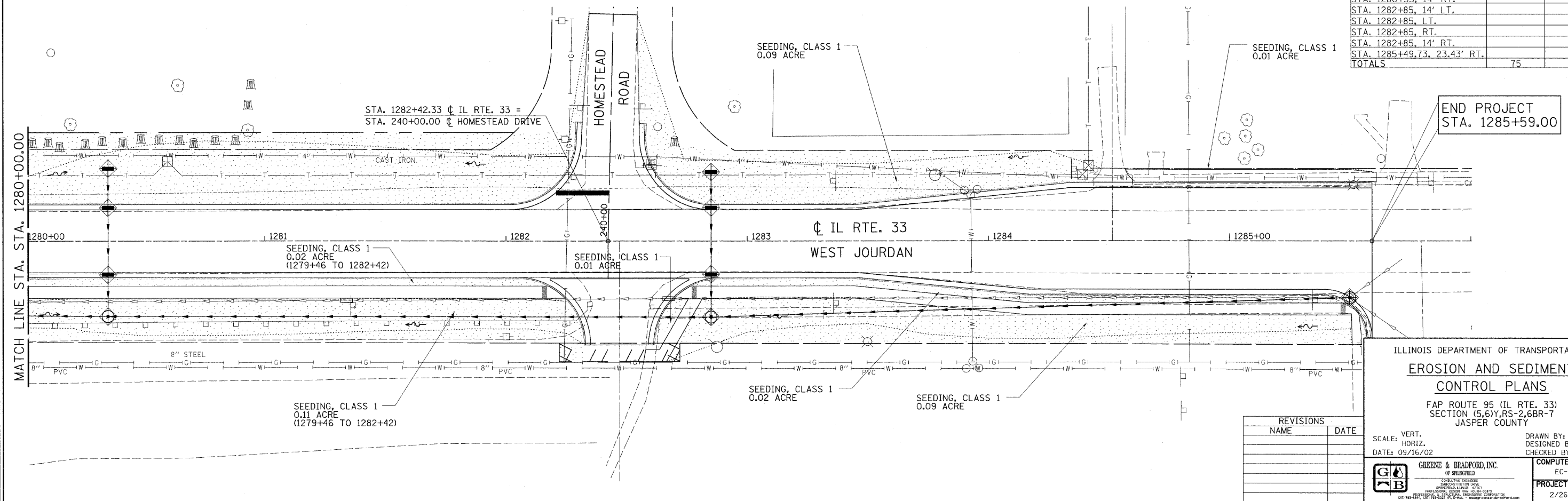
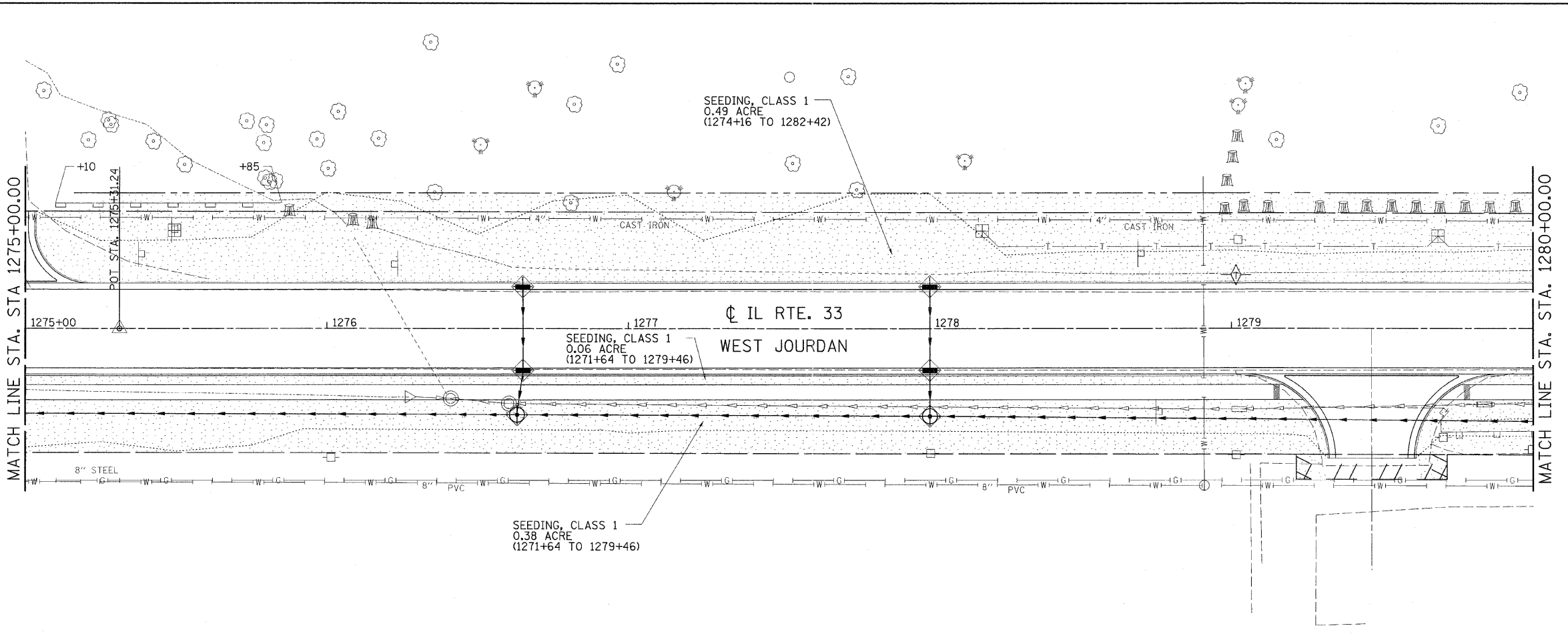

ILLINOIS DEPARTMENT OF TRANSPORTATION
EROSION AND SEDIMENT CONTROL PLANS
 FAP ROUTE 95 (IL RTE. 33)
 SECTION (5,6)Y,RS-2,6BR-7
 JASPER COUNTY

SCALE:	VERT. HORIZ.	DATE:	DESIGNED BY:	CHECKED BY:	COMPUTER FILE NO.
		09/16/02	BISHOP	COLBROOK	EC-28 - 20
					PROJECT 01256
					2/26/10-FAV

REVISIONS	
NAME	DATE

