

INT.	DATE	REASON

DATE	BY	REVISION

INT.	DATE	REASON

DATE	BY	REVISION

INT.	DATE	REASON

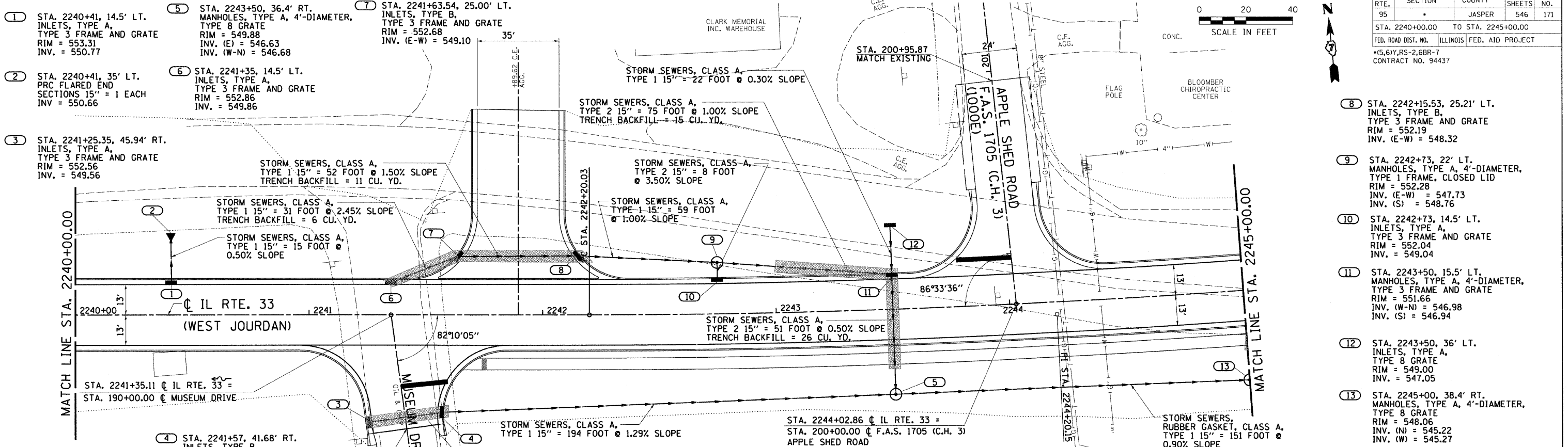

B.M. #25 : STA. 2240+66, 71' RT. NAIL "30 D" IN PP ELEV. 540.07

STA. 2241+57, 41.68' RT. INLETS, TYPE B, TYPE 3 FRAME AND GRATE RIM = 552.39 INV. (W-E) = 549.18

B.M. #26 : STA. 2244+08, 82' RT. SURVEY MONUMENT ELEV. 582.77

REVISION	DATE	BY

GREENE & BRADFORD, INC. OF SPRINGFIELD
 PROFESSIONAL ENGINEERS
 PROJECT: 01256
 2/26/10-FAV

