

DESIGN	INT.	DATE	REASON

PLAN	DATE	BY

PLOTS & CHECKS	INT.	DATE	REASON

PROFILE	DATE	BY

CHECKS	INT.	DATE	REASON

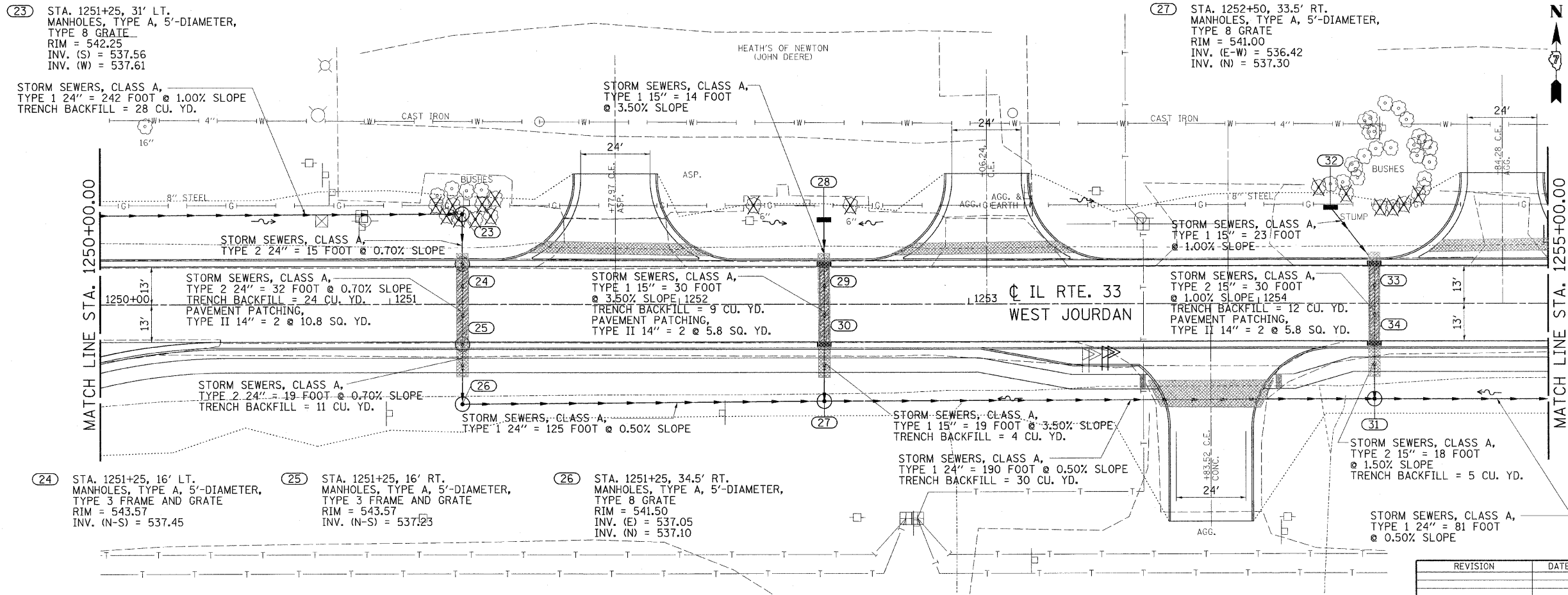

F.A.P. RTE.	SECTION	COUNTY	TOTAL SHEETS	SHEET NO.
95	*	JASPER	546	173

STA. 1250+00.00 TO STA. 1255+00.00  
 FED. ROAD DIST. NO. ILLINOIS FED. AID PROJECT  
 \*15.6YRS-2.6BR-7  
 CONTRACT NO. 94437

- (28) STA. 1252+50, 29' LT. INLETS, TYPE A, TYPE 8 GRATE  
RIM = 541.75  
INV. = 539.50
- (29) STA. 1252+50, 15' LT. INLETS, TYPE B, TYPE 3 FRAME AND GRATE  
RIM = 542.66  
INV. (N-S) = 539.01
- (30) STA. 1252+50, 15' RT. INLETS, TYPE B, TYPE 3 FRAME AND GRATE  
RIM = 542.66  
INV. (N-S) = 537.96
- (31) STA. 1254+40, 33' RT. MANHOLES, TYPE A, 5'-DIAMETER, TYPE 8 GRATE  
RIM = 540.00  
INV. (E-W) = 535.47  
INV. (N) = 536.20
- (32) STA. 1254+25, 33' LT. INLETS, TYPE A, TYPE 8 GRATE  
RIM = 540.00  
INV. = 537.00
- (33) STA. 1254+40, 15' LT. INLETS, TYPE B, TYPE 3 FRAME AND GRATE  
RIM = 541.79  
INV. (N-S) = 536.77
- (34) STA. 1254+40, 15' RT. INLETS, TYPE B, TYPE 3 FRAME AND GRATE  
RIM = 541.79  
INV. (N-S) = 536.47

REVISION	DATE	BY

**GREENE & BRADFORD, INC.**  
 CONSULTING ENGINEERS  
 1000 N. W. 10th St., Palm Bay, FL 32909  
 (321) 329-1111

COMPUTER FILE NO. DRAINAGE19-2.DGN  
 PROJECT: 01256  
 3/19/10-MDS

