

DESIGN	INT.	DATE	REASON

PLAN	DATE

PLOTS & CHECKS	INT.	DATE	NO.	REASON

PROFILE	DATE

CHECKS	INT.	DATE	REASON

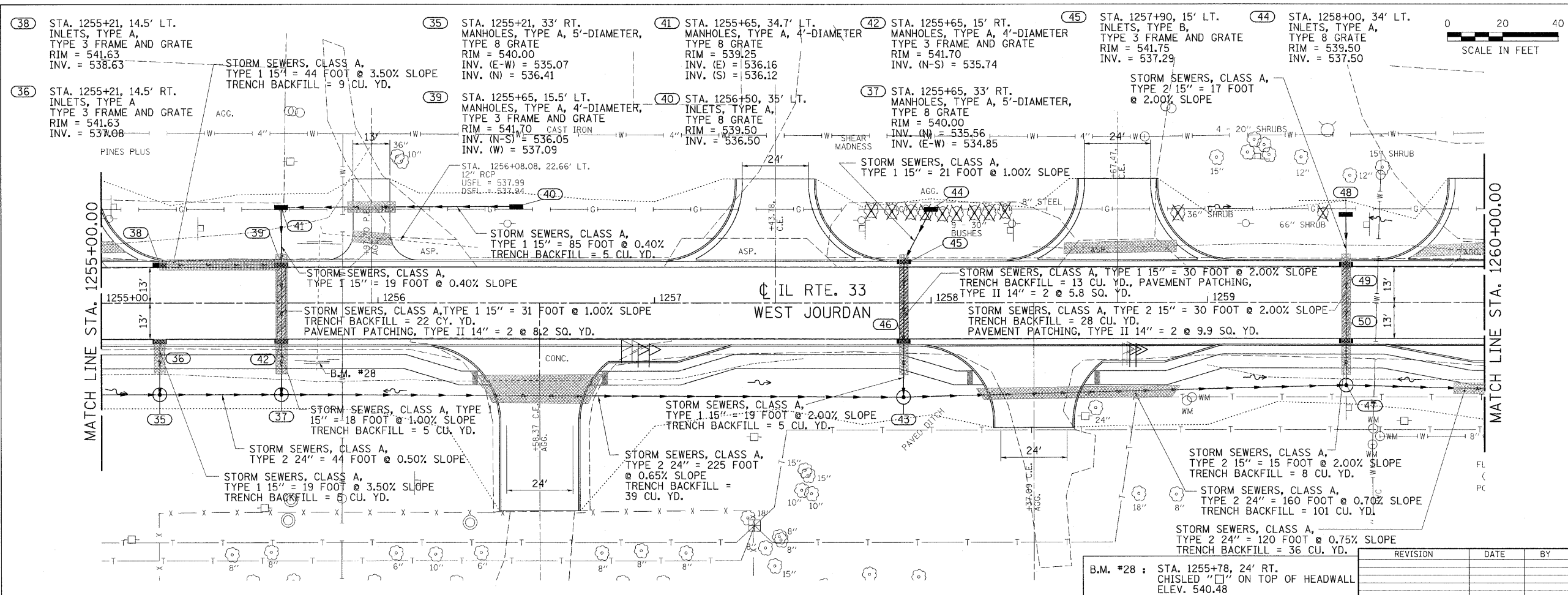

F.A.P. RTE.	SECTION	COUNTY	TOTAL SHEETS	SHEET NO.
95		JASPER	546	174

STA. 1255+00.00 TO STA. 1260+00.00  
 FED. ROAD DIST. NO. ILLINOIS FED. AID PROJECT  
 \*15.61Y.R5-2.63R-7  
 CONTRACT NO. 94437

- 38 STA. 1255+21, 14.5' LT. INLETS, TYPE A, TYPE 3 FRAME AND GRATE RIM = 541.63 INV. = 538.63
- 36 STA. 1255+21, 14.5' RT. INLETS, TYPE A, TYPE 3 FRAME AND GRATE RIM = 541.63 INV. = 537.08
- 35 STA. 1255+21, 33' RT. MANHOLES, TYPE A, 5'-DIAMETER, TYPE 8 GRATE RIM = 540.00 INV. (N) = 535.07 INV. (E-W) = 536.41
- 39 STA. 1255+65, 15.5' LT. MANHOLES, TYPE A, 4'-DIAMETER, TYPE 3 FRAME AND GRATE RIM = 541.70 INV. (N-S) = 536.05 INV. (W) = 537.09
- 41 STA. 1255+65, 34.7' LT. MANHOLES, TYPE A, 4'-DIAMETER, TYPE 8 GRATE RIM = 539.25 INV. (E-W) = 535.16 INV. (S) = 536.12
- 42 STA. 1255+65, 15' RT. MANHOLES, TYPE A, 4'-DIAMETER, TYPE 3 FRAME AND GRATE RIM = 541.70 INV. (N-S) = 535.74
- 45 STA. 1257+90, 15' LT. INLETS, TYPE B, TYPE 3 FRAME AND GRATE RIM = 541.75 INV. = 537.29
- 44 STA. 1258+00, 34' LT. INLETS, TYPE A, TYPE 8 GRATE RIM = 539.50 INV. = 537.50
- 46 STA. 1257+90, 15' RT. INLETS, TYPE B, TYPE 3 FRAME AND GRATE RIM = 541.75 INV. (N-S) = 536.69
- 43 STA. 1257+90, 34' RT. MANHOLES, TYPE A, 5'-DIAMETER, TYPE 8 GRATE RIM = 540.00 INV. (E-W) = 533.38 INV. (N) = 536.31
- 48 STA. 1259+50, 32' LT. INLETS, TYPE A, TYPE 8 GRATE RIM = 539.50 INV. = 536.50
- 49 STA. 1259+50, 15' LT. INLETS, TYPE B, TYPE 3 FRAME AND GRATE RIM = 541.10 INV. (N-S) = 536.16
- 50 STA. 1259+50, 15' RT. INLETS, TYPE B, TYPE 3 FRAME AND GRATE RIM = 541.10 INV. (N-S) = 535.56
- 47 STA. 1259+50, 29.75' RT. MANHOLES, TYPE A, 5'-DIAMETER, TYPE 8 GRATE RIM = 540.10 INV. (E-W) = 532.26 INV. (N) = 535.26

B.M. #28 : STA. 1255+78, 24' RT. CHISLED "I" ON TOP OF HEADWALL ELEV. 540.48

REVISION	DATE	BY

GREENE & BRADFORD, INC. OF SPRINGFIELD  
 CONSULTING ENGINEERS  
 PROFESSIONAL ENGINEERS LICENSE NO. 12123  
 PROFESSIONAL SURVEYORS LICENSE NO. 12123  
 600 N. FIRST ST., SPRINGFIELD, ILL. 62761-1000  
 COMPUTER FILE NO. DRAINAGE19-3.DGN  
 PROJECT: 01256  
 3/19/10-MDS

