

DESIGN		REASON	
INT.	DATE		

PLAN	SURVEYED	DATE

PLOTS & CHECKS		REASON	
INT.	DATE		

PROFILE		REASON	
INT.	DATE		

CHECKS		REASON	
INT.	DATE		

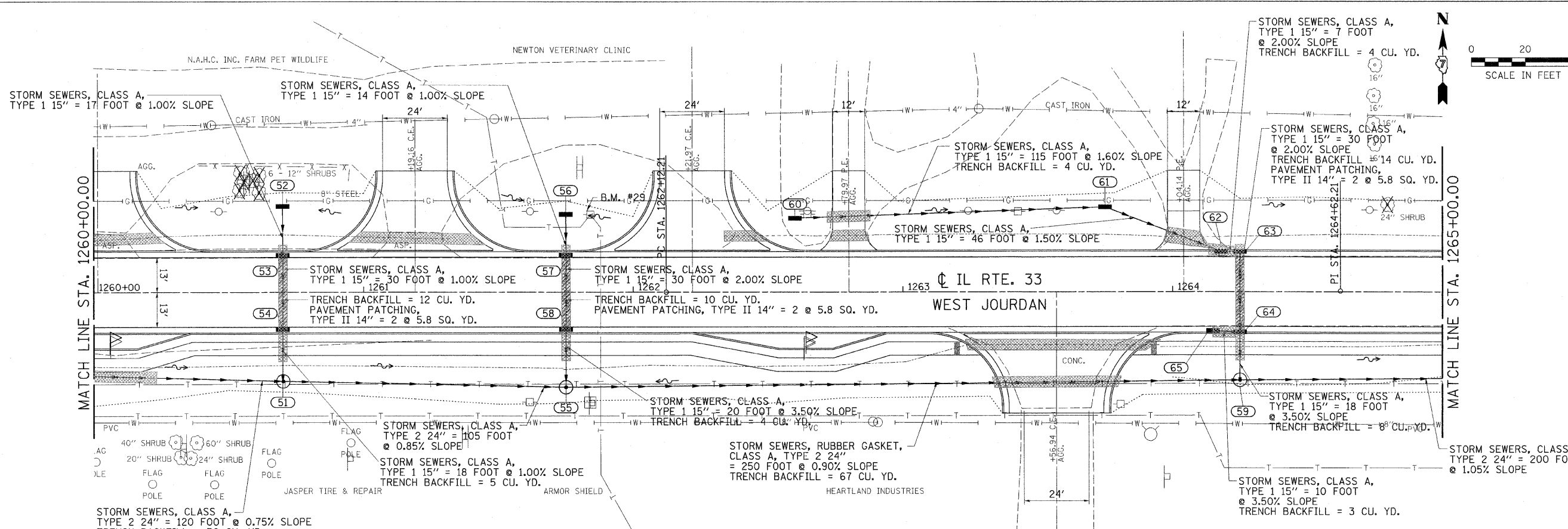

F.A.P. RTE.	SECTION	COUNTY	TOTAL SHEETS	SHEET NO.
95		JASPER	546	175

STA. 1260+00.00 TO STA. 1265+00.00

FED. ROAD DIST. NO. ILLINOIS FED. AID PROJECT

CONTRACT NO. 94437

- (51) STA. 1260+70, 33' RT. MANHOLES, TYPE A, 5'-DIAMETER, TYPE 8 GRATE
RIM = 539.00
INV. (E-W) = 531.36
INV. (N) = 535.35
- (52) STA. 1260+70, 32' LT. INLETS, TYPE B, TYPE 3 FRAME AND GRATE
RIM = 539.00
INV. = 536.00
- (53) STA. 1260+70, 15' LT. INLETS, TYPE B, TYPE 3 FRAME AND GRATE
RIM = 540.63
INV. (N-S) = 535.83
- (54) STA. 1260+70, 15' RT. INLETS, TYPE B, TYPE 3 FRAME AND GRATE
RIM = 540.63
INV. (N-S) = 535.53
- (55) STA. 1261+75, 35.25' RT. MANHOLES, TYPE A, 5'-DIAMETER, TYPE 8 GRATE
RIM = 538.00
INV. (E-W) = 530.47
INV. (N) = 534.81
- (56) STA. 1261+75, 29.3' LT. INLETS, TYPE A, TYPE 8 GRATE
RIM = 539.25
INV. = 536.25
- (57) STA. 1261+75, 15' LT. INLETS, TYPE B, TYPE 3 FRAME AND GRATE
RIM = 540.21
INV. (N-S) = 536.11
- (58) STA. 1263+75, 15' RT. INLETS, TYPE B, TYPE 3 FRAME AND GRATE
RIM = 540.21
INV. (N-S) = 535.81
- (59) STA. 1264+25, 32.75' RT. MANHOLES, TYPE A, 5'-DIAMETER, TYPE 8 GRATE
RIM = 536.50
INV. (E-W) = 528.22
INV. (N) = 531.86
- (60) STA. 1262+60, 27.5' LT. INLETS, TYPE A, TYPE 8 GRATE
RIM = 538.90
INV. = 535.90
- (61) STA. 1263+75, 31.6' LT. INLETS, TYPE B, TYPE 3 FRAME AND GRATE
RIM = 537.25
INV. (W) = 534.06
INV. (S) = 534.02
- (62) STA. 1264+18, 15' LT. INLETS, TYPE B, TYPE 3 FRAME AND GRATE
RIM = 538.19
INV. (NW) = 533.35
INV. (E) = 533.31
- (63) STA. 1264+25, 15' LT. MANHOLES, TYPE A, 4'-DIAMETER, TYPE 3 FRAME AND GRATE
RIM = 538.09
INV. (W) = 533.17
INV. (S) = 533.13
- (64) STA. 1264+25, 15' RT. MANHOLES, TYPE A, 4' DIAMETER, TYPE 3 FRAME AND GRATE
RIM = 538.09
INV. (N) = 532.53
INV. (S) = 532.49
INV. (W) = 533.88
- (65) STA. 1264+15, 14.5' RT. INLETS, TYPE A, TYPE 3 FRAME AND GRATE
RIM = 538.23
INV. = 534.23

B.M. *29 : STA. 1261+84, 29' LT. TWO "16 D" NAILS IN SO. SIDE PP ELEV. 540.07

REVISION	DATE	BY

GREENE & BRADFORD, INC. OF SPRINGFIELD

COMPUTER FILE NO. DRAINAGE20-LDGN

PROJECT: 01256

2/26/10-FAV

