

DESIGN		
INT.	DATE	REASON

PLAN	REVISIONS	DATE

PLOTS & CHECKS		
INT.	DATE	REASON

PROFILE	REVISIONS	DATE

CHECKS		
INT.	DATE	REASON

F.A.P. RTE.	SECTION	COUNTY	TOTAL SHEETS	SHEET NO.
95	•	JASPER	546	220
STA. _____ TO STA. _____				
FED. ROAD DIST. NO. _____ ILLINOIS FED. AID PROJECT				
*15.61Y,RS-2,6BR-7				
CONTRACT NO. 94437				

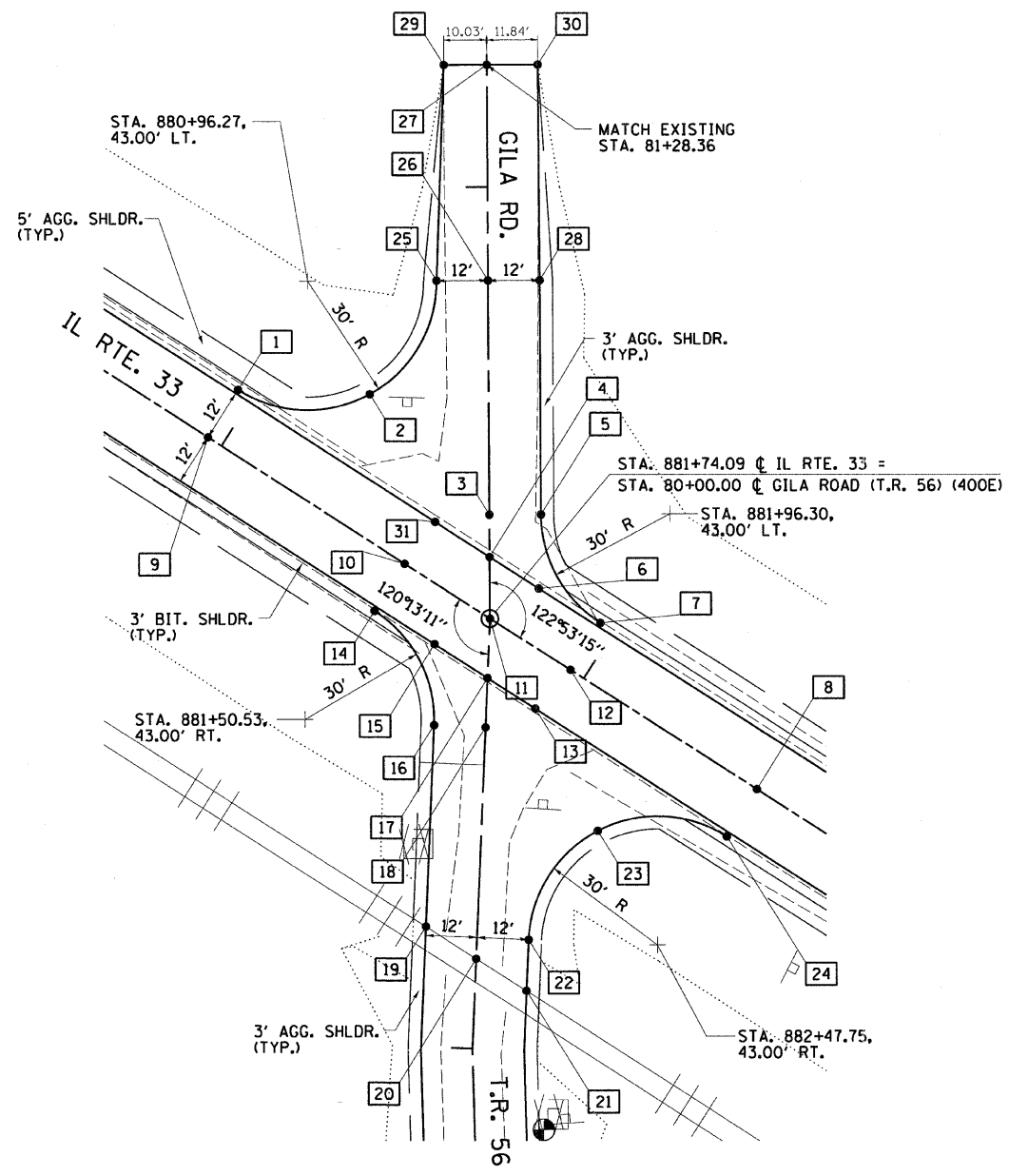
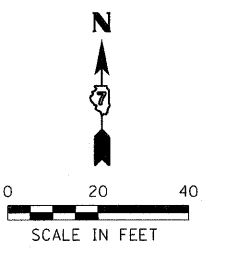

T.R. 56 (400E) / GILA ROAD

T.R. 56 (400E) / GILA ROAD					
BOX NUMBER	STATIONING ALONG IL. RTE. 33	OFFSET FEET	STATIONING ALONG T.R. 56	OFFSET FEET	ELEVATION FEET
1	880+96.27	13.00 LT	80+53.17	58.29 LT	576.05
2	881+22.62	28.66 LT	80+52.01	27.66 LT	575.75
3	881+61.01	20.23 LT	80+24.09	0.00 RT	576.05
4	881+66.33	12.00 LT	80+14.29	0.00 RT	576.04
5	881+71.09	26.74 LT	80+24.09	12.00 RT	575.81
6	881+79.91	12.00 LT	80+06.92	11.40 RT	576.04
7	881+96.30	13.00 LT	80+00.00	25.70 RT	575.96
8	882+47.75	0.00 RT	79+62.93	63.64 RT	576.15
9	880+96.27	0.00 RT	80+42.26	65.35 LT	576.24
10	881+50.53	0.00 RT	80+12.79	19.78 LT	576.20
11	881+74.09	0.00 RT	80+00.00	0.00 RT	576.22
12	881+96.30	0.00 RT	79+88.82	19.19 RT	576.15
13	881+94.26	12.00 RT	79+79.48	11.38 RT	575.98
14	881+50.53	13.00 RT	80+01.88	26.84 LT	576.01
15	881+66.43	12.00 RT	79+93.49	12.66 LT	576.04
16	881+76.46	27.90 RT	79+74.70	12.00 LT	575.67
17	881+81.08	12.00 RT	79+86.11	0.00 RT	576.02
18	881+86.82	21.86 RT	79+74.70	0.00 LT	575.91
19	882+00.05	68.40 RT	79+27.83	12.00 LT	577.42
20	882+13.93	68.39 RT	79+20.85	0.00 RT	577.42
21	882+27.81	68.38 RT	79+13.87	12.00 RT	577.42
22	882+21.82	58.10 RT	79+25.77	12.00 RT	576.92
23	882+21.74	28.05 RT	79+51.78	27.05 RT	576.00
24	882+47.75	13.00 RT	79+51.70	57.10 RT	575.96
25	881+21.47	59.29 LT	80+78.36	12.00 LT	575.87
26	881+31.54	65.81 LT	80+78.36	0.00 RT	576.11
27	881+04.39	107.79 LT	81+28.36	0.00 RT	576.16
28	881+41.62	72.32 LT	80+78.36	12.00 RT	575.87
29	880+95.97	102.35 LT	81+28.36	10.03 LT	575.81
30	881+14.34	114.22 LT	81+28.36	11.84 RT	575.85
31	881+51.29	12.00 LT	80+22.46	12.63 LT	576.02

ILLINOIS DEPARTMENT OF TRANSPORTATION
INTERSECTION DETAILS
 FAP ROUTE 95 (IL RTE. 33)
 SECTION (5,6)Y,RS-2,6BR-7
 JASPER COUNTY

SCALE: VERT. _____
 HORIZ. _____
 DATE: 08/21/02

DRAWN BY: JAMESON
 DESIGNED BY: COLBROOK
 CHECKED BY: COLBROOK

COMPUTER FILE NO.
 INT-02-A
 PROJECT 01256
 2/26/10-FAV

GREENE & BRADFORD, INC.
 OF SPRINGFIELD
 REGISTERED PROFESSIONAL ENGINEERS
 PROFESSIONAL ENGINEERS IN ILLINOIS
 PROFESSIONAL ENGINEERS IN MISSOURI
 PROFESSIONAL ENGINEERS IN INDIANA
 PROFESSIONAL ENGINEERS IN KENTUCKY
 PROFESSIONAL ENGINEERS IN TENNESSEE
 PROFESSIONAL ENGINEERS IN VIRGINIA
 PROFESSIONAL ENGINEERS IN WEST VIRGINIA
 PROFESSIONAL ENGINEERS IN ARIZONA
 PROFESSIONAL ENGINEERS IN CALIFORNIA
 PROFESSIONAL ENGINEERS IN NEVADA
 PROFESSIONAL ENGINEERS IN NEW MEXICO
 PROFESSIONAL ENGINEERS IN UTAH
 PROFESSIONAL ENGINEERS IN WYOMING

REVISIONS	
NAME	DATE