

DESIGN		
INT.	DATE	REASON

PLAN	NO.	DATE
DESIGNED		
CHECKED		
PLOTTED		
ALIGNED		
CAD FILE NAME		

P.LOTS & CHECKS		
INT.	DATE	REASON

PROFILE	NO.	DATE
DESIGNED		
CHECKED		
PLOTTED		
GRADES CHECKED		
STRUCTURE NOTATIONS CHECKED		

CHECKS		
INT.	DATE	REASON

F.A.P. RTE.	SECTION	COUNTY	TOTAL SHEETS	SHEET NO.
95	•	JASPER	546	231
STA. TO STA.				
FED. ROAD DIST. NO. ILLINOIS FED. AID PROJECT				
*5.61Y,RS-2,6BR-7				
CONTRACT NO. 94437				

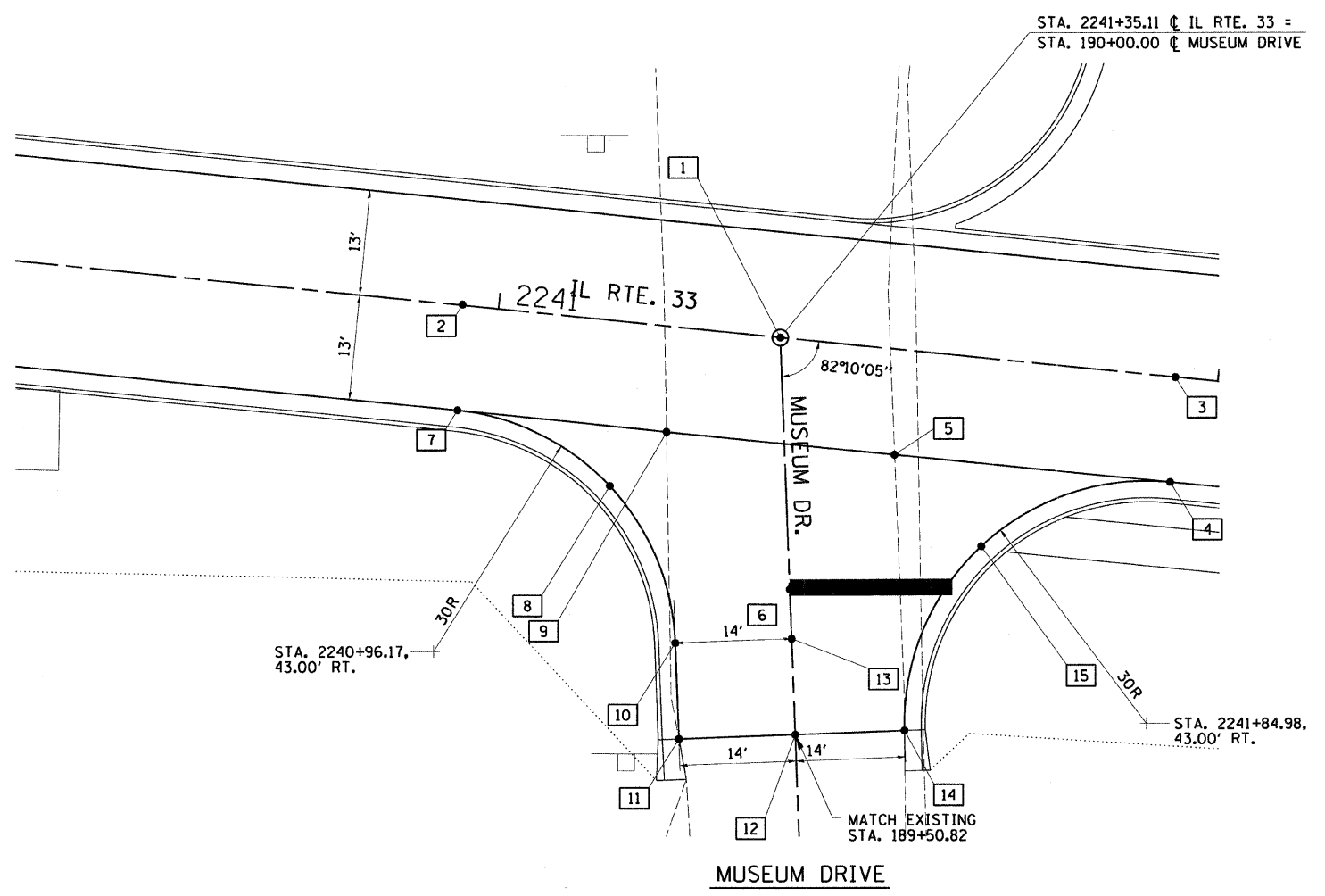
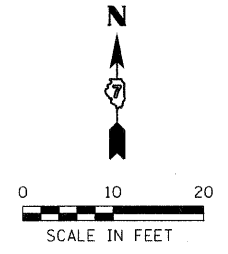

MUSEUM DRIVE					
BOX NUMBER	STATIONING ALONG IL. RTE. 33	OFFSET FEET	STATIONING ALONG MUSEUM DRIVE	OFFSET FEET	ELEVATION FEET
1	2241+35.11	0.00 RT	190+00.00	0.00 LT	553.06
2	2240+96.17	0.00 RT	N/A	N/A	553.24
3	2241+84.98	0.00 RT	189+93.21	49.40 RT	552.82
4	2241+84.98	13.00 RT	189+80.33	47.63 RT	552.63
5	2241+50.64	13.00 RT	189+85.01	13.62 RT	552.80
6	2241+36.90	13.00 RT	189+86.88	0.00 LT	552.86
7	2240+96.17	13.00 RT	189+92.43	40.35 LT	553.08
8	2241+5.89	20.39 RT	189+82.42	21.82 LT	552.82
9	2241+22.33	13.00 RT	189+88.86	14.43 LT	552.93
10	2241+25.89	38.91 RT	189+62.71	14.43 LT	552.61
11	2241+27.51	50.69 RT	189+50.82	14.43 LT	552.52
12	2241+41.81	48.72 RT	189+50.82	0.00 LT	552.72
13	2241+40.19	36.94 RT	189+62.71	0.00 LT	552.80
14	2241+55.23	46.88 RT	189+50.82	13.55 RT	552.41
15	2241+62.44	23.21 RT	189+73.29	23.91 RT	552.52

ILLINOIS DEPARTMENT OF TRANSPORTATION
INTERSECTION DETAILS
 FAP ROUTE 95 (IL RTE. 33)
 SECTION (5,6)Y,RS-2,6BR-7
 JASPER COUNTY

SCALE: VERT. _____
 HORIZ. _____
 DATE: 08/21/02

DRAWN BY: JAMESON
 DESIGNED BY: COLBROOK
 CHECKED BY: COLBROOK

COMPUTER FILE NO.
 INT-07-C
 PROJECT 01256
 2/26/10-FAV

GREENE & BRADFORD, INC.
 OF SPANFORD
 REGISTERED PROFESSIONAL ENGINEERS
 LICENSE NO. 001111

REVISIONS	
NAME	DATE