

STATE OF ILLINOIS
DEPARTMENT OF TRANSPORTATION

ROUTE NO.	SECTION	COUNTY	SHEET NO.	SHEET
FAP 95	6RS-2	JASPER	546	262
FED. ROAD DIST. NO.		ILLINOIS	FED. AID PROJECT	

SHEET NO. 4
5 SHEETS
Contract No. 94437

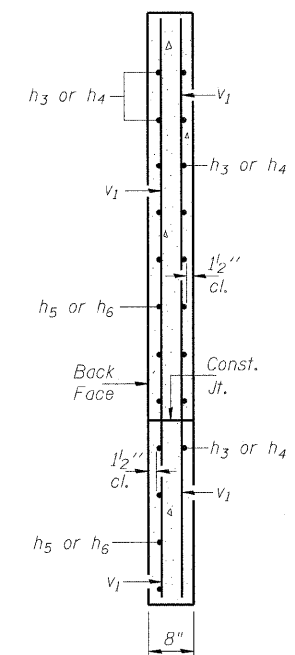
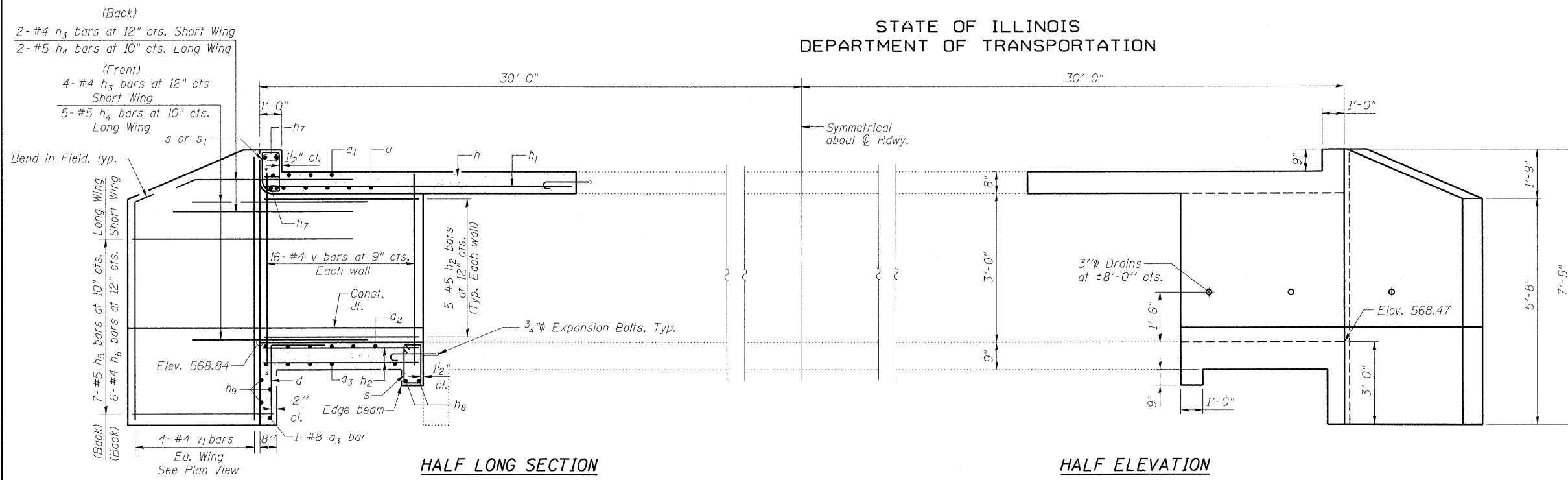

HALF LONG SECTION

HALF ELEVATION

SECTION A-A

Dimensions are at right angles to ϕ Roadway

Dimensions are at right angles to ϕ Roadway

BILL OF MATERIAL

Bar	No.	Size	Length	Shape
a	84	#6	18'-6"	U
a1	104	#6	17'-3"	U
a2	26	#8	22'-10"	U
a3	34	#8	21'-0"	U
d	36	#4	4'-6"	L
h	18	#4	38'-3"	—
h1	23	#5	38'-3"	—
h2	52	#5	11'-3"	—
h3	12	#4	8'-0"	—
h4	14	#5	8'-0"	—
h5	14	#5	11'-3"	—
h6	12	#4	7'-3"	—
h7	8	#6	20'-11"	—
h8	4	#6	19'-10"	—
h9	6	#5	20'-3"	—
s	61	#4	4'-7"	□
s1	21	#4	4'-5"	□
v	100	#4	4'-0"	—
v1	16	#4	7'-2"	—
Concrete Box Culverts			Cu. Yd.	40.8
Reinforcement Bars			Pound	12,110

Bars indicated thus 12x4 - #5 etc. indicates 12 lines of bars with 4 lengths per line.

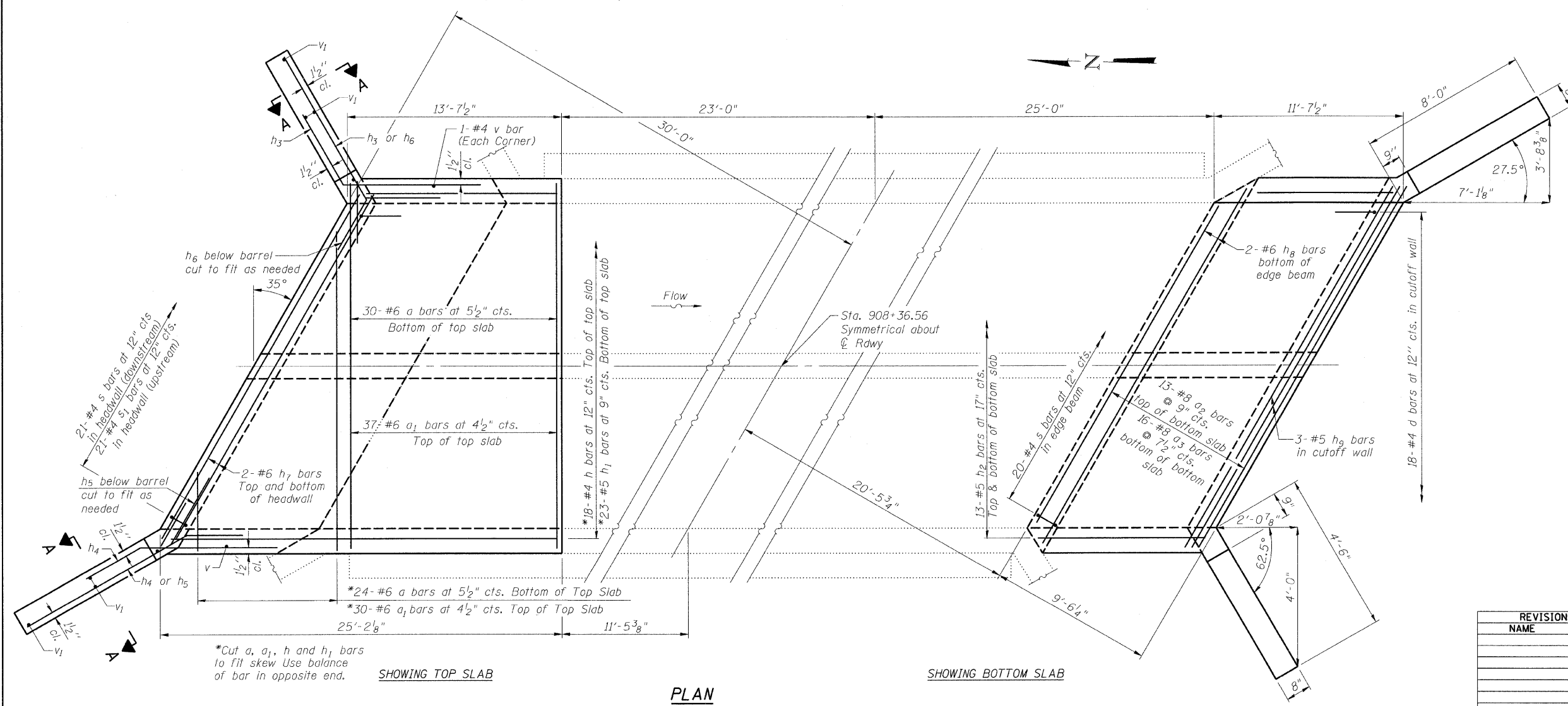

SHOWING TOP SLAB

SHOWING BOTTOM SLAB

PLAN

REVISIONS	
NAME	DATE

ILLINOIS DEPARTMENT OF TRANSPORTATION
CULVERT DETAILS
IL RTE 33 OVER BRANCH LAWS CREEK
FAP RTE 95 - SECTION 6RS-2
JASPER COUNTY
STATION 908+36.56
SN 040-2003

SCALE: VERT. _____
HORIZ. _____
DATE: 1/25/05

DRAWN BY: LANDREY
DESIGNED BY: SANFORD
CHECKED BY: WATKINS

GREENE & BRADFORD, INC.
OF SPRINGFIELD

COMPUTER FILE NO.
SNO40-2003.DET
PROJECT 01256
2/26/10-FAV

FILE NAME = I:\0256\DRAWINGS\SNO40-2003\SNO40-2003.DET.dgn
PLOT DATE = 3/17/2010
PLOT TIME = 5:25:24 PM
OPERATOR = Franky