

Bench Mark: B.M. #10. Sta. 908+19, 102' Rt. Survey Monument elevation 577.16

Existing Structure: Built in 1925 as S.B.I. Route 33, section 6. Extended in 1990 as F.A. 95, section (5,6) RS-1. Double Barrel RC Box culvert 40'-0" o. to o. headwalls. Extend to 60'-0" o. to o. headwalls.

No Salvage.

STATE OF ILLINOIS
DEPARTMENT OF TRANSPORTATION

ROUTE NO.	SECTION	COUNTY	TOTAL SHEETS	SHEET NO.	SHEET NO. 1 4 SHEETS
FAP 95	6RS-2	JASPER	546	264	
FED. ROAD DIST. NO.		ILLINOIS	FED. AID PROJECT		

Contract No. 94437

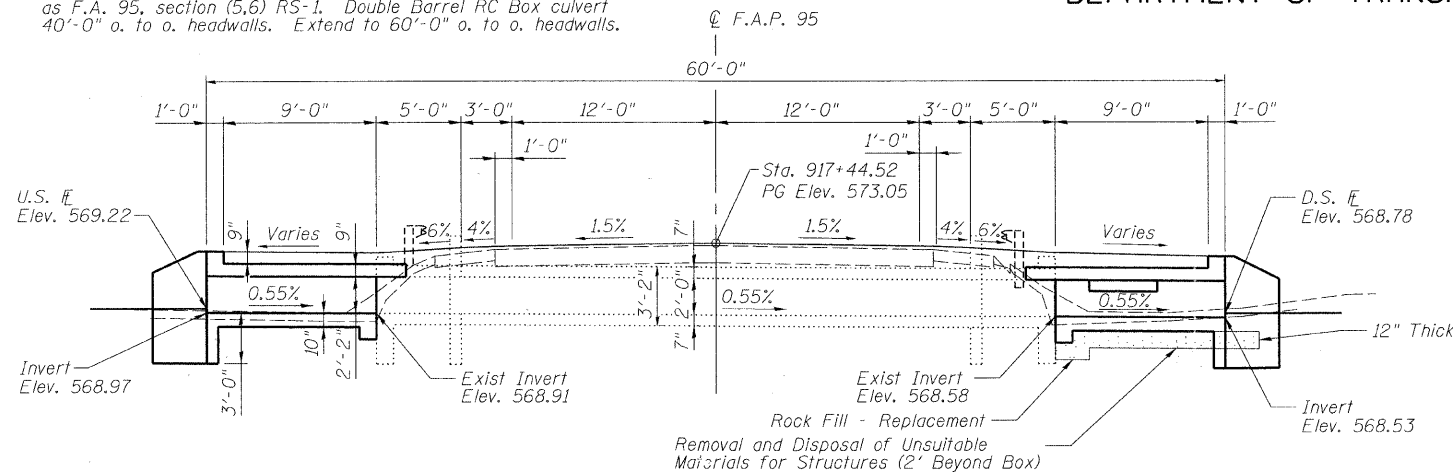

ELEVATION

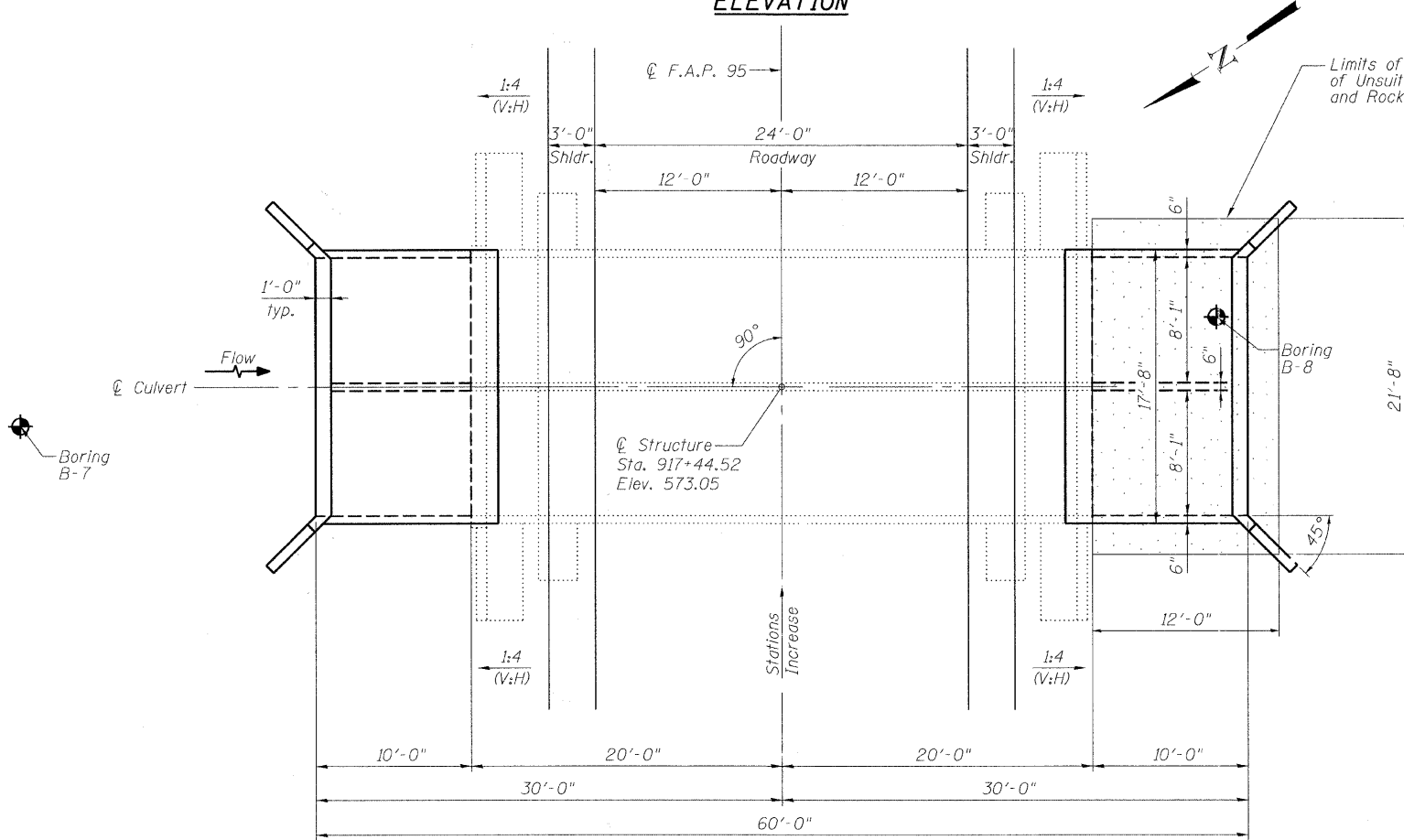

PLAN

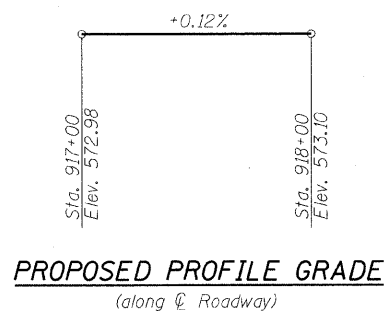

PROPOSED PROFILE GRADE
(along \bar{C} Roadway)

Notch formed by rough finished board attached to and removed with formwork, each interior wall. (Do not chamfer).

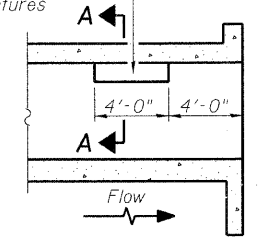

LONGITUDINAL SECTION

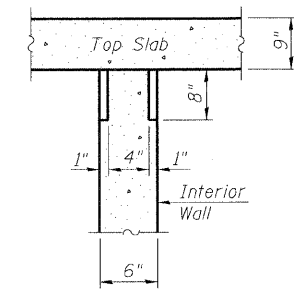

SECTION A-A

**PHOEBE NESTING
SITE DETAILS**
(Downstream End Only)

GENERAL NOTES

Reinforcement bars shall conform to the requirements of ASTM A 706 Gr 60.

Plan dimensions and details relative to existing plans are subject to nominal construction variations. The Contractor shall field verify existing dimensions and details affecting new construction and make necessary approved adjustments prior to construction or ordering of materials. Such variations shall not be cause for additional compensation for a change in scope of the work, however, the Contractor will be paid for the quantity actually furnished at the unit price bid for the work.

All Construction joints shall be bonded.
For traffic control, see Roadway Plans.

A distance of half the length of the wingwall but not less than six feet of the barrel shall be poured monolithically with the wingwalls.

Removal and disposal of unsuitable materials for Structures and Rockfill-Replacement are estimated volumes only and final limits will be determined in the field during excavation of all culvert/culvert extensions, by the engineer.

TOTAL BILL OF MATERIAL

ITEM	UNIT	TOTAL
Concrete Removal	Cu Yd	3.3
Expansion Bolts $\frac{3}{4}$ inch	Each	60
Concrete Box Culverts	Cu Yd	31.4
Reinforcement Bars	Pounds	7230
Rock Fill - Replacement	Ton	20
Removal and Disposal of Unsuitable Materials for Structures	Cu Yd	10

APPROVED
FOR STRUCTURAL ADEQUACY ONLY

Ralph E. Anderson (TS)
ENGINEER OF BRIDGES AND STRUCTURES

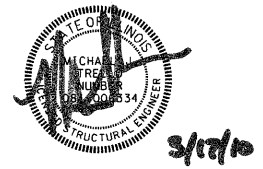

Expires: 11/30/10

DESIGN SPECIFICATIONS

2002 AASHTO
LOADING HS20-44
Allow 50#/sq. ft. for future wearing surface.

DESIGN STRESSES

FIELD UNITS
 $f'_c = 3,500$ psi
 $f_y = 60,000$ psi (reinforcement)

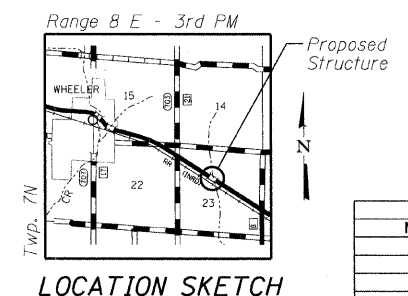

LOCATION SKETCH

REVISIONS	
NAME	DATE

ILLINOIS DEPARTMENT OF TRANSPORTATION
GENERAL PLAN
IL RTE 33 OVER DRAINAGE DITCH
FAP 95
SECTION 6RS-2
STA. 917+44.52
JASPER COUNTY
S.N. 040-8300

SCALE: VERT. 1"=10'
HORIZ. 1"=40'
DATE: 5/19/04

DRAWN BY: LANDREY
DESIGNED BY: SANFORD
CHECKED BY: WATKINS

COMPUTER FILE NO. SN040-8300
PROJECT 01256
2/26/10-FAV

GREENE & BRADFORD, INC.
CONSULTING ENGINEERS
OF BRIDGEWORK
1001 W. STATE ST., SUITE 200
SPRINGFIELD, ILLINOIS 62761
PH: 217-223-1111 FAX: 217-223-1112
WWW.GREENEANDBRADFORD.COM