

DESIGN		
INT.	DATE	REASON

CULVERT NO. 11A  
STA. 71+51  
EXISTING 2' X 2' RCBC

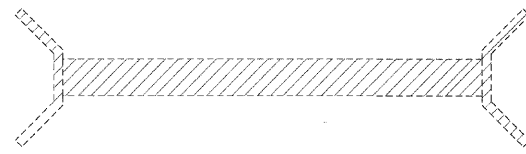

REMOVAL OF EXISTING STRUCTURES NO. 5 - 1 EACH  
TRENCH BACKFILL - 10 CY

380E/1300N (T.R. 155)

PLOTS & CHECKS		
INT.	DATE	REASON

CULVERT NO. 11B  
STA. 71+67.64  
EXISTING 2' X 2' RCBC

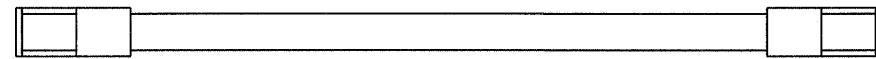

PRECAST CONCRETE BOX CULVERT 2' X 2' - 54 FOOT  
BOX CULVERT END SECTION CULVERT NO. 11 - 2 EACH  
CUT - 6 CY  
FILL - 3 CY  
DESIGN FILL HEIGHT - < 2'

380E/1300N (T.R. 155)

CHECKS		
INT.	DATE	REASON

CULVERT NO. 12  
STA. 881+46.00, 36' LT.  
33° SKEW

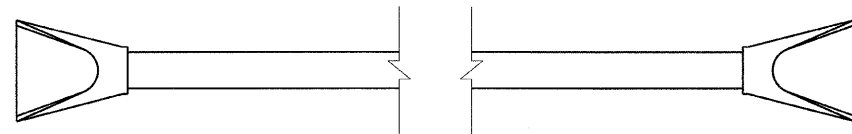

PIPE CULVERTS, CLASS A, TYPE 1 - 62 FOOT  
EQUIVALENT ROUND-SIZE 36" - 2 EACH  
PRC FLARED END SECTIONS - 2 EACH  
EQUIVALENT ROUND-SIZE 36" GRATING FOR CONCRETE FLARED END SECTION EQUIVALENT ROUND-SIZE 36" - 2 EACH  
TRENCH BACKFILL - 17 CY  
POROUS GRANULAR BEDDING - 5 CY  
CUT - 36 CY  
FILL - 10 CY

GILA ROAD (FAS 703/CH 21)

CULVERT NO. 13  
STA. 881+50.00  
EXISTING 3' X 1.5' RCBC  
33° SKEW

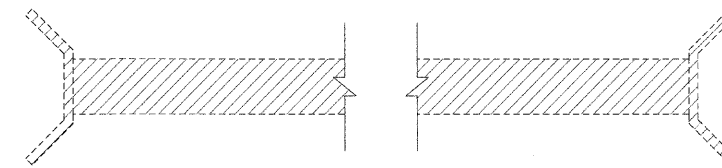

REMOVAL OF EXISTING STRUCTURES NO. 6 - 1 EACH  
CUT - 1 CY  
FILL - 2 CY

GILA ROAD (FAS 703/CH 21)

CULVERT NO. 14  
STA. 882+00.00, 37' RT.  
30° SKEW

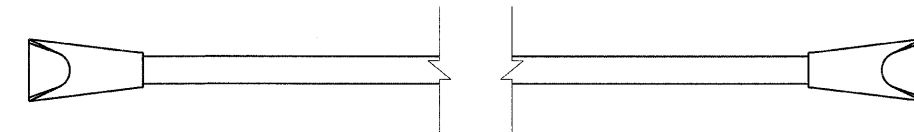

PIPE CULVERTS, CLASS A, TYPE 1 24" - 78 FOOT  
PRC FLARED END SECTIONS 24" - 2 EACH  
TRENCH BACKFILL - 13 CY  
POROUS GRANULAR BEDDING - 4 CY  
CUT - 39 CY  
FILL - 16 CY

400E (T.R. 56)

CULVERT NO. 15  
STA. 882+07.00  
EXISTING 3' X 1.5' RCBC  
32° SKEW

**LEGEND**

▨ - EXISTING ITEMS TO BE REMOVED

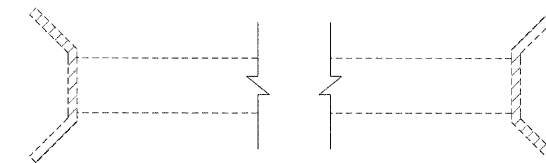

CONCRETE HEADWALL REMOVAL - 2 EACH  
FILLING EXISTING CULVERT - 1 EACH  
CUT - 2 CY  
FILL - 6 CY

F.A.P. RTE.	SECTION	COUNTY	TOTAL SHEETS	SHEET NO.
95		JASPER	546	280

STA. TO STA.

FED. ROAD DIST. NO.	ILLINOIS	FED. AID PROJECT
*15,6Y,RS-2,6BR-7		

CONTRACT NO. 94437

ILLINOIS DEPARTMENT OF TRANSPORTATION

**CULVERT DETAILS**

FAP ROUTE 95 (IL RTE. 33)  
SECTION (5,6)Y,RS-2,6BR-7  
JASPER COUNTY

SCALE: VERT. DATE: 09/16/02  
HORIZ. DRAWN BY: BISHOP  
DESIGNED BY: COLBROOK  
CHECKED BY: COLBROOK

GREENE & BRADFORD, INC.  
OF SPRINGFIELD  
CONSULTING ENGINEERS  
REGISTERED PROFESSIONAL ENGINEERS  
PROFESSIONAL DESIGN FIRM NO. 00088  
PROFESSIONAL & SURVEYING, PROFESSIONAL CORPORATION  
Q10 710-SM4, Q10 710-S227 I/E-1144 - COLBROOK@GREENEANDBRADFORD.COM

COMPUTER FILE NO.  
CULV\_DET.DGN-3  
PROJECT 01256  
2/26/10-FAV

REVISIONS	
NAME	DATE