

**NOTES**

1. TYPE III BARRICADES AND ROAD CLOSURE SIGNS SHALL BE POSITIONED AS SHOWN, IN ACCORDANCE WITH HIGHWAY STANDARD 701901, THE MANUAL ON UNIFORM TRAFFIC CONTROL DEVICES, AND AS DIRECTED BY THE ENGINEER.
2. TYPE A LOW INTENSITY FLASHING WARNING LIGHTS SHALL BE USED ON THE FIRST SIGN IN ADVANCE OF THE WORK SITE AND TYPE III BARRICADES DURING HOURS OF DARKNESS.
3. ALL WARNING SIGNS SHALL BE A MINIMUM OF 48" x 48" AND HAVE A BLACK LEGEND AND BORDER ON A FLUORESCENT ORANGE REFLECTORIZED BACKGROUND.
4. SPACE WARNING SIGNS APPROXIMATELY 350' APART (UNLESS OTHERWISE NOTED). EXACT LOCATION OF WARNING SIGNS AND BARRICADES SHALL BE STAKED IN THE FIELD FOR APPROVAL BY THE ENGINEER PRIOR TO INSTALLATION.
5. THE CONTRACTOR SHALL MAINTAIN ACCESS TO ENTRANCES AT ALL TIMES.
6. ALL RESIDENTS/BUSINESSES FRONTING THE PROJECT SHALL BE NOTIFIED AT LEAST 48 HOURS PRIOR TO ROAD CLOSURES AFFECTING THEIR ACCESS.
7. SEE HIGHWAY STANDARDS 701801 AND 701901 FOR ADDITIONAL TRAFFIC CONTROL GUIDELINES
8. TRAFFIC CONTROL SIGNS, PLACEMENT, AND MAINTENANCE PAID FOR IN UNIT COST FOR TRAFFIC CONTROL AND PROTECTION, (SPECIAL).

**LEGEND**

	ROAD CONSTRUCTION AHEAD-W20-110310)		ROADWAY RECONSTRUCTION & WIDENING
	WORKERS-W21-1g10) (SIGN TO BE DISPLAYED ONLY WHEN WORKERS PRESENT)		24" x 24"
	24" x 24"		24" x 24"
	36" x 12" FRANK SCOTT PKWY W		TYPE A LOW INTENSITY FLASHING LIGHT
			48" x 48" FLUORESCENT ORANGE

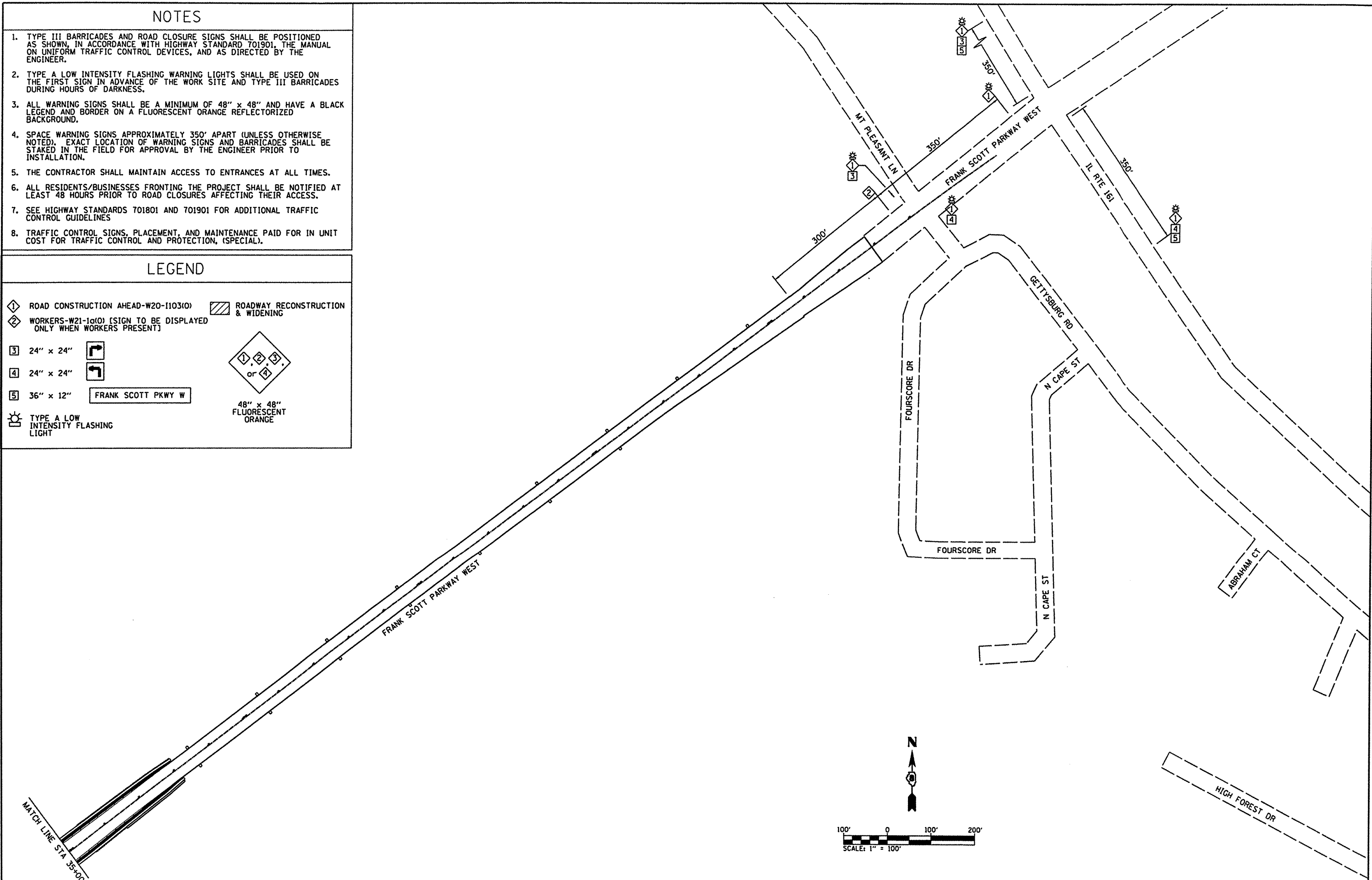

FILE NAME = 0829861-sht-staging.dgn

USER NAME = default	DESIGNED -	REVISED -
PLOT TIME = 1:35:28 PM	DRAWN - AME	REVISED -
PLOT SCALE = 40.0000 ' / IN.	CHECKED -	REVISED -
PLOT DATE = 10/14/2011	DATE -	REVISED -

**STATE OF ILLINOIS**  
**DEPARTMENT OF TRANSPORTATION**

**FRANK SCOTT PARKWAY WEST**  
**MAINTENANCE OF TRAFFIC PLAN**

SCALE: SHEET NO. OF SHEETS STA. TO STA.

F.A. RTE. 9330	SECTION 08-00211-00-PV	COUNTY ST. CLAIR	TOTAL SHEETS 85	SHEET NO. 22
CONTRACT NO. 97480			ILLINOIS FED. AID PROJECT	