

DATE	
BY	
SURVEYED	
PLOTTED	
TEMPLATE	
AREAS	
CHECKED	
FINAL SURVEY NOTE BOOK NO.	

DATE	
BY	
SURVEYED	
PLOTTED	
TEMPLATE	
AREAS	
CHECKED	
ORIGINAL SURVEY NOTE BOOK NO.	

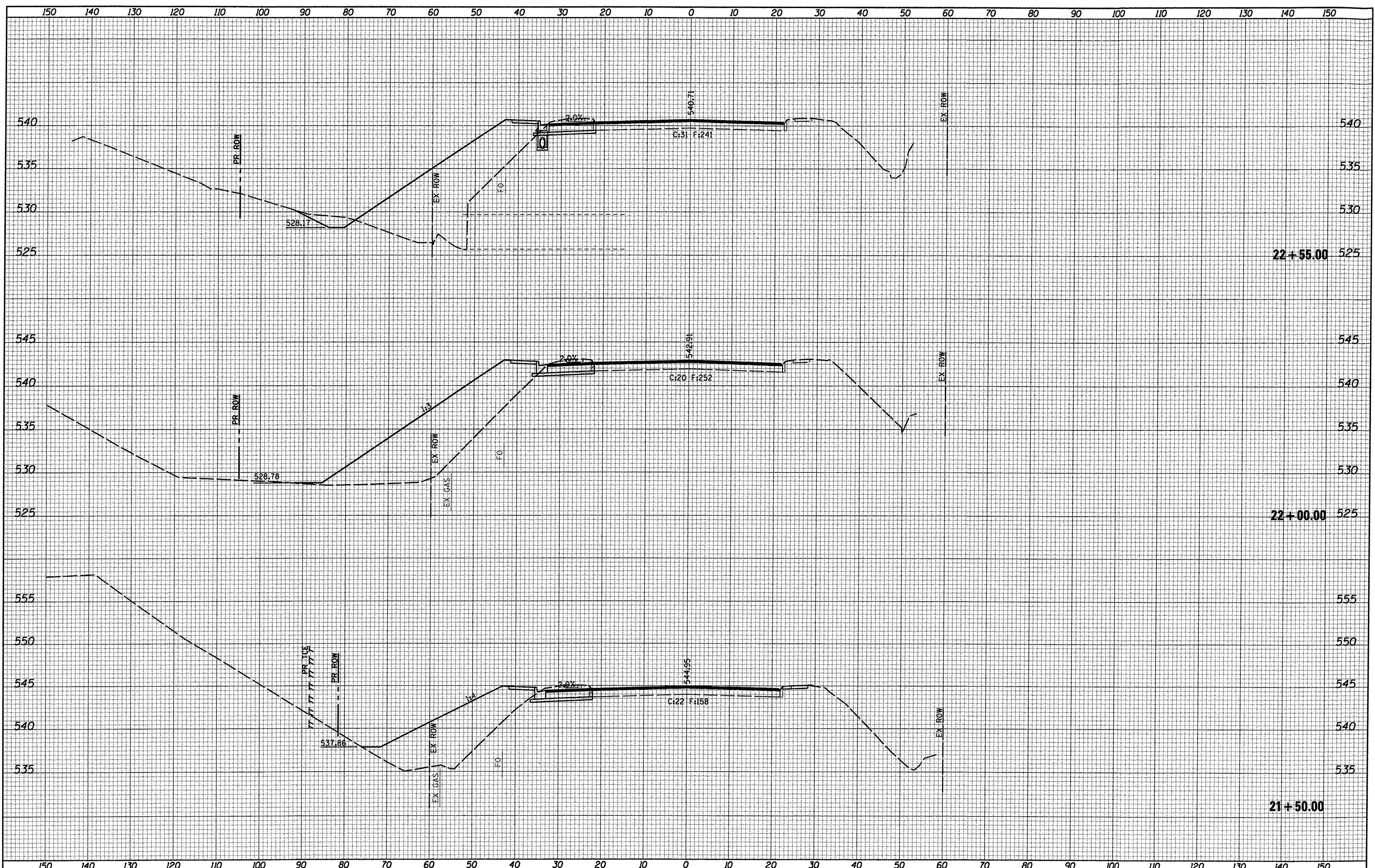

FILE NAME : D029061-sht-xxsht.dgn

USER NAME = default	DESIGNED -	REVISED -
PLOT TIME = 2:43:09 PM	DRAWN -	REVISED -
PLOT SCALE = 20.0000' / IN.	CHECKED -	REVISED -
PLOT DATE = 10/31/2011	DATE -	REVISED -

**STATE OF ILLINOIS  
DEPARTMENT OF TRANSPORTATION**

**CROSS SECTIONS**

SCALE: SHEET NO. 14 OF 52 SHEETS STA. 21+50.00 TO STA. 22+55.00

F.A. RTE. 9330	SECTION 08-00211-00-PV	COUNTY ST. CLAIR	TOTAL SHEETS 85	SHEET NO. 46
CONTRACT NO. 97480				ILLINOIS FED. AID PROJECT