





LEGEND

-  WORK ZONE (STAGE AS SPECIFIED)
-  TEMPORARY PAVEMENT
-  COMPLETED TEMPORARY PAVEMENT
-  TEMPORARY RAMP
-  COMPLETED TEMPORARY RAMP
-  COMPLETED PAVEMENT

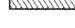
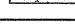
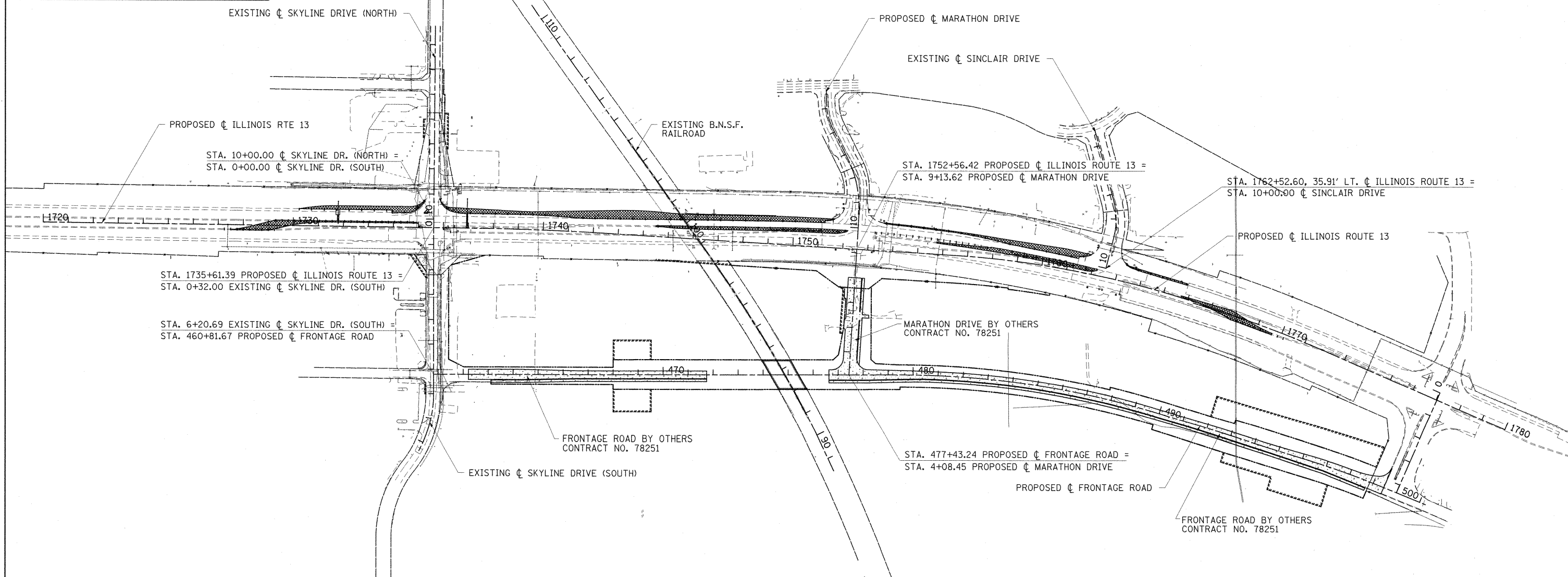
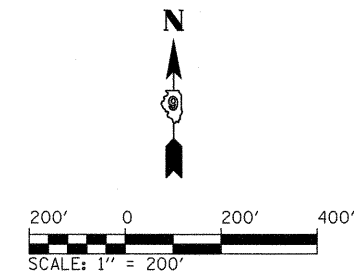

**STAGE 1A
ILLINOIS RTE. 13**

- NOTES:
1. ADDITIONAL TRAFFIC CONTROL DEVICES MAY BE NECESSARY AS DIRECTED BY THE ENGINEER.
 2. TRAFFIC CONTROL FOR THIS WORK SHALL BE PAID FOR AS TRAFFIC CONTROL AND PROTECTION, (SPECIAL), LUMP SUM.
 3. REMOVE EXISTING HOT-MIX ASPHALT SHOULDERS, CONSTRUCT TEMPORARY PAVEMENT, REQUIRED GRADING, AND DRAINAGE ITEMS AS SHOWN ON STAGE 1A SHEETS.
 4. INSTALL TEMPORARY SIGNALS AT THE INTERSECTIONS OF ILLINOIS ROUTE 13 AT SKYLINE DRIVE AND SINCLAIR DRIVE.
 5. IF LANE CLOSURES ARE NEEDED, SET UP TRAFFIC CONTROL DEVICES ACCORDING TO STANDARD 701601.
 6. WORK DURING THIS STAGE, REQUIRING A LANE CLOSURE, SHALL BE COMPLETED DURING OFF-PEAK HOURS. LANE CLOSURES DURING PEAK HOURS WILL NOT BE ALLOWED.
 7. MAINTAIN TRAFFIC IN EXISTING LANES.
 8. A 2' WIDE 2" THICK STRIP OF HOT-MIX ASPHALT BINDER COURSE, IL-19.0, N90 PAVEMENT SHALL BE PLACED ON THE NORTH SIDE OF THE WB LANES PRIOR TO SWITCHING TO STAGE 1B TO SERVE AS THE PAD TO PLACE AND PIN THE TEMPORARY CONCRETE BARRIER. THE LIMITS OF THE TEMPORARY PAVEMENT STRIP ARE FROM STA. 1745+65.00 TO STA. 1749+25.27.

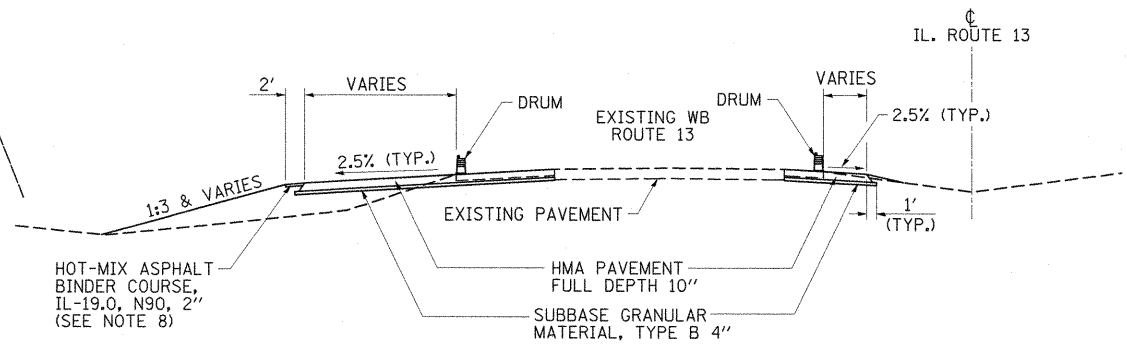

FILE NAME =	USER NAME = OpenH&B Springfield	DESIGNED - KPF	REVISED -
1:\dot\0906603\draw\CADD_Sheets\098859-sh1-mot-stage1a-1.dgn		DRAWN - TAP	REVISED -
PLOT SCALE = 200,0000 ' / IN.		CHECKED - SPH	REVISED -
PLOT DATE = 12/14/2011		DATE - 12/9/11	REVISED -

**STATE OF ILLINOIS
DEPARTMENT OF TRANSPORTATION**

**STAGE 1A CONSTRUCTION
OVERALL TRAFFIC CONTROL PLAN**

SCALE: 1" = 200' SHEET NO. OF SHEETS STA. 1720+00.00 TO STA. 1780+00.00

F.A. RTE.	SECTION	COUNTY	TOTAL SHEETS	SHEET NO.
331	(1X-1) VB-1, B-1, N-4, R-3	WILLIAMSON	367	65
CONTRACT NO. 98859				
ILLINOIS FED. AID PROJECT				