

**LEGEND**

- WORK ZONE (STAGE AS SPECIFIED)
- TEMPORARY PAVEMENT
- COMPLETED TEMPORARY PAVEMENT
- TEMPORARY RAMP
- COMPLETED TEMPORARY RAMP
- COMPLETED PAVEMENT

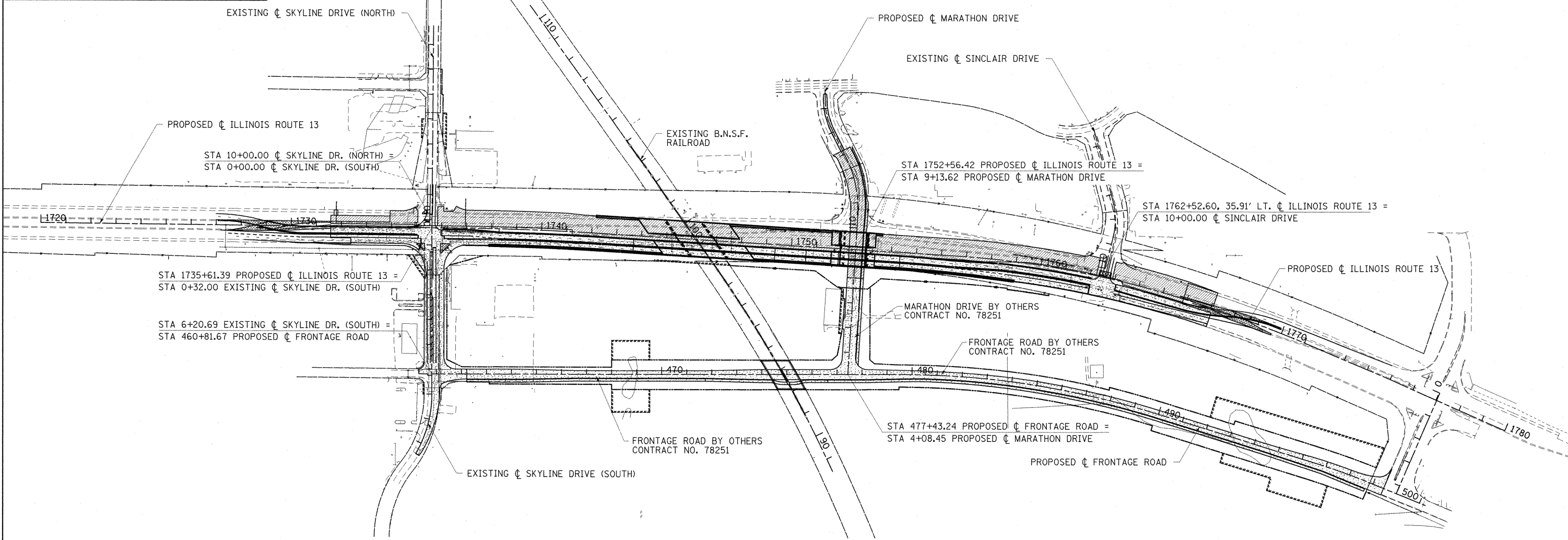
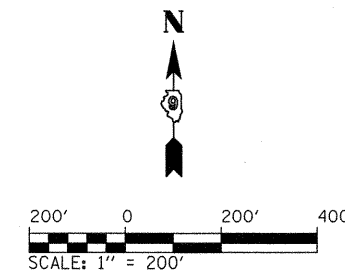

**STAGE 2A  
ILLINOIS RTE. 13**

**NOTES:**

1. ADDITIONAL TRAFFIC CONTROL DEVICES MAY BE NECESSARY AS DIRECTED BY THE ENGINEER.
2. TRAFFIC CONTROL FOR THIS WORK SHALL BE PAID FOR AS TRAFFIC CONTROL AND PROTECTION, (SPECIAL), LUMP SUM.
3. ILLINOIS ROUTE 13 TRAFFIC IS SWITCHED TO NEWLY CONSTRUCTED EB LANES.
4. AT SKYLINE / IL ROUTE 13 INTERSECTION, RAISED ISLANDS, RAISED MEDIANS, PERMANENT SIGNALS AND REMOVAL OF TEMPORARY PAVEMENT ARE TO BE CONSTRUCTED AFTER STAGE 2, WHEN TRAFFIC IS IN THE PERMANENT LANE CONFIGURATIONS.
5. BEGIN CONSTRUCTION OF IL ROUTE 13 WB DRAINAGE, EMBANKMENT, PAVEMENT, MSE WALLS, BRIDGES AND ASSOCIATED IMPROVEMENTS IN THE WORK AREAS SHOWN.
6. BEGIN CONSTRUCTION OF THE IMPROVEMENTS AT THE INTERSECTIONS OF IL ROUTE 13 WITH SKYLINE DRIVE AND SINCLAIR DRIVE IN THE WORK AREAS SHOWN.
7. CONTRACTOR WILL BE ALLOWED TO USE THE EXISTING IL ROUTE 13 WESTBOUND LANE RAILROAD CROSSING FOR CONSTRUCTION ACCESS DURING THIS STAGE. A RAILROAD FLAGGER WILL BE REQUIRED.
8. MODIFY TEMPORARY TRAFFIC SIGNALS AT THE INTERSECTIONS OF ILLINOIS ROUTE 13 AT SKYLINE DRIVE AND SINCLAIR DRIVE.

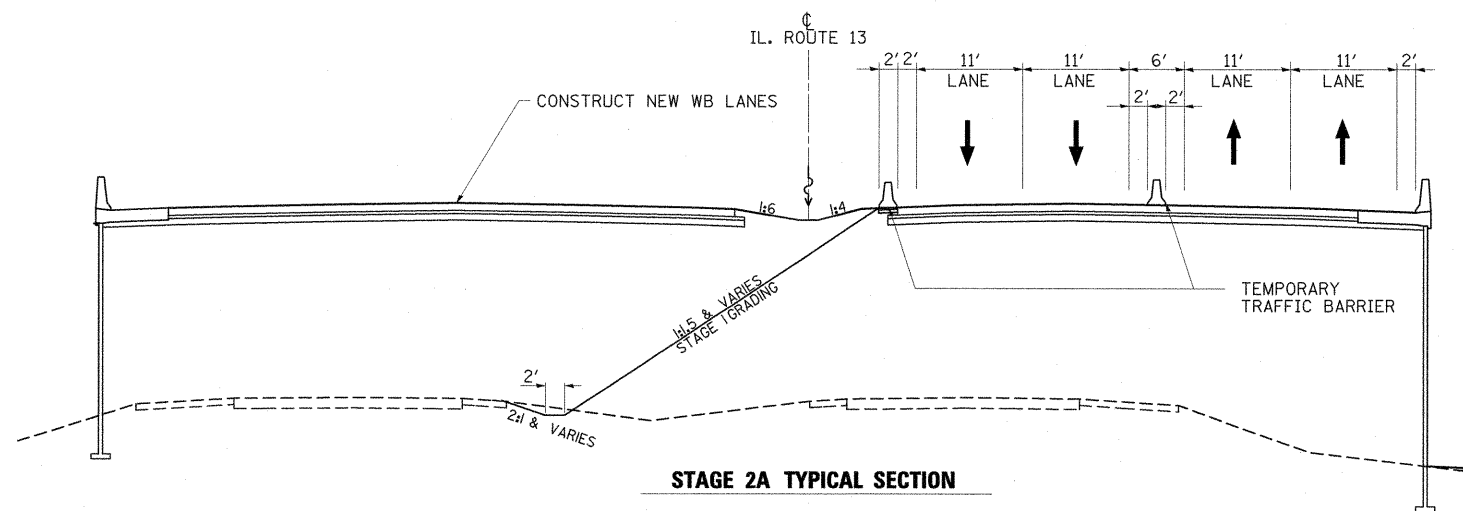

**STAGE 2A TYPICAL SECTION**

FILE NAME =	USER NAME = OpenH&B Springfield	DESIGNED - KPF	REVISED -
3:\dot\0906603\draw\CADD_Sheets\099885	3-sht-mot-stage2a-1.dgn	DRAWN - TAP	REVISED -
	PLOT SCALE = 200.0000' / IN.	CHECKED - SPH	REVISED -
	PLOT DATE = 12/14/2011	DATE - 12/9/11	REVISED -

**STATE OF ILLINOIS  
DEPARTMENT OF TRANSPORTATION**

**STAGE 2A CONSTRUCTION  
OVERALL TRAFFIC CONTROL PLAN**

SCALE: 1" = 200' SHEET NO. OF SHEETS STA. 1720+00.00 TO STA. 1780+00.00

F.A. RTE.	SECTION	COUNTY	TOTAL SHEETS	SHEET NO.
331	(1X-1) VB-1, B-1, N-4, R-3	WILLIAMSON	367	82
CONTRACT NO. 98859				
ILLINOIS FED. AID PROJECT				