

LEGEND

- DIRECTION OF TRAFFIC FLOW
- WORK ZONE (STAGE AS SPECIFIED)
- TEMPORARY PAVEMENT
- COMPLETED TEMPORARY PAVEMENT
- TEMPORARY RAMP
- COMPLETED TEMPORARY RAMP
- COMPLETED PAVEMENT
- TEMPORARY CONCRETE BARRIER WITH BARRIER WALL MARKERS PER STANDARD 704001
- ARROW BOARD
- SIGN
- DIRECTION INDICATOR BARRICADE WITH STEADY BURN MONODIRECTIONAL LIGHT
- TYPE II BARRICADE, DRUM, OR VERTICAL BARRICADE WITH STEADY BURN MONODIRECTIONAL LIGHT
- TYPE III BARRICADE
- IMPACT ATTENUATORS, TEMPORARY (NON-REDIRECTIVE), TEST LEVEL 2
- IMPACT ATTENUATORS, TEMPORARY (FULLY REDIRECTIVE, NARROW), TEST LEVEL 2

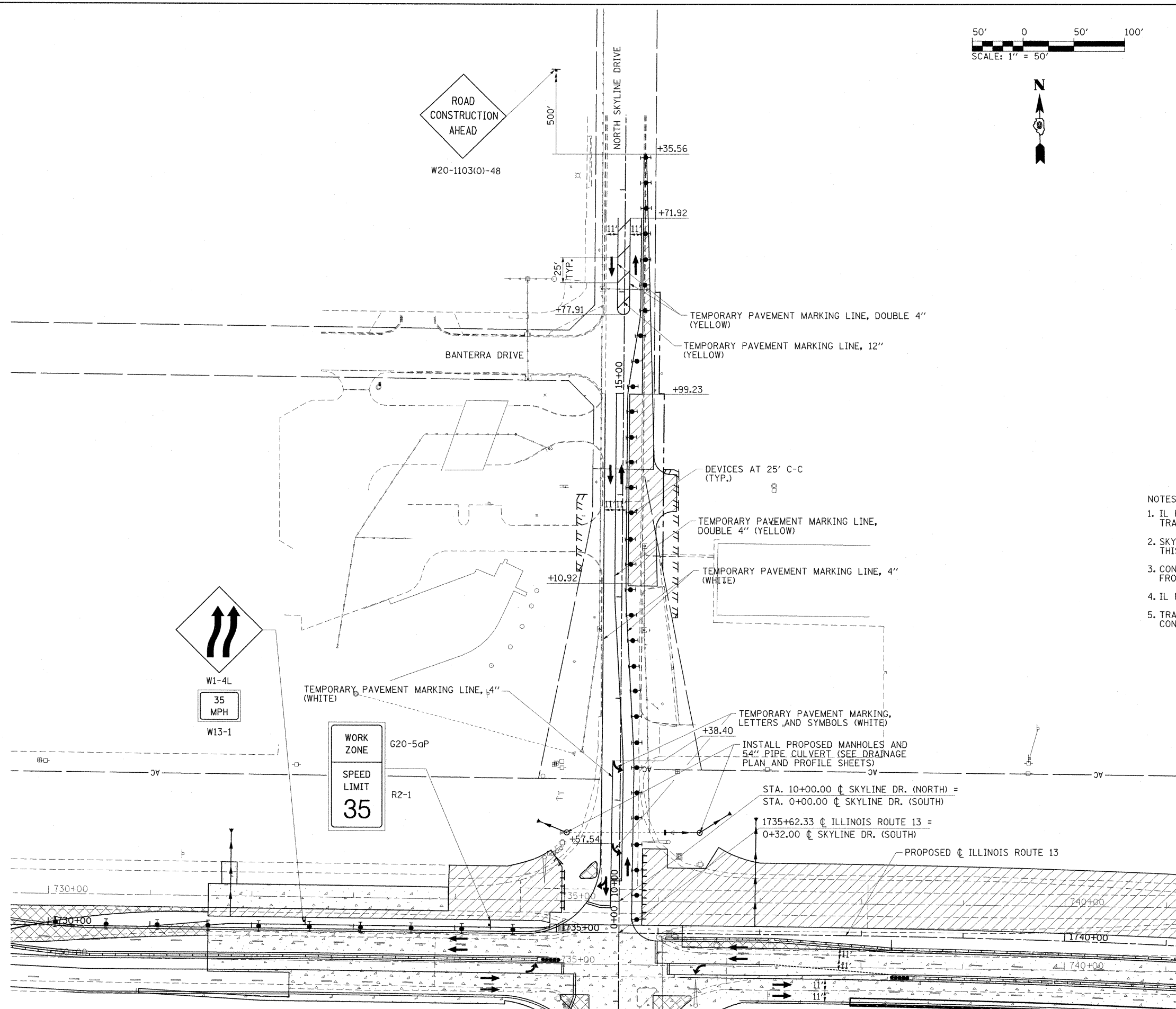

- NOTES:
1. IL ROUTE 13, FRONTAGE ROAD, MARATHON DRIVE, AND SINCLAIR TRAFFIC REMAINS THE SAME AS STAGE 2A.
 2. SKYLINE DRIVE NORTH TRAFFIC SHIFTED WEST TO 2 - 11' LANES THIS STAGE ALONG WORK ZONE.
 3. CONSTRUCT NB SKYLINE DRIVE NORTH WIDENING AND IMPROVEMENTS FROM STA. 13+10.92 TO STA. 17+35.56 IN THE WORK AREAS SHOWN.
 4. IL ROUTE 13 STAGE 2A WORK CONTINUES.
 5. TRAFFIC CONTROL FOR THIS WORK SHALL BE PAID FOR AS TRAFFIC CONTROL AND PROTECTION, (SPECIAL), LUMP SUM.

FILE NAME =	USER NAME = OpenH&B Springfield	DESIGNED - KPF	REVISED -	STATE OF ILLINOIS DEPARTMENT OF TRANSPORTATION	MAINTENANCE OF TRAFFIC PLAN STAGE 2B	F.A. RTE.	SECTION	COUNTY	TOTAL SHEETS	SHEET NO.	
	1:\dot\8906603\draw\CADD_Sheets\0998859-sht-mot-stage2b-2.dgn	DRAWN - TAP	REVISED -			331	(1X-1) VB-1, B-1, N-4, R-3	WILLIAMSON	367	88	
	PLOT SCALE = 50.0000' / IN.	CHECKED - SPH	REVISED -			CONTRACT NO. 98859					
	PLOT DATE = 12/14/2011	DATE - 12/9/11	REVISED -			ILLINOIS FED. AID PROJECT					
						SCALE: 1"=50'	SHEET NO.	OF SHEETS	STA.	TO STA.	