

LEGEND	
	DIRECTION OF TRAFFIC FLOW
	WORK ZONE (STAGE AS SPECIFIED)
	TEMPORARY PAVEMENT
	COMPLETED TEMPORARY PAVEMENT
	TEMPORARY RAMP
	COMPLETED TEMPORARY RAMP
	COMPLETED PAVEMENT
	TEMPORARY CONCRETE BARRIER WITH BARRIER WALL MARKERS PER STANDARD 704001
	ARROW BOARD
	SIGN
	DIRECTION INDICATOR BARRICADE WITH STEADY BURN MONODIRECTIONAL LIGHT
	TYPE II BARRICADE, DRUM, OR VERTICAL BARRICADE WITH STEADY BURN MONODIRECTIONAL LIGHT
	TYPE III BARRICADE
	IMPACT ATTENUATORS, TEMPORARY (NON-REDIRECTIVE), TEST LEVEL 2
	IMPACT ATTENUATORS, TEMPORARY (FULLY REDIRECTIVE, NARROW), TEST LEVEL 2

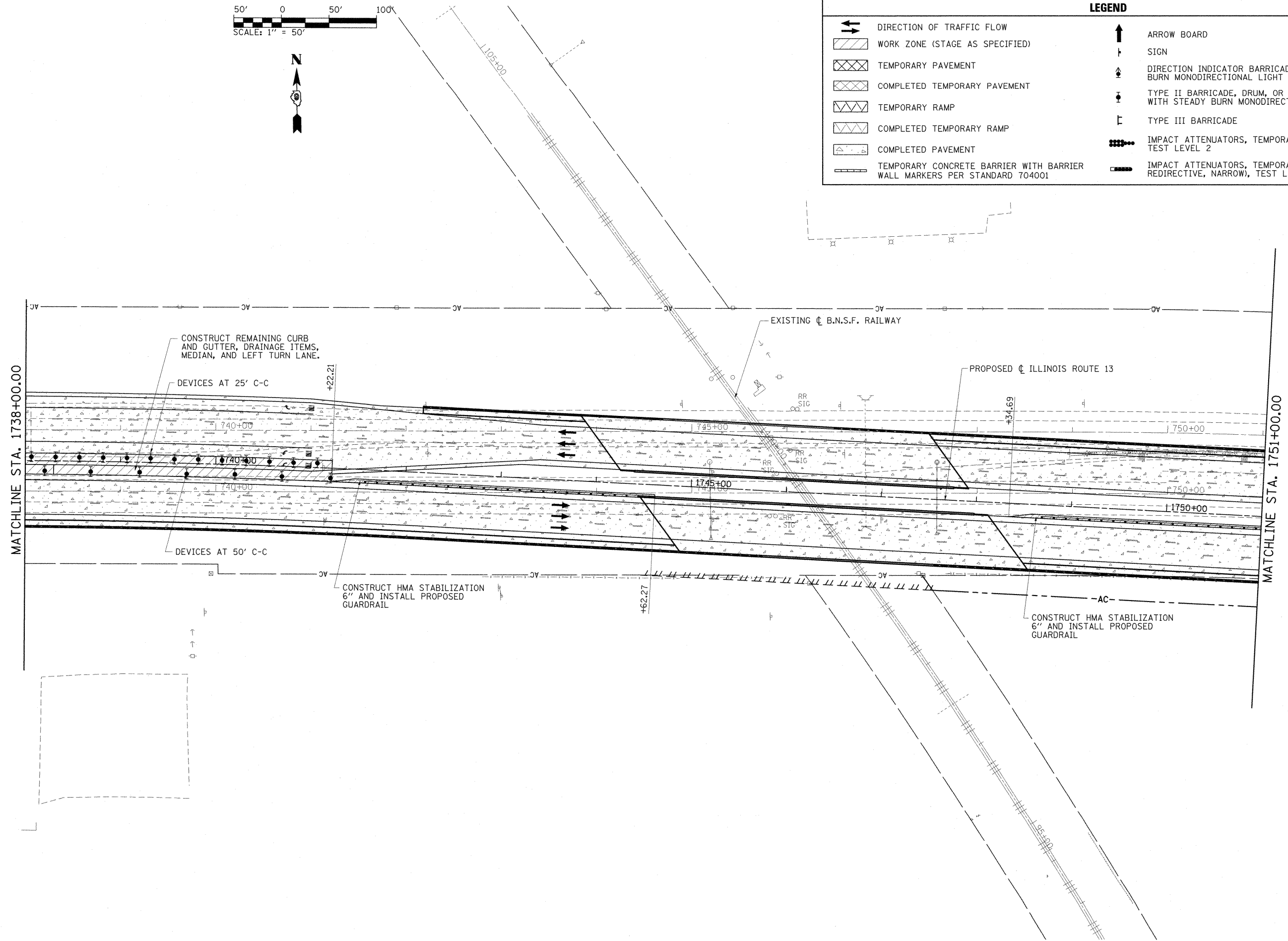

FILE NAME =	USER NAME = OpenH&B Springfield	DESIGNED - KPF	REVISED -	<b>STATE OF ILLINOIS DEPARTMENT OF TRANSPORTATION</b>	<b>MAINTENANCE OF TRAFFIC PLAN STAGE 3</b>	F.A. RTE.	SECTION	COUNTY	TOTAL SHEETS	SHEET NO.	
I:\dot\0906603\draw\CADD_Sheets\D998859\shht-not-stage3-3.dgn	DRAWN - TAP	CHECKED - SPH	REVISED -			331	(1X-1) VB-1, B-1, N-4, R-3	WILLIAMSON	367	96	
PLOT SCALE = 50.0000 "/> <td>DATE - 12/9/11</td> <td>REVISED -</td> <td>SCALE: 1"=50'</td> <td>SHEET NO. OF SHEETS</td> <td>STA. 1738+00.00 TO STA. 1751+00.00</td> <td colspan="4">ILLINOIS FED. AID PROJECT</td>	DATE - 12/9/11	REVISED -	SCALE: 1"=50'			SHEET NO. OF SHEETS	STA. 1738+00.00 TO STA. 1751+00.00	ILLINOIS FED. AID PROJECT			
PLOT DATE = 12/14/2011								CONTRACT NO. 98859			