

LEGEND

- INLET AND PIPE PROTECTION
- TEMPORARY DITCH CHECKS
- SEDIMENT BASIN
- PERIMETER EROSION BARRIER
- EROSION CONTROL BLANKET
- STONE RIPRAP

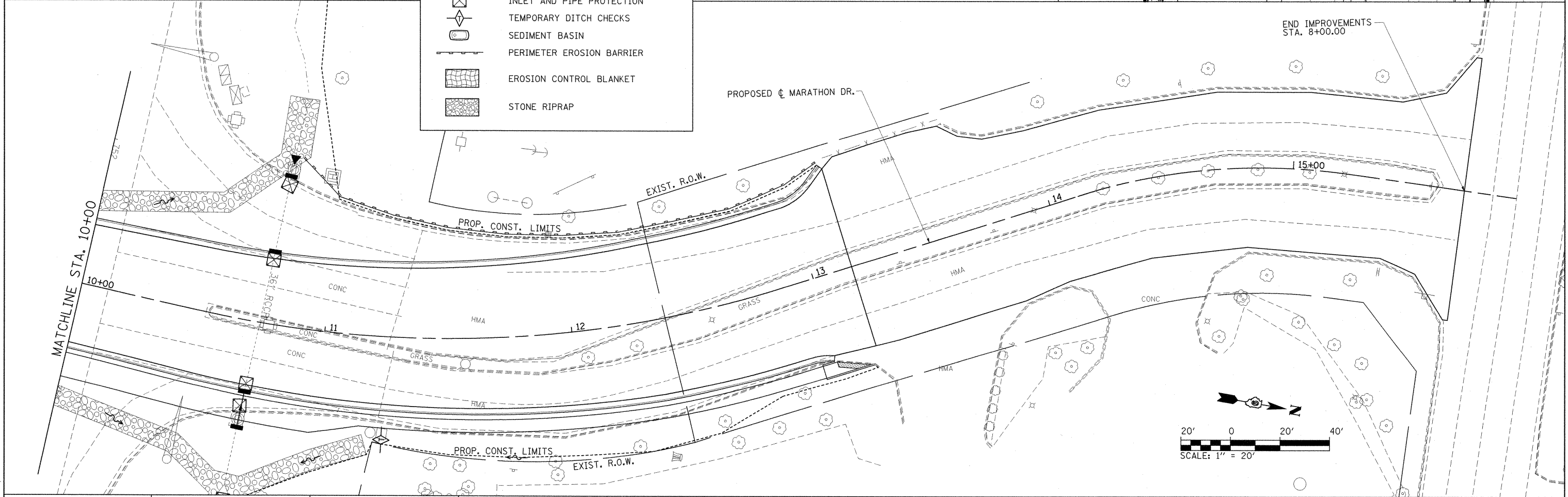

FILE NAME =	USER NAME = OpenH&B Springfield	DESIGNED - BMB	REVISED -	STATE OF ILLINOIS DEPARTMENT OF TRANSPORTATION	EROSION AND SEDIMENT CONTROL PLAN MARATHON DRIVE	F.A. RTE.	SECTION	COUNTY	TOTAL SHEETS	SHEET NO.	
1:\dot\0906603\draw\CADD_Sheets\0998859-shr-eros009.dgn	PLOT SCALE = 20.0000 "/td> <td>DRAWN - GLD</td> <td>REVISED -</td> <td>331</td> <td>(1X-1) VB-1, B-1, N-4, R-3</td> <td>WILLIAMSON</td> <td>367</td> <td>109</td>	DRAWN - GLD	REVISED -			331	(1X-1) VB-1, B-1, N-4, R-3	WILLIAMSON	367	109	
PLOT DATE = 12/12/2011	DATE - 12/9/11	CHECKED - SPH	REVISED -			CONTRACT NO. 98859					
		SCALE: 1" = 20'	SHEET NO. OF SHEETS			ILLINOIS FED. AID PROJECT					