

BRUSH PILE  
53' LONG X 45' WIDE  
11.477

15+00  
PROPOSED  $\phi$  MARATHON DRIVE  
GRVL  
PROPOSED  $\phi$  FRONTAGE ROAD  
11.478

LEGEND	
	- COMBINATION CURB AND GUTTER REMOVAL
	- MEDIAN AND ISLAND REMOVAL
	- PAVEMENT REMOVAL
	- HOT-MIX ASPHALT SURFACE REMOVAL, 1 1/2"
	- PAVED SHOULDER REMOVAL
	- DRIVEWAY PAVEMENT REMOVAL
X	- TREE REMOVAL

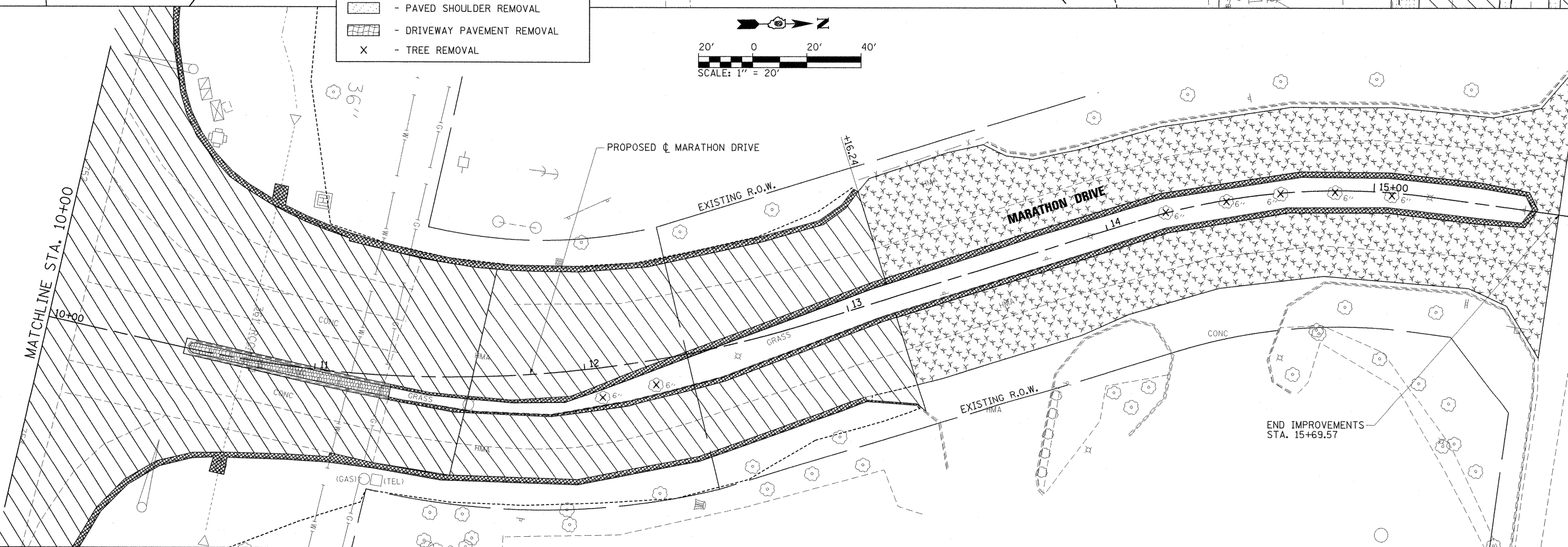
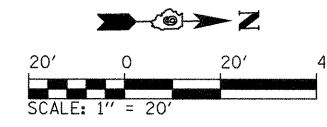

FILE NAME = L:\DOT\0906603\Draw\CADD_Sheets\099889-9-sht-rem005Marathon.dgn	USER NAME = OpenH&B Springfield	DESIGNED - BMB	REVISED -
PLOT SCALE = 20.0000' / IN.	CHECKED - SPH	DRAWN - GLD	REVISED -
PLOT DATE = 12/14/2011	DATE - 12/9/11		REVISED -

**STATE OF ILLINOIS  
DEPARTMENT OF TRANSPORTATION**

**REMOVAL PLAN  
MARATHON DRIVE**

SCALE: 1" = 20' SHEET NO. OF SHEETS STA. 8+00.00 TO STA. 15+69.57

F.A. RTE.	SECTION	COUNTY	TOTAL SHEETS	SHEET NO.
331	(1X-1) VB-1, B-1, N-4, R-3	WILLIAMSON	367	124
				CONTRACT NO. 98859
ILLINOIS FED. AID PROJECT				

MATCHLINE STA. 10+00