

- NOTES:**
1. THE CONTRACTOR SHALL BE REQUIRED TO REMOVE ALL OF THE EXISTING TRAFFIC SIGNAL EQUIPMENT, SUSPENDED AND BURIED, AT WHICH TIME IT INTERFERES WITH EITHER TEMPORARY OR PROPOSED IMPROVEMENTS.
 2. REMOVE EXISTING CONCRETE FOUNDATIONS NOT LESS THAN 12" BELOW FINISHED GRADE AT ALL EXISTING TRAFFIC SIGNAL EQUIPMENT LOCATIONS.
 3. TEMPORARY SIGNALS AND LIGHTING SHALL BE INSTALLED AND OPERATIONAL PRIOR TO REMOVING THE EXISTING EQUIPMENT.
 4. EXISTING CALLOUTS SHOWN FOR INFORMATION ONLY TO BETTER IDENTIFY CONFLICTS.

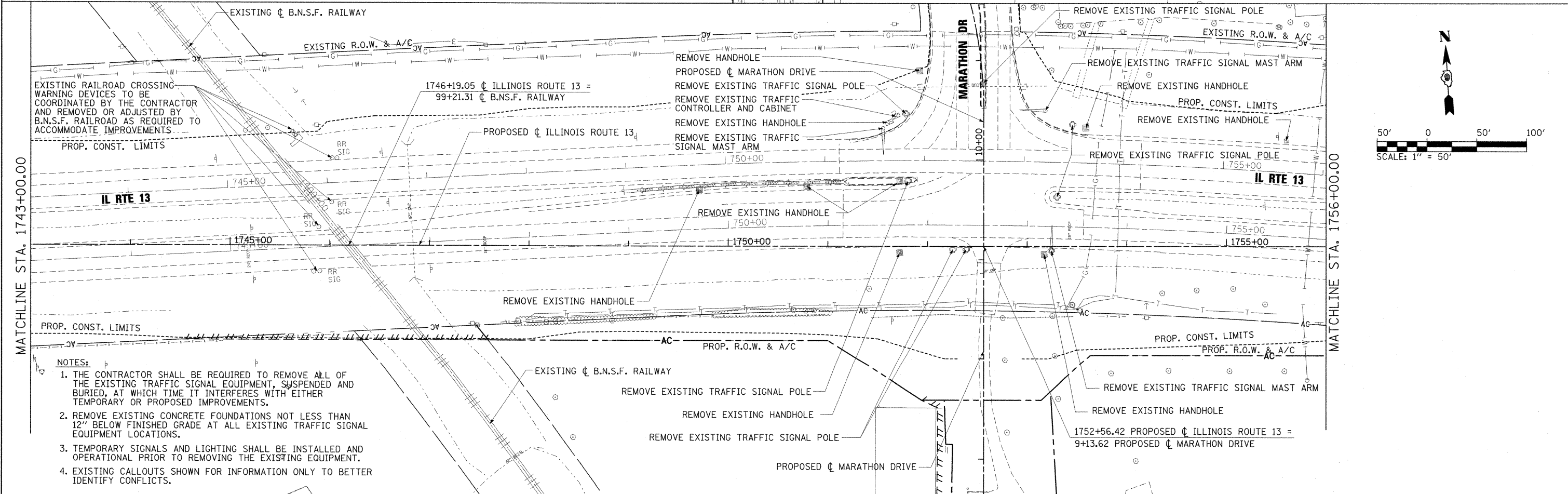

- NOTES:**
1. THE CONTRACTOR SHALL BE REQUIRED TO REMOVE ALL OF THE EXISTING TRAFFIC SIGNAL EQUIPMENT, SUSPENDED AND BURIED, AT WHICH TIME IT INTERFERES WITH EITHER TEMPORARY OR PROPOSED IMPROVEMENTS.
 2. REMOVE EXISTING CONCRETE FOUNDATIONS NOT LESS THAN 12" BELOW FINISHED GRADE AT ALL EXISTING TRAFFIC SIGNAL EQUIPMENT LOCATIONS.
 3. TEMPORARY SIGNALS AND LIGHTING SHALL BE INSTALLED AND OPERATIONAL PRIOR TO REMOVING THE EXISTING EQUIPMENT.
 4. EXISTING CALLOUTS SHOWN FOR INFORMATION ONLY TO BETTER IDENTIFY CONFLICTS.

FILE NAME =	USER NAME = Gary Davis	DESIGNED - KPF	REVISED -	STATE OF ILLINOIS DEPARTMENT OF TRANSPORTATION	EXISTING TRAFFIC SIGNAL REMOVAL PLAN ILLINOIS ROUTE 13	F.A. RTE.	SECTION	COUNTY	TOTAL SHEETS	SHEET NO.	
1:\dot\0986603\draw\cadd\sheet\099885\sh-t-sig-rem001.dgn		DRAWN - GLD	REVISED -			331	(1X-1) VB-1, B-1, N-4, R-3	WILLIAMSON	367	125	
PLOT SCALE = 50,0000' / IN.		CHECKED - SPH	REVISED -			SCALE: 1" = 50'		SHEET NO. OF SHEETS		STA. 1729+37.13 TO STA. 1756+00.00	
PLOT DATE = 12/9/2011		DATE - 12/9/11	REVISED -			CONTRACT NO. 98859 ILLINOIS FED. AID PROJECT					