

EXISTING  $\phi$  SKYLINE DR. (SOUTH)

PR RADIUS  
30'

PR RADIUS POINTS  
 (A) STA. 5+77.55, 18.00' RT.  
 (B) STA. 6+07.55, 48.00' RT.

STA. 460+81.67 PROP.  $\phi$  FRONTAGE RD. =  
 STA. 6+20.29 EXIST.  $\phi$  SKYLINE DR.  
 SOUTH

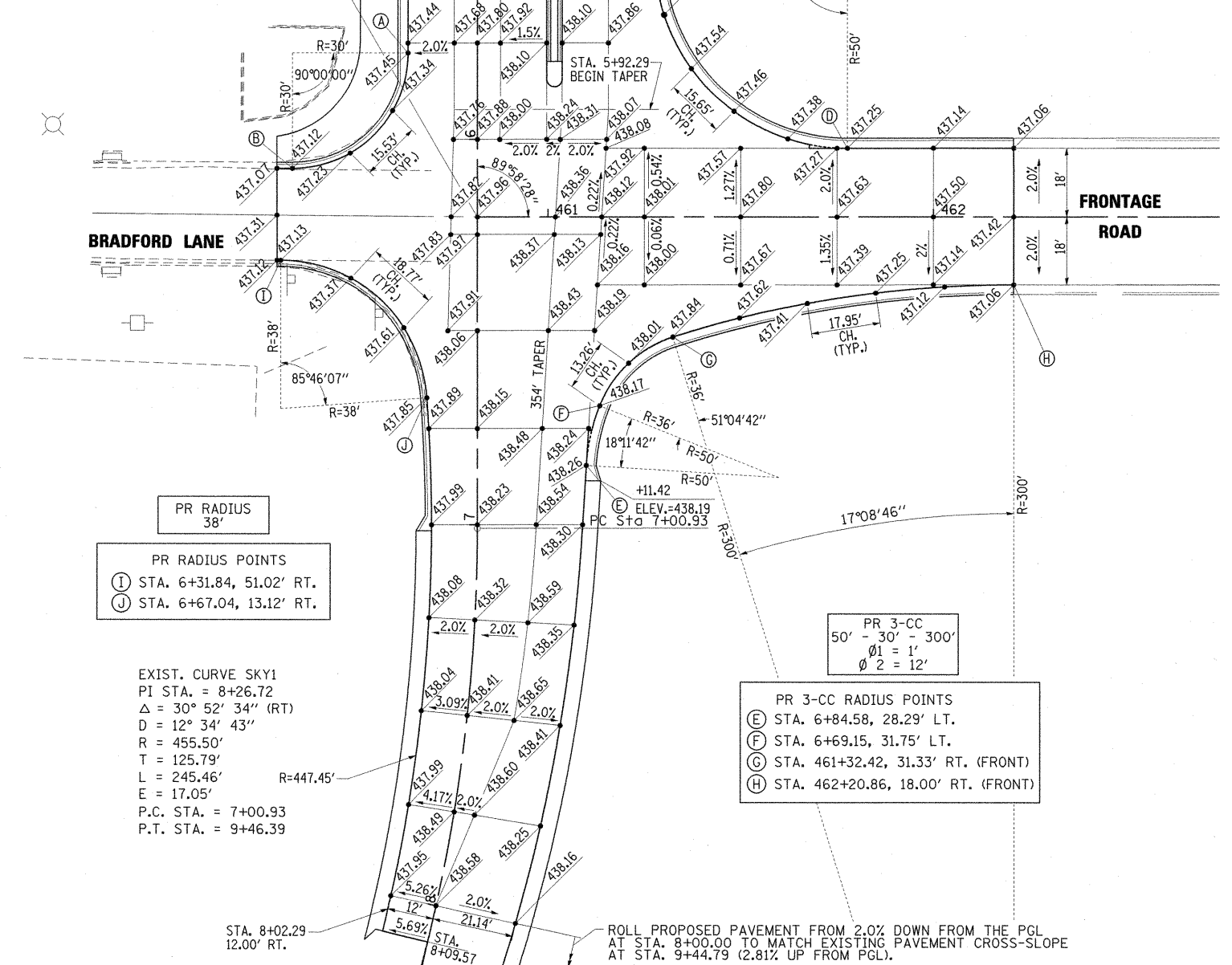

PR RADIUS  
38'

PR RADIUS POINTS  
 (I) STA. 6+31.84, 51.02' RT.  
 (J) STA. 6+67.04, 13.12' RT.

EXIST. CURVE SKY1  
 PI STA. = 8+26.72  
 $\Delta$  = 30° 52' 34" (RT)  
 D = 12° 34' 43"  
 R = 455.50'  
 T = 125.79'  
 L = 245.46'  
 E = 17.05'  
 P.C. STA. = 7+00.93  
 P.T. STA. = 9+46.39

STA. 8+02.29  
 12.00' RT.

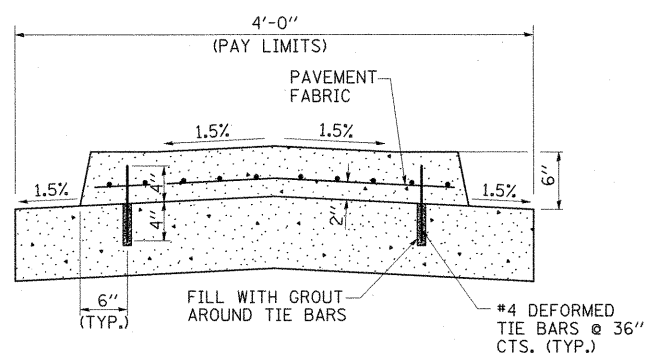

SECTION A-A

PR RADIUS  
50'

PR RADIUS POINTS  
 (C) STA. 5+52.25, 46.00' LT.  
 (D) STA. 461+77.70, 18.00' LT. (FRONT)

PR 3-CC  
 50' - 30' - 300'  
 $\phi 1 = 1'$   
 $\phi 2 = 12'$

PR 3-CC RADIUS POINTS  
 (E) STA. 6+84.58, 28.29' LT.  
 (F) STA. 6+69.15, 31.75' LT.  
 (G) STA. 461+32.42, 31.33' RT. (FRONT)  
 (H) STA. 462+20.86, 18.00' RT. (FRONT)

ROLL PROPOSED PAVEMENT FROM 2.0% DOWN FROM THE PGL  
 AT STA. 8+00.00 TO MATCH EXISTING PAVEMENT CROSS-SLOPE  
 AT STA. 9+44.79 (2.81% UP FROM PGL).

FILE NAME =	USER NAME = OpenH&B Springfield	DESIGNED - BMB	REVISED -
I:\dot\0906603\draw\codd_sheets\099805	0-shd-intersec004.dgn	DRAWN - GLD	REVISED -
	PLOT SCALE = 20.0000' / IN.	CHECKED - SPH	REVISED -
	PLOT DATE = 12/12/2011	DATE - 12/9/11	REVISED -

STATE OF ILLINOIS  
 DEPARTMENT OF TRANSPORTATION

INTERSECTION DETAIL  
 FRONTAGE ROAD - SKYLINE DR. AND MARATHON DR.

SCALE: 1" = 20' SHEET NO. OF SHEETS STA. TO STA.

F.A. RTE.	SECTION	COUNTY	TOTAL SHEETS	SHEET NO.
331	(1X-1) VB-1, B-1, N-4, R-3	WILLIAMSON	367	130
			CONTRACT NO. 98859	
ILLINOIS FED. AID PROJECT				