

TRANSVERSE CONTRACTION JOINT SPACING SHOWN IS ALONG THE EXISTING ϕ OF SKYLINE DRIVE

NOTES:
SEE STANDARDS 420001, 420101, 420106, 483001, 606001, 606301 FOR ADDITIONAL DETAILS.

LEGEND	
	PROPOSED 2" TRANSVERSE EXPANSION JOINT (DOWELED)
	PROPOSED TRANSVERSE CONTRACTION JOINT (DOWELED)
	PROPOSED LONGITUDINAL TIED JOINT WITH NO. 6 BARS
	LONGITUDINAL KEYED JOINT
	PAVEMENT FABRIC (STD. 420701)
	PCC SHOULDER (STD. 483001)

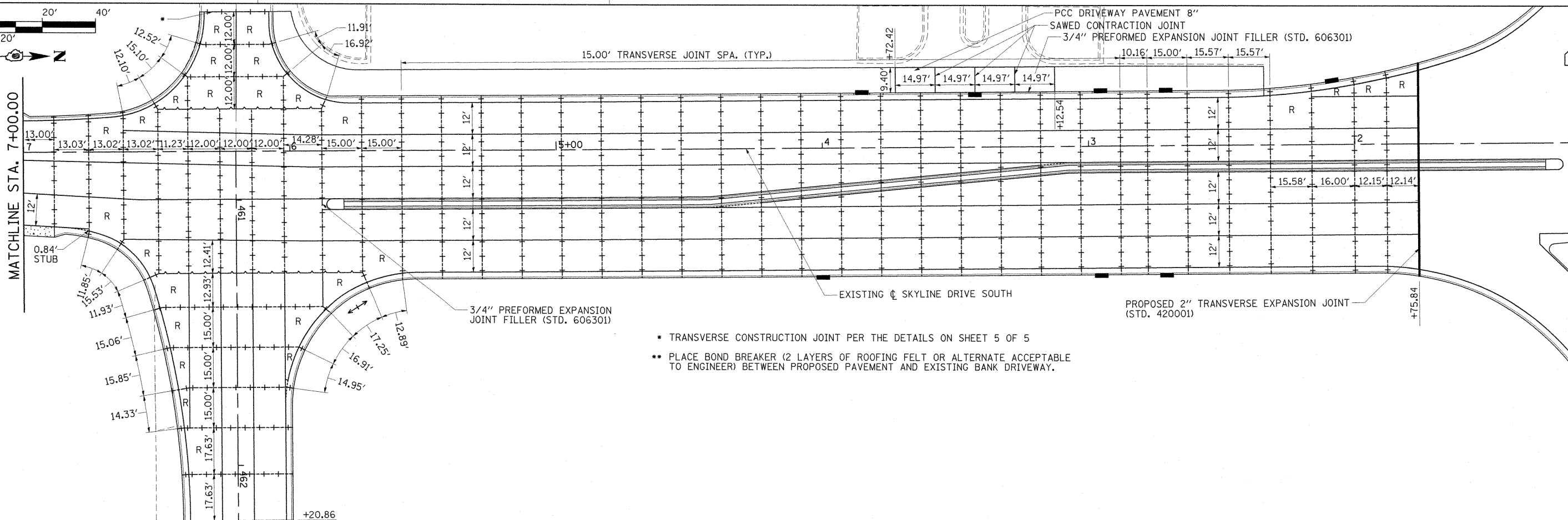
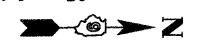
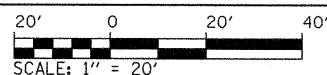

- TRANSVERSE CONSTRUCTION JOINT PER THE DETAILS ON SHEET 5 OF 5
- PLACE BOND BREAKER (2 LAYERS OF ROOFING FELT OR ALTERNATE ACCEPTABLE TO ENGINEER) BETWEEN PROPOSED PAVEMENT AND EXISTING BANK DRIVEWAY.

FILE NAME =	USER NAME = OpenH&B Springfield	DESIGNED - BMB / KPF	REVISED -	STATE OF ILLINOIS DEPARTMENT OF TRANSPORTATION	JOINTING PLAN SKYLINE DRIVE	F.A. RTE.	SECTION	COUNTY	TOTAL SHEETS	SHEET NO.	
1:\dot\0906603\draw\cadd\sheets\099885	shht-joining004.dgn	DRAWN - TAP	REVISED -			331	(1X-1) VB-1, B-1, N-4, R-3	WILLIAMSON	367	134	
	PLOT SCALE = 20.0000' / IN.	CHECKED - SPH	REVISED -			CONTRACT NO. 98859					
	PLOT DATE = 12/12/2011	DATE - 12/9/11	REVISED -			ILLINOIS FED. AID PROJECT					