

LEGEND

- PROPOSED PVC CONDUIT
- PROPOSED DETECTOR LOOPS
- PROPOSED CONCRETE HANDHOLE
- PROPOSED TRAFFIC SIGNAL CONTROLLER
- PROPOSED BRACKET MOUNTED SIGNAL HEAD
- PROPOSED COMBINATION MAST ARM AND POLE WITH MAST ARM AND BRACKET MOUNTED SIGNAL HEADS
- SIZE OF UNDERGROUND CONDUIT
- SERVICE INSTALLATION/TRANSFORMER
- GULFBOX JUNCTION
- LIGHTING CONTROLLER
- UNINTERRUPTIBLE POWER SUPPLY

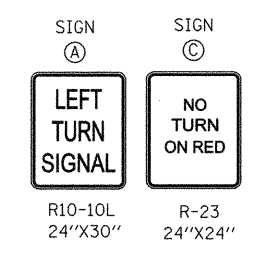
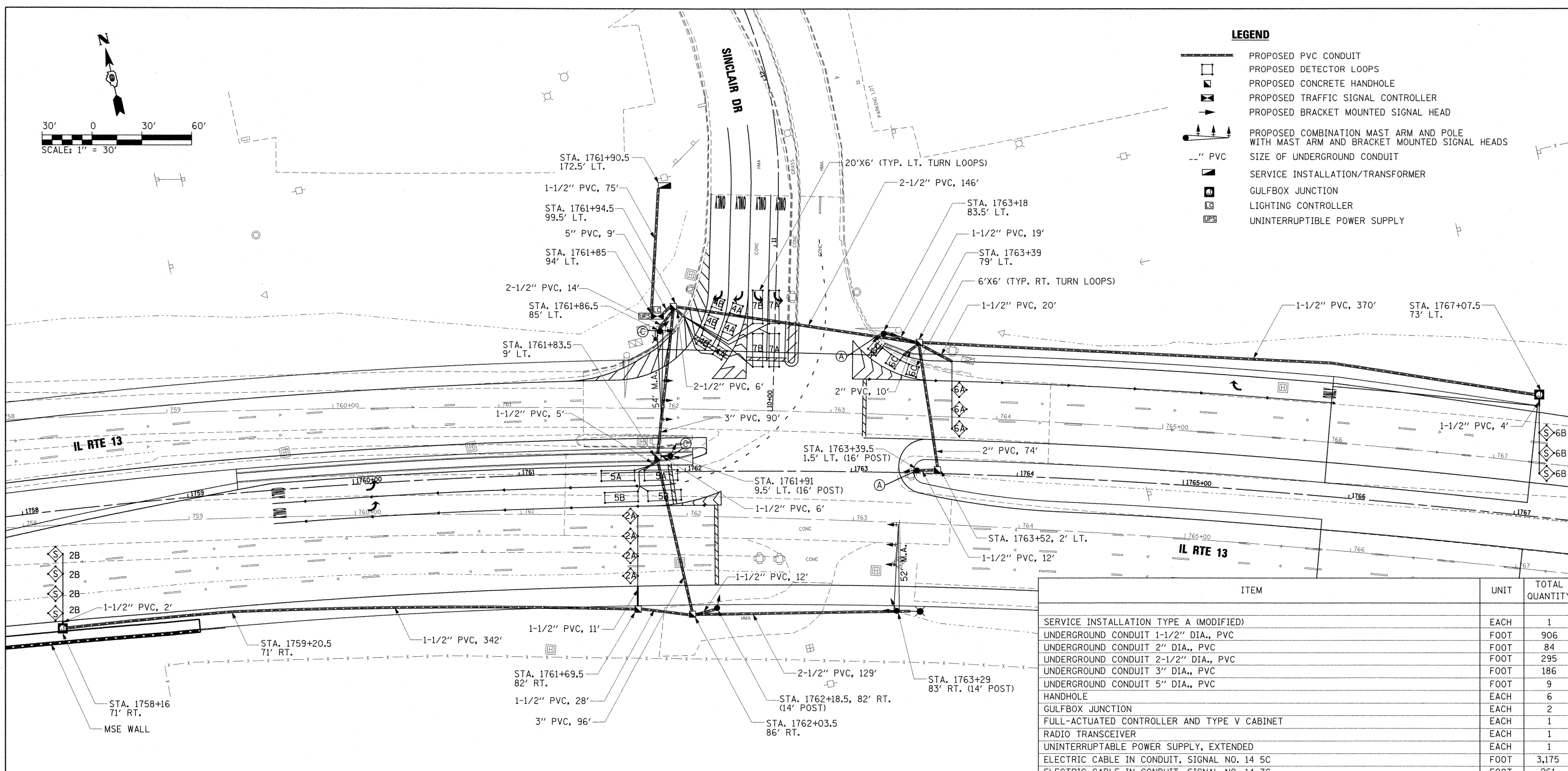

ITEM	UNIT	TOTAL QUANTITY
SERVICE INSTALLATION TYPE A (MODIFIED)	EACH	1
UNDERGROUND CONDUIT 1-1/2" DIA., PVC	FOOT	906
UNDERGROUND CONDUIT 2" DIA., PVC	FOOT	84
UNDERGROUND CONDUIT 2-1/2" DIA., PVC	FOOT	295
UNDERGROUND CONDUIT 3" DIA., PVC	FOOT	186
UNDERGROUND CONDUIT 5" DIA., PVC	FOOT	9
HANDHOLE	EACH	6
GULFBOX JUNCTION	EACH	2
FULL-ACTUATED CONTROLLER AND TYPE V CABINET	EACH	1
RADIO TRANSCEIVER	EACH	1
UNINTERRUPTIBLE POWER SUPPLY, EXTENDED	EACH	1
ELECTRIC CABLE IN CONDUIT, SIGNAL NO. 14 5C	FOOT	3,175
ELECTRIC CABLE IN CONDUIT, SIGNAL NO. 14 7C	FOOT	261
ELECTRIC CABLE IN CONDUIT, LEAD-IN, NO. 14 1 PAIR	FOOT	2,080
ELECTRIC CABLE IN CONDUIT, SERVICE NO. 6 3C	FOOT	81
TRAFFIC SIGNAL POST, ALUMINUM, 14 FT.	EACH	2
TRAFFIC SIGNAL POST, ALUMINUM, 16 FT.	EACH	2
STEEL COMBINATION MAST ARM ASSEMBLY AND POLE, 52 FT.	EACH	1
STEEL COMBINATION MAST ARM ASSEMBLY AND POLE, 54 FT.	EACH	1
CONCRETE FOUNDATION, TYPE A	FOOT	12
CONCRETE FOUNDATION, TYPE C	FOOT	3
CONCRETE FOUNDATION, TYPE E 36-INCH DIAMETER	FOOT	30
SIGNAL HEAD, POLYCARBONATE, LED, 1-FACE, 3-SECTION, BRACKET MOUNTED	EACH	3
SIGNAL HEAD, POLYCARBONATE, LED, 1-FACE, 3-SECTION, MAST ARM MOUNTED	EACH	6
SIGNAL HEAD, POLYCARBONATE, LED, 2-FACE, 3-SECTION, BRACKET MOUNTED	EACH	1
SIGNAL HEAD, POLYCARBONATE, LED, 2-FACE, 1-3 SECTION, 1-5 SECTION, BRACKET MOUNTED	EACH	2
TRAFFIC SIGNAL BACKPLATE	EACH	6
INDUCTIVE LOOP DETECTOR	EACH	9
INDUCTION LOOP DETECTOR AMPLIFIER WITH SYSTEM OUTPUT	EACH	2
DETECTOR LOOP, TYPE I	FOOT	1,490