

NOTES:

1. THE TEMPORARY SIGNALS MUST BE INSTALLED AND THE EXISTING SIGNALS REMOVED BEFORE THE WIDENING AT THE INTERSECTION CAN BE COMPLETED.
2. SUFFICIENT CABLE SHALL BE COILED AT THE NEAR POLE TO ALLOW MOVING SIGNAL HEADS DURING THE MULTIPLE CONSTRUCTION STAGING LOCATIONS WITHOUT ADDING NEW CABLE.
3. SIGNAL HEAD LOCATIONS SHOWN ARE BASED ON THE POLE LOCATIONS SHOWN. FINAL SIGNAL HEAD LOCATIONS SHOULD BE DETERMINED IN THE FIELD FOR EACH SUBSTAGE AND APPROVED BY DISTRICT 9.
4. TEMPORARY LIGHTING LUMINAIRES SHALL BE FED FROM CIRCUIT BREAKERS IN THE TRAFFIC SIGNAL CONTROLLER.
5. ADD GUYS AND ANCHORS AS NEEDED TO SUPPORT THE POLE AGAINST CABLE LOADS. THE COST SHALL BE INCLUDED IN THE COST OF TEMPORARY TRAFFIC SIGNAL INSTALLATION.
6. ATTACH AERIAL CABLE FOR LIGHTING AT THE TOP OF THE POLE.
7. CIRCUIT NO. 1 TO BE ENERGIZED DURING STAGE 1 OF THE CONSTRUCTION OR AS DIRECTED BY THE ENGINEER.

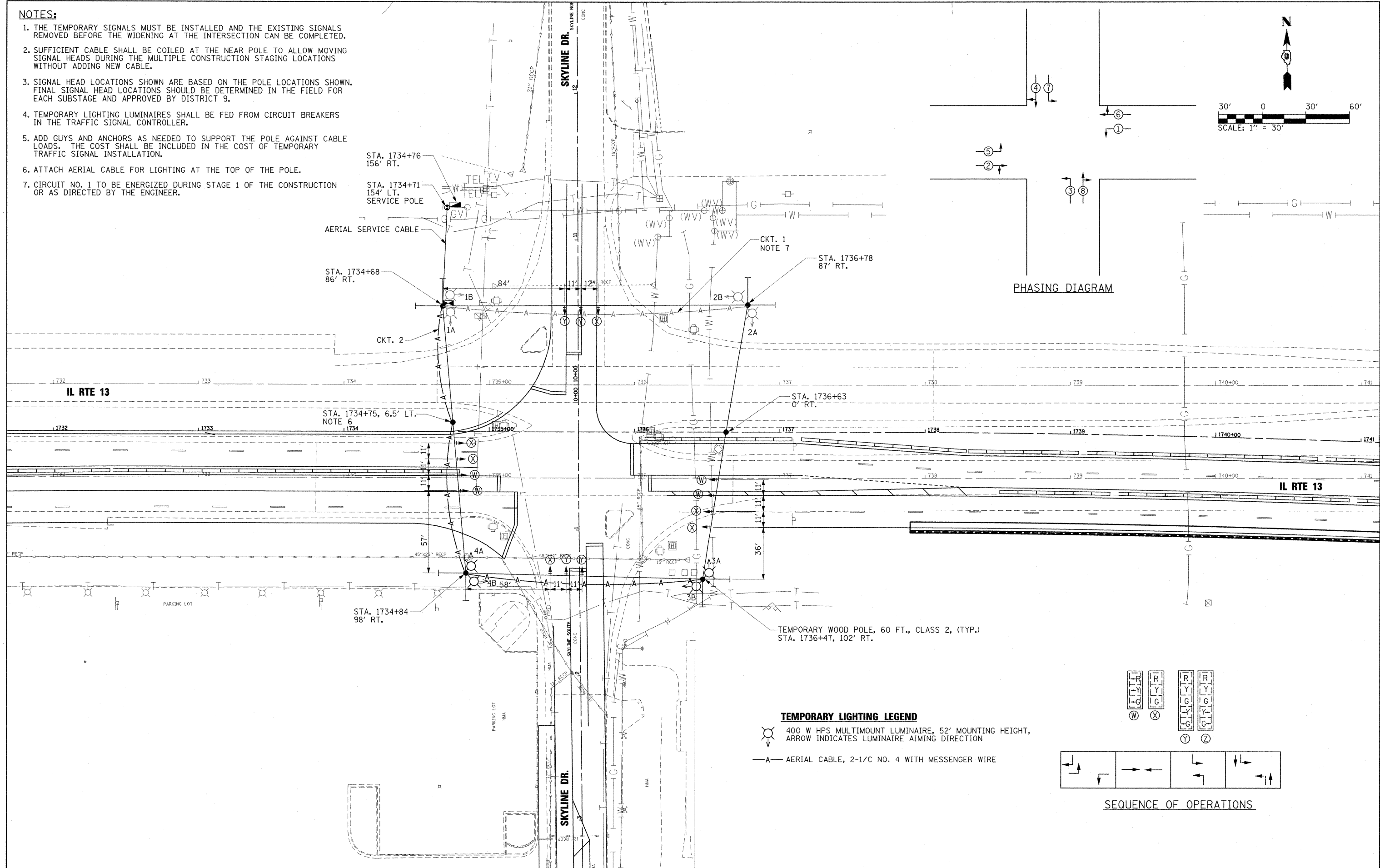
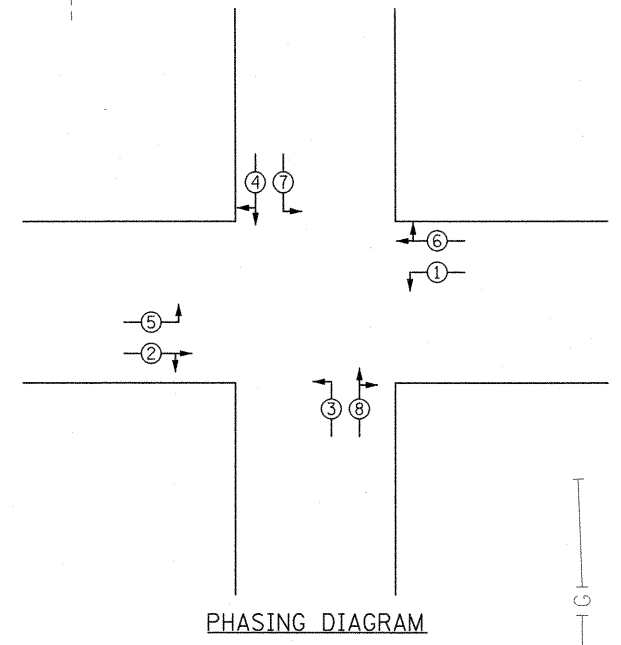
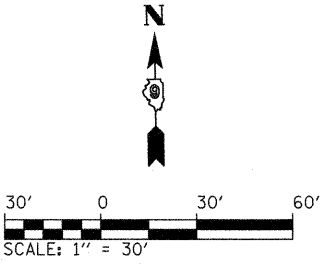

TEMPORARY LIGHTING LEGEND

400 W HPS MULTIMOUNT LUMINAIRE, 52' MOUNTING HEIGHT, ARROW INDICATES LUMINAIRE AIMING DIRECTION

AERIAL CABLE, 2-1/C NO. 4 WITH MESSENGER WIRE

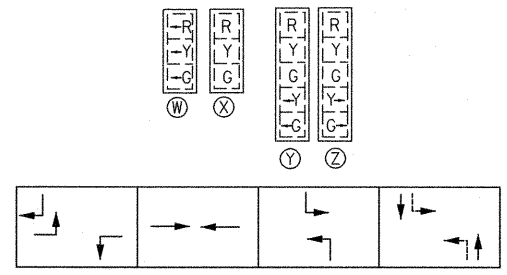

FILE NAME = I:\dot\8906603\draw\cadd\sheet\099885	USER NAME = OpenH&B Springfield	DESIGNED - IDOT CENTRAL OFFICE	REVISED -	STATE OF ILLINOIS DEPARTMENT OF TRANSPORTATION	TEMPORARY SIGNAL & LIGHTING PLAN STAGE 2 (VARIOUS SUBSTAGES) ILLINOIS ROUTE 13 AND SKYLINE DRIVE			F.A. RTE. = 331	SECTION = (1X-1) VB-1, B-1, N-4, R-3	COUNTY = WILLIAMSON	TOTAL SHEETS = 367	SHEET NO. = 157
	PLOT SCALE = 30,0000 / IN.	CHECKED - SPH	REVISED -					SCALE: 1" = 30'	SHEET NO. OF SHEETS	STA. TO STA.	CONTRACT NO. 98859	
PLOT DATE = 12/13/2011	DATE = 12/9/11	REVISI	REVISED -	ILLINOIS FED. AID PROJECT								