

NORTH EDGE OF SHOULDER

LOCATION	STATION	OFFSET (FT)	THEORETICAL GRADE ELEVATIONS
End W. Appr. Pav't.	1743+80.87	-36.000	471.392
A1	1743+90.87	-36.000	471.691
A2	1744+00.87	-36.000	471.983
Bk. W. Abut.	1744+10.87	-36.000	472.268

NORTH EDGE OF PAVEMENT

LOCATION	STATION	OFFSET (FT)	THEORETICAL GRADE ELEVATIONS
End W. Appr. Pav't.	1743+90.59	-24.000	471.933
A1	1744+00.59	-24.000	472.225
A2	1744+10.59	-24.000	472.510
Bk. W. Abut.	1744+20.59	-24.000	472.787

EDGE OF PAVEMENT & SLOPE CHANGE

LOCATION	STATION	OFFSET (FT)	THEORETICAL GRADE ELEVATIONS
End W. Appr. Pav't.	1744+00.30	-12.000	472.467
A1	1744+10.30	-12.000	472.752
A2	1744+20.30	-12.000	473.030
Bk. W. Abut.	1744+30.30	-12.000	473.300

℄ ROADWAY & P.G.L.

LOCATION	STATION	OFFSET (FT)	THEORETICAL GRADE ELEVATIONS
End W. Appr. Pav't.	1744+10.02	0.000	472.932
A1	1744+20.02	0.000	473.209
A2	1744+30.02	0.000	473.480
Bk. W. Abut.	1744+40.02	0.000	473.300

SOUTH EDGE OF PAVEMENT

LOCATION	STATION	OFFSET (FT)	THEORETICAL GRADE ELEVATIONS
End W. Appr. Pav't.	1744+19.74	12.000	473.014
A1	1744+29.74	12.000	473.285
A2	1744+39.74	12.000	473.548
Bk. W. Abut.	1744+49.74	12.000	473.804

SOUTH EDGE OF SHOULDER

LOCATION	STATION	OFFSET (FT)	THEORETICAL GRADE ELEVATIONS
End W. Appr. Pav't.	1744+24.60	18.000	473.022
A1	1744+34.60	18.000	473.289
A2	1744+44.60	18.000	473.549
Bk. W. Abut.	1744+54.60	18.000	473.801

NORTH EDGE OF SHOULDER

LOCATION	STATION	OFFSET (FT)	THEORETICAL GRADE ELEVATIONS
Bk. E. Abut.	1747+16.87	-36.000	477.437
A3	1747+26.87	-36.000	477.490
A4	1747+36.87	-36.000	477.535
End E. Appr. Pav't.	1747+46.87	-36.000	477.573

NORTH EDGE OF PAVEMENT

LOCATION	STATION	OFFSET (FT)	THEORETICAL GRADE ELEVATIONS
Bk. E. Abut.	1747+26.59	-24.000	477.738
A3	1747+36.59	-24.000	477.784
A4	1747+46.59	-24.000	477.822
End E. Appr. Pav't.	1747+56.59	-24.000	477.853

EDGE OF PAVEMENT & SLOPE CHANGE

LOCATION	STATION	OFFSET (FT)	THEORETICAL GRADE ELEVATIONS
Bk. E. Abut.	1747+36.30	-12.000	478.033
A3	1747+46.30	-12.000	478.071
A4	1747+56.30	-12.000	478.102
End E. Appr. Pav't.	1747+66.30	-12.000	478.126

℄ ROADWAY & P.G.L.

LOCATION	STATION	OFFSET (FT)	THEORETICAL GRADE ELEVATIONS
Bk. E. Abut.	1747+46.02	0.000	478.257
A3	1747+56.02	0.000	478.289
A4	1747+66.02	0.000	478.312
End E. Appr. Pav't.	1747+76.02	0.000	478.329

SOUTH EDGE OF PAVEMENT

LOCATION	STATION	OFFSET (FT)	THEORETICAL GRADE ELEVATIONS
Bk. E. Abut.	1747+55.74	12.000	478.100
A3	1747+65.74	12.000	478.124
A4	1747+75.74	12.000	478.141
End E. Appr. Pav't.	1747+85.74	12.000	478.151

SOUTH EDGE OF SHOULDER

LOCATION	STATION	OFFSET (FT)	THEORETICAL GRADE ELEVATIONS
Bk. E. Abut.	1747+60.60	18.000	477.988
A3	1747+70.60	18.000	478.008
A4	1747+80.60	18.000	478.022
End E. Appr. Pav't.	1747+90.60	18.000	478.027

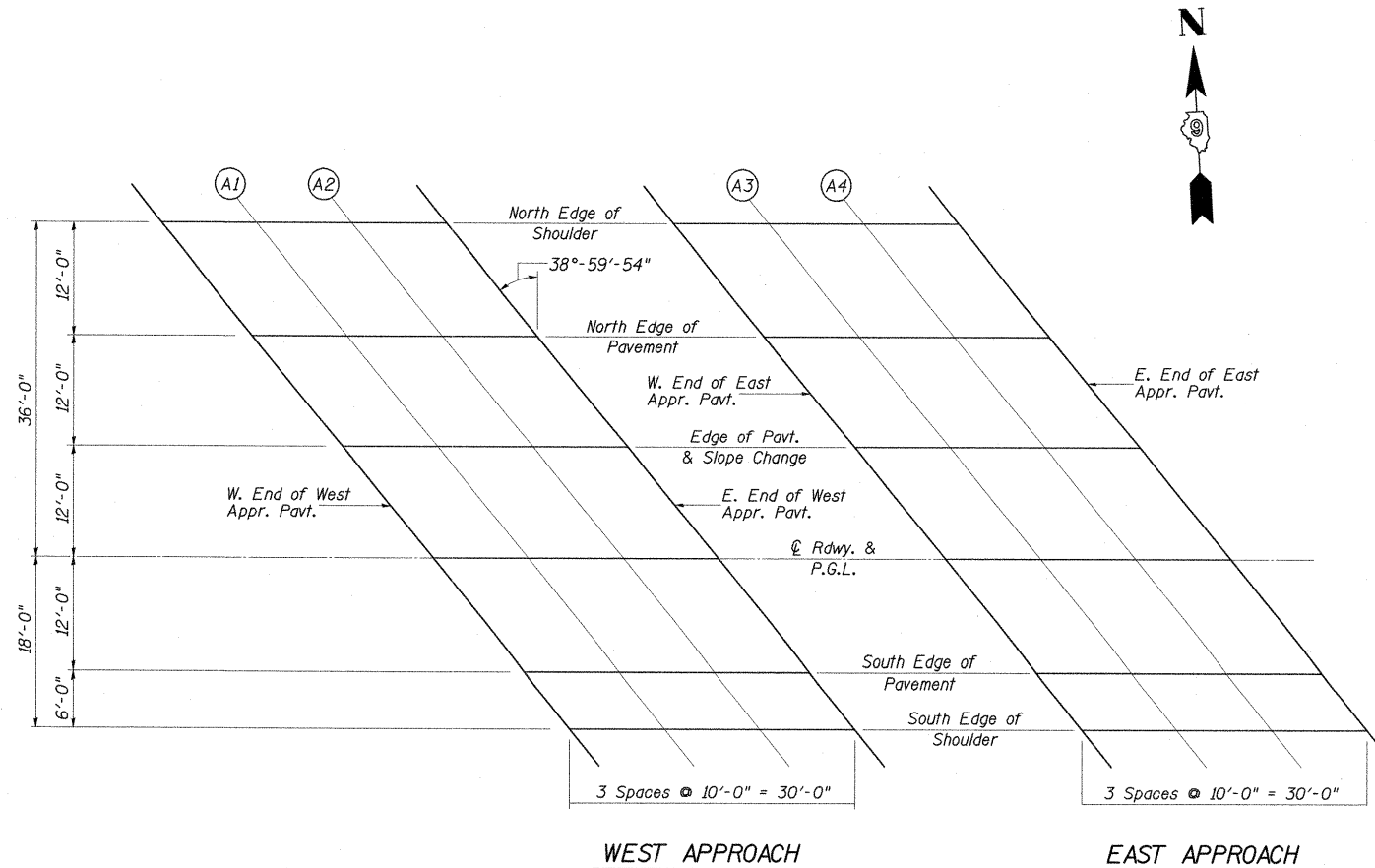

PLAN
(S.N.100-0093)

NOTE:

All offsets from W.B. P.G.L.

FILE NAME = J:\data\090603\draw\cadd\sheet\structural\plans\brsf - bridge\APPROACH SLAB ELEV.S.dgn

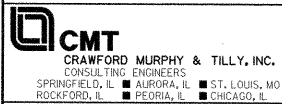

USER NAME = Gary Davis	DESIGNED - MCC	REVISED -
	CHECKED - ATI	REVISED -
PLOT SCALE =	DRAWN - GLD	REVISED -
PLOT DATE = 12/7/2011	CHECKED - ATI	REVISED -

STATE OF ILLINOIS
DEPARTMENT OF TRANSPORTATION

APPROACH SLAB ELEVATIONS
STRUCTURE NO. 100-0093 (W.B.)

SHEET NO. 5-11 OF 5-41 SHEETS

F.A.P. RTE.	SECTION	COUNTY	TOTAL SHEETS	SHEET NO.
331	(IX-1)VB-1	WILLIAMSON	367	177
			CONTRACT NO. 98859	

ILLINOIS FED. AID PROJECT