

NORTH EDGE OF SHOULDER

LOCATION	STATION	*OFFSET	THEORETICAL GRADE ELEVATION
W. End of W. Appr.	1751+77.71	-36.00	472.24
A1	1751+87.71	-36.00	471.96
A2	1751+97.71	-36.00	471.68
E. End of W. Appr.	1752+07.71	-36.00	471.40

NORTH EDGE OF PAVEMENT

LOCATION	STATION	*OFFSET	THEORETICAL GRADE ELEVATION
W. End of W. Appr.	1751+77.71	-24.00	472.49
A1	1751+87.71	-24.00	472.21
A2	1751+97.71	-24.00	471.93
E. End of W. Appr.	1752+07.71	-24.00	471.65

EDGE OF PAVEMENT & SLOPE CHANGE

LOCATION	STATION	*OFFSET	THEORETICAL GRADE ELEVATION
W. End of W. Appr.	1751+77.71	-12.00	472.74
A1	1751+87.71	-12.00	472.46
A2	1751+97.71	-12.00	472.18
E. End of W. Appr.	1752+07.71	-12.00	471.90

☉ ROADWAY & P.G.L.

LOCATION	STATION	*OFFSET	THEORETICAL GRADE ELEVATION
W. End of W. Appr.	1751+77.71	0.00	472.93
A1	1751+87.71	0.00	472.65
A2	1751+97.71	0.00	472.37
E. End of W. Appr.	1752+07.71	0.00	472.09

SOUTH EDGE OF PAVEMENT

LOCATION	STATION	*OFFSET	THEORETICAL GRADE ELEVATION
W. End of W. Appr.	1751+77.71	12.00	472.74
A1	1751+87.71	12.00	472.46
A2	1751+97.71	12.00	472.18
E. End of W. Appr.	1752+07.71	12.00	471.90

SOUTH EDGE OF SHOULDER

LOCATION	STATION	*OFFSET	THEORETICAL GRADE ELEVATION
W. End of W. Appr.	1751+77.71	18.00	472.62
A1	1751+87.71	18.00	472.34
A2	1751+97.71	18.00	472.06
E. End of W. Appr.	1752+07.71	18.00	471.78

* Offsets from W.B. P.G.L.

NORTH EDGE OF SHOULDER

LOCATION	STATION	*OFFSET	THEORETICAL GRADE ELEVATION
W. End of E. Appr.	1753+07.71	-36.00	468.60
A3	1753+17.71	-36.00	468.32
A4	1753+27.71	-36.00	468.04
E. End of E. Appr.	1753+37.71	-36.00	467.76

NORTH EDGE OF PAVEMENT

LOCATION	STATION	*OFFSET	THEORETICAL GRADE ELEVATION
W. End of E. Appr.	1753+07.71	-24.00	468.85
A3	1753+17.71	-24.00	468.57
A4	1753+27.71	-24.00	468.29
E. End of E. Appr.	1753+37.71	-24.00	468.01

EDGE OF PAVEMENT & SLOPE CHANGE

LOCATION	STATION	*OFFSET	THEORETICAL GRADE ELEVATION
W. End of E. Appr.	1753+07.71	-12.00	469.10
A3	1753+17.71	-12.00	468.82
A4	1753+27.71	-12.00	468.54
E. End of E. Appr.	1753+37.71	-12.00	468.26

☉ ROADWAY & P.G.L.

LOCATION	STATION	*OFFSET	THEORETICAL GRADE ELEVATION
W. End of E. Appr.	1753+07.71	0.00	469.29
A3	1753+17.71	0.00	469.01
A4	1753+27.71	0.00	468.73
E. End of E. Appr.	1753+37.71	0.00	468.45

SOUTH EDGE OF PAVEMENT

LOCATION	STATION	*OFFSET	THEORETICAL GRADE ELEVATION
W. End of E. Appr.	1753+07.71	12.00	469.10
A3	1753+17.71	12.00	468.82
A4	1753+27.71	12.00	468.54
E. End of E. Appr.	1753+37.71	12.00	468.26

SOUTH EDGE OF SHOULDER

LOCATION	STATION	*OFFSET	THEORETICAL GRADE ELEVATION
W. End of E. Appr.	1753+07.71	18.00	468.98
A3	1753+17.71	18.00	468.70
A4	1753+27.71	18.00	468.42
E. End of E. Appr.	1753+37.71	18.00	468.14

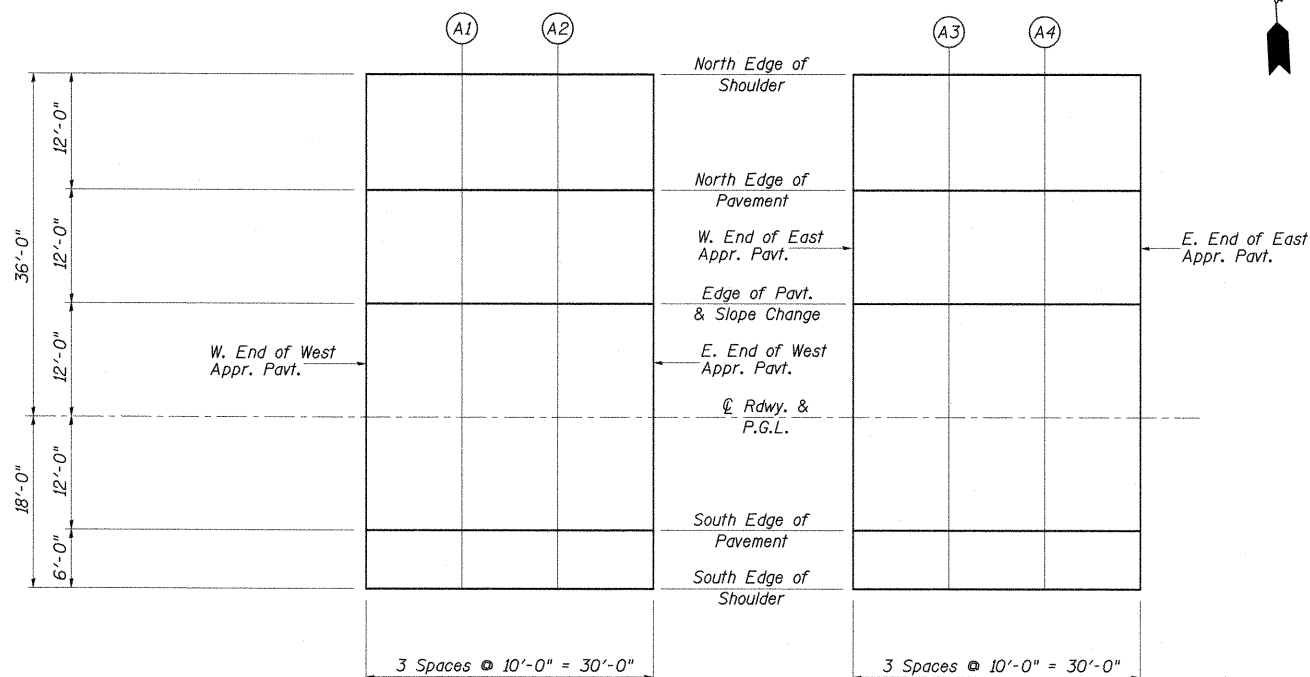

WEST APPROACH

EAST APPROACH

PLAN
(S.N.100-0095)

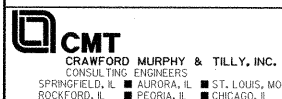

FILE NAME =	USER NAME =
I:\dot\0906603\draw\cadd\sheet\structure\el\plans\mapprod\wlb\avmt_elevs_1.dgn	
PLOT SCALE =	
PLOT DATE =	

DESIGNED - SF	REVISED -
CHECKED - WLB	REVISED -
DRAWN - GLD	REVISED -
CHECKED - SF	REVISED -

STATE OF ILLINOIS
DEPARTMENT OF TRANSPORTATION

APPROACH PAVEMENT ELEVATIONS 1
STRUCTURE NO. 100-0095 (W.B.)

SHEET NO. 9 OF 32 SHEETS

F.A.P. RTE.	SECTION	COUNTY	TOTAL SHEETS	SHEET NO.
331	(1X-1) VB-1, B-1, N-4, R-3	WILLIAMSON	367	216
CONTRACT NO. 98859			ILLINOIS FED. AID PROJECT	