

170 160 150 140 130 120 110 100 90 80 70 60 50 40 30 20 10 0 10 20 30 40 50 60 70 80 90 100 110 120 130

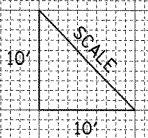

FINAL SURVEY	DATE
SURVEYED	BY
PLANNED	
NOTE BOOK	
TEMPLATE	
AREAS	
CHECKED	
NO.	

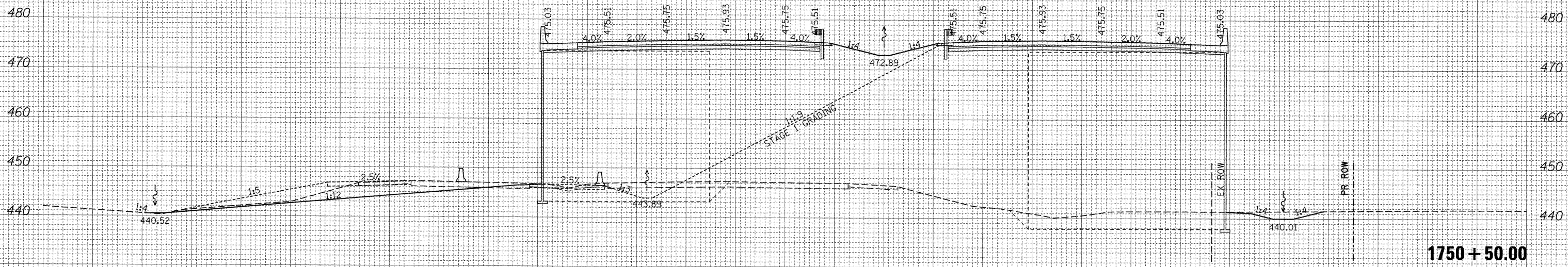

1750+50.00

STAGE 1		STAGE 2	
EXCAVATION =	171.4	255.7	SQ. FT.
EMBANKMENT =	1440.7	594.6	SQ. FT.

ORIGINAL SURVEY	DATE
DESIGNED	BY
PLANNED	
NOTE BOOK	
TEMPLATE	
AREAS	
CHECKED	
NO.	

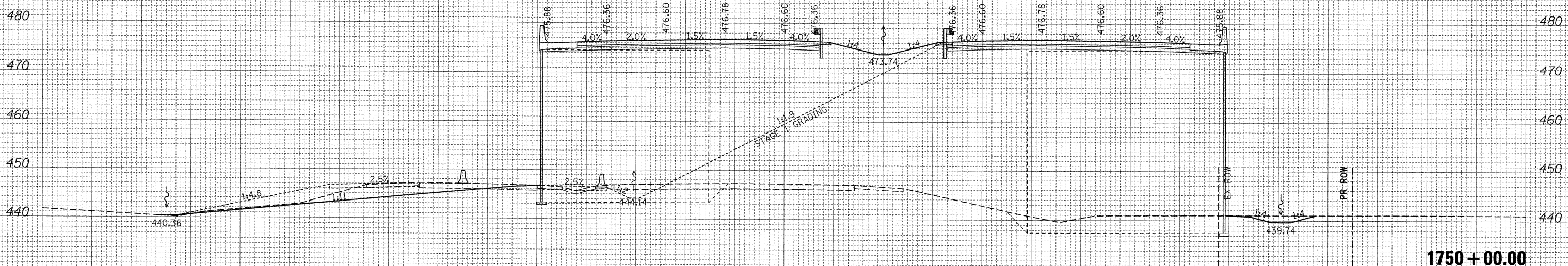

1750+00.00

STAGE 1		STAGE 2	
EXCAVATION =	161.8	283.6	SQ. FT.
EMBANKMENT =	1511.7	602.3	SQ. FT.

FILE NAME =	USER NAME = Matt Overbey	DESIGNED -	REVISOR -	STATE OF ILLINOIS DEPARTMENT OF TRANSPORTATION	PROPOSED CROSS SECTIONS IL ROUTE 13				F.A. RTE.	SECTION	COUNTY	TOTAL SHEETS	SHEET NO.
1:\dot\8906603\draw\cadd.sheets\0998859-sht-13.dgn		DRAWN -	REVISOR -		331	(1X-1) VB-1, B-1, N-4, R-3	WILLIAMSON	367	323				
	PLOT SCALE = 10.0000' / IN.	CHECKED -	REVISOR -		SCALE: SHEET NO. OF SHEETS STA. TO STA.				CONTRACT NO. 98859				
	PLOT DATE = 12/13/2011	DATE - 12/9/11	REVISOR -		ILLINOIS FED. AID PROJECT								