

FINAL SURVEY	DATE
SURVEYED	BY
TEMPERATURE	
NO. OF	
AREAS CHECKED	

ORIGINAL SURVEY	DATE
SURVEYED	BY
TEMPERATURE	
NO. OF	
AREAS CHECKED	

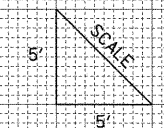
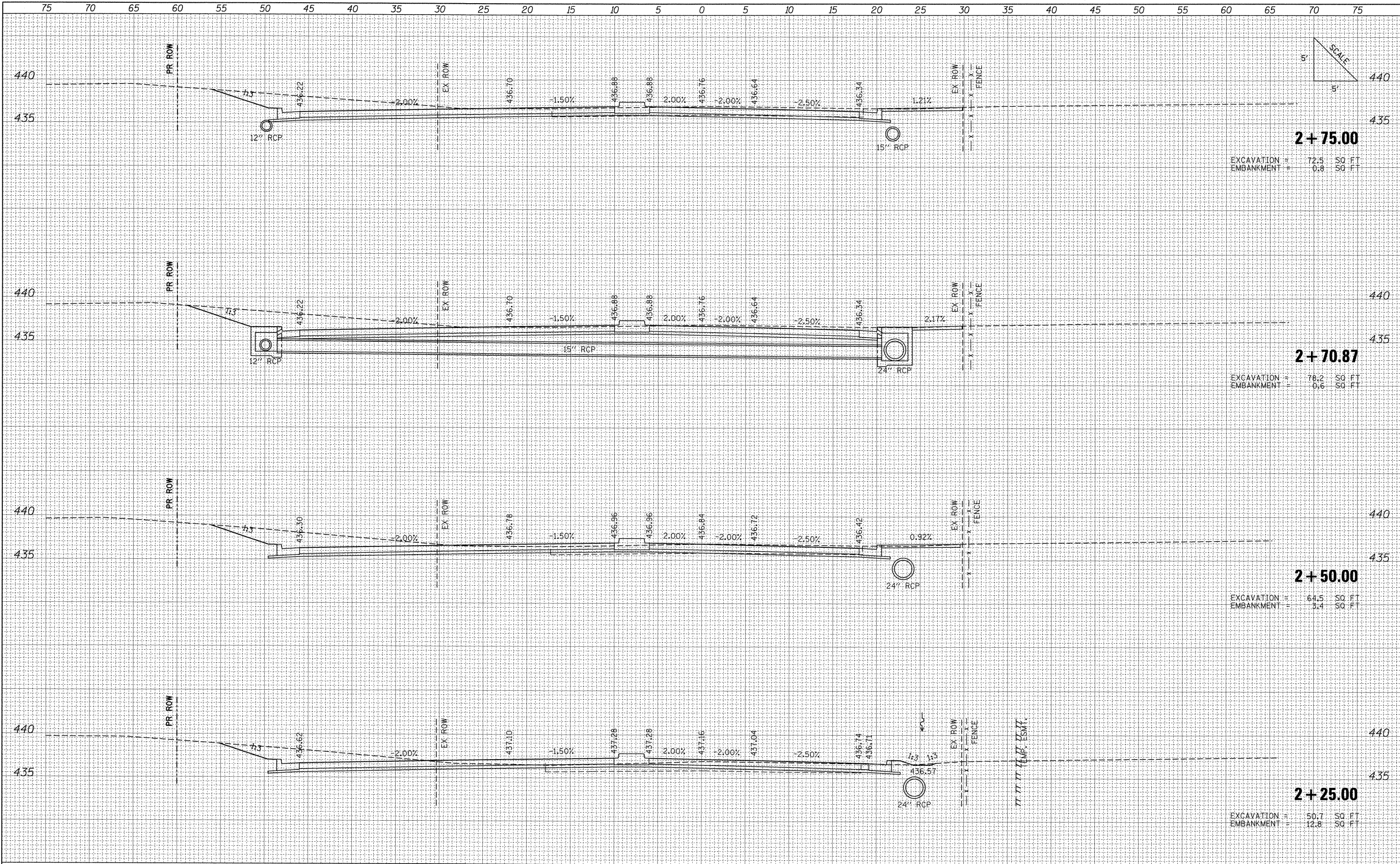

2+75.00
 EXCAVATION = 72.5 SQ FT
 EMBANKMENT = 0.8 SQ FT

2+70.87
 EXCAVATION = 76.2 SQ FT
 EMBANKMENT = 0.6 SQ FT

2+50.00
 EXCAVATION = 64.5 SQ FT
 EMBANKMENT = 3.4 SQ FT

2+25.00
 EXCAVATION = 50.7 SQ FT
 EMBANKMENT = 12.8 SQ FT

FILE NAME =	USER NAME = Matt Overbay	DESIGNED -	REVISED -	STATE OF ILLINOIS DEPARTMENT OF TRANSPORTATION	PROPOSED CROSS SECTIONS SKYLINE DRIVE SOUTH	F.A. RTE.	SECTION	COUNTY	TOTAL SHEETS	SHEET NO.	
I:\dot\0906603\draw\cadd_sheets\0998859-sht-x	SkylineSouth.dgn	DRAWN -	REVISED -			331	(1X-1) VB-1, B-1, N-4, R-3	WILLIAMSON	367	340	
	PLOT SCALE = 5.0000" / IN.	CHECKED -	REVISED -			CONTRACT NO. 98859					
	PLOT DATE = 12/13/2011	DATE - 12/9/11	REVISED -			FED. ROAD DIST. NO. ILLINOIS FED. AID PROJECT					