

DATE	
BY	
ORIGINAL SURVEY	
SURVEYED	
PLOTTED	
TEMPLATE	
NOTE BOOK	
AREAS	
CHECKED	

DATE	
BY	
ORIGINAL SURVEY	
SURVEYED	
PLOTTED	
TEMPLATE	
NOTE BOOK	
AREAS	
CHECKED	

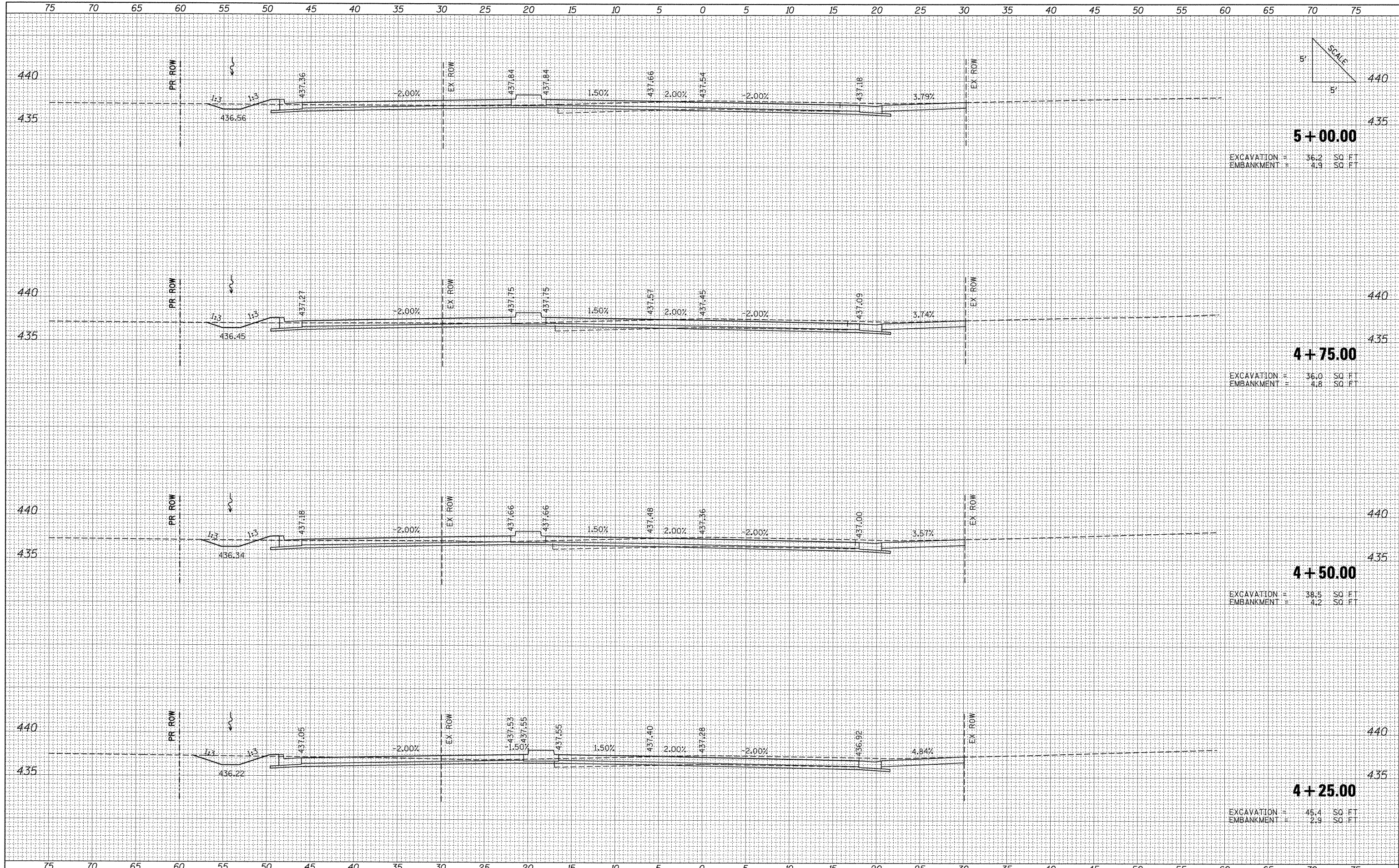

**5 + 00.00**  
 EXCAVATION = 36.2 SQ. FT.  
 EMBANKMENT = 4.9 SQ. FT.

**4 + 75.00**  
 EXCAVATION = 36.0 SQ. FT.  
 EMBANKMENT = 4.8 SQ. FT.

**4 + 50.00**  
 EXCAVATION = 38.5 SQ. FT.  
 EMBANKMENT = 4.2 SQ. FT.

**4 + 25.00**  
 EXCAVATION = 45.4 SQ. FT.  
 EMBANKMENT = 2.9 SQ. FT.

FILE NAME = L:\IDOT\906603\Draw\CADD_Sheets\0998859-sht-5\SkylineSouth.dgn	USER NAME = OpenH&B Springfield	DESIGNED -	REVISED -	<b>STATE OF ILLINOIS</b> <b>DEPARTMENT OF TRANSPORTATION</b>	<b>PROPOSED CROSS SECTIONS</b> <b>SKYLINE DRIVE SOUTH</b>		F.A. RTE. 331	SECTION (1X-1) VB-1, B-1, N-4, R-3	COUNTY WILLIAMSON	TOTAL SHEETS 367	SHEET NO. 343
PLOT SCALE = 5.0000' / IN.	PLOT DATE = 12/13/2011	DRAWN -	REVISED -		SCALE:	SHEET NO. OF SHEETS	STA. 4+25.00 TO STA. 5+00.00	FED. ROAD DIST. NO.	ILLINOIS FED. AID PROJECT	CONTRACT NO. 98859	
		CHECKED -	REVISED -								
		DATE = 12/9/11	REVISED -								