

FINAL SURVEY BY DATE  
 SURVEYED BY  
 PLOTTED BY  
 NOTE BOOK NO.  
 AREAS CHECKED

ORIGINAL SURVEY BY DATE  
 SURVEYED BY  
 PLOTTED BY  
 NOTE BOOK NO.  
 AREAS CHECKED

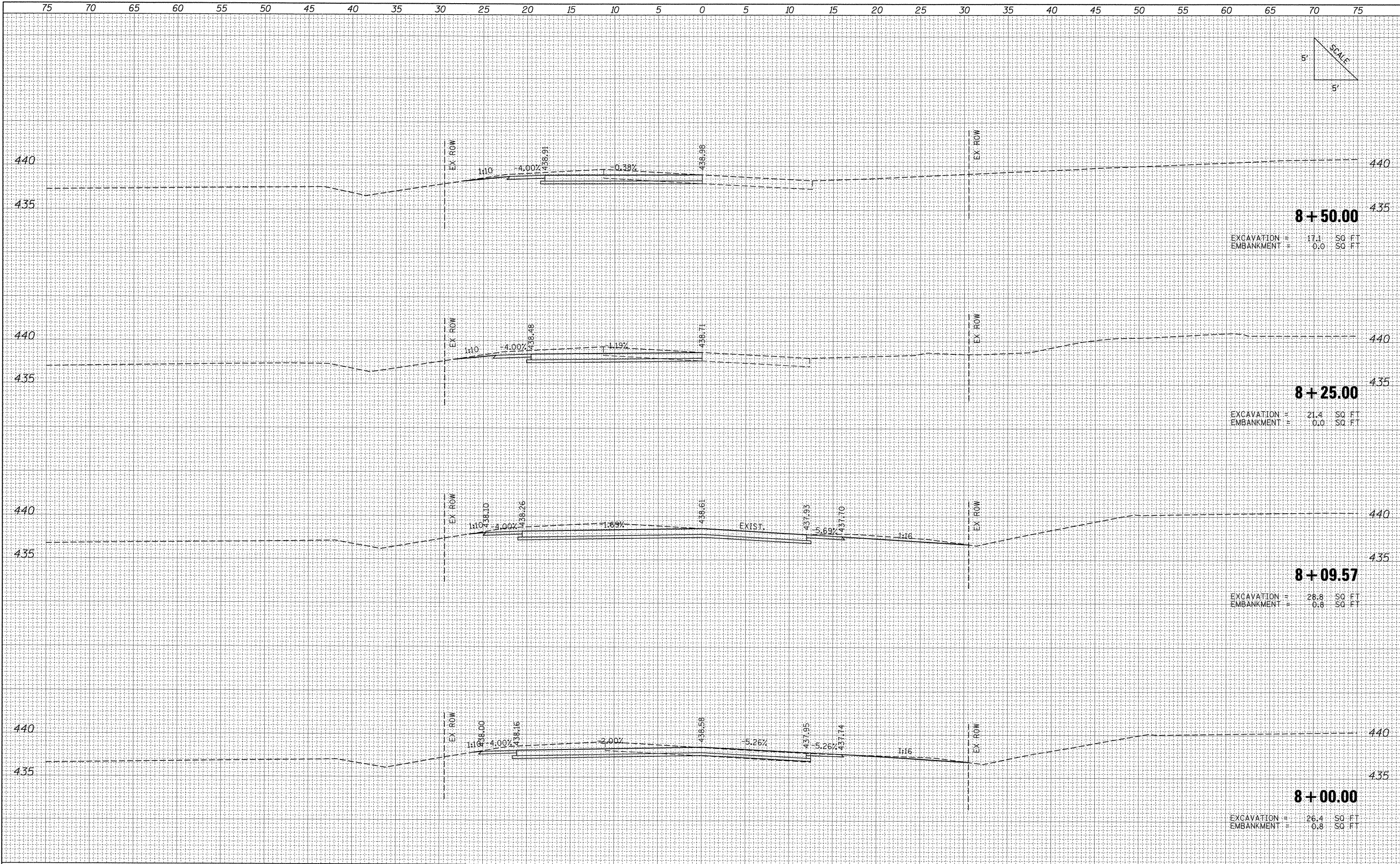

**8 + 50.00**  
 EXCAVATION = 17.1 SQ. FT.  
 EMBANKMENT = 0.0 SQ. FT.

**8 + 25.00**  
 EXCAVATION = 21.4 SQ. FT.  
 EMBANKMENT = 0.0 SQ. FT.

**8 + 09.57**  
 EXCAVATION = 26.8 SQ. FT.  
 EMBANKMENT = 0.0 SQ. FT.

**8 + 00.00**  
 EXCAVATION = 26.4 SQ. FT.  
 EMBANKMENT = 0.8 SQ. FT.

FILE NAME =	USER NAME = Most Overbey	DESIGNED -	REVISED -	<b>STATE OF ILLINOIS DEPARTMENT OF TRANSPORTATION</b>	<b>PROPOSED CROSS SECTIONS SKYLINE DRIVE SOUTH</b>			F.A. RTE.	SECTION	COUNTY	TOTAL SHEETS	SHEET NO.
I:\dot\0906603\draw\cadd_sheets\0998859-sht-3	SkylineSouthdgn	DRAWN -	REVISED -					331	(IX-1) VB-1, B-1, N-4, R-3	WILLIAMSON	367	348
	PLOT SCALE = 5.0000" / IN.	CHECKED -	REVISED -		CONTRACT NO. 98859							
	PLOT DATE = 12/13/2011	DATE - 12/9/11	REVISED -		FED. ROAD DIST. NO. ILLINOIS FED. AID PROJECT							
					SCALE:	SHEET NO.	OF SHEETS	STA. 8+00.00	TO STA. 8+50.00			