

FINAL SURVEY DATE
 SURVEYED BY
 TEMPLATE NO.
 AREAS CHECKED

ORIGINAL SURVEY DATE
 SURVEYED BY
 TEMPLATE NO.
 AREAS CHECKED

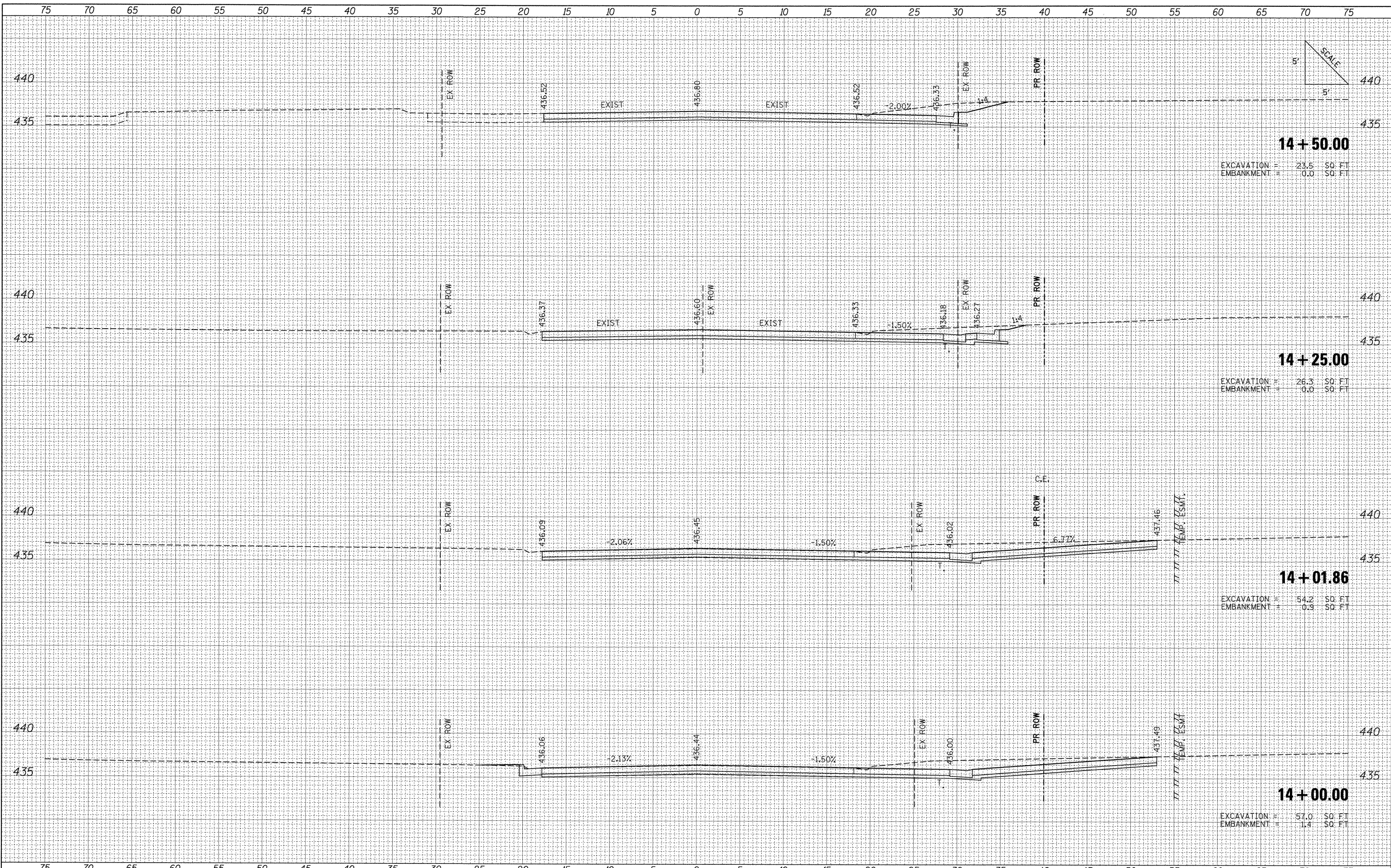

FILE NAME =	USER NAME = Matt Overbay	DESIGNED -	REVISED -	STATE OF ILLINOIS DEPARTMENT OF TRANSPORTATION	PROPOSED CROSS SECTIONS SKYLINE DRIVE NORTH		F.A. RTE.	SECTION	COUNTY	TOTAL SHEETS	SHEET NO.
I:\dot\0906603\draw\cadd_sheets\0998859-sht-3	SkylineNorth.dgn	DRAWN -	REVISED -		331	(IX-1) VB-1, B-1, N-4, R-3	WILLIAMSON	367	354		
PLOT SCALE = 5,0000 "/ IN.		CHECKED -	REVISED -		CONTRACT NO. 98859						
PLOT DATE = 12/13/2011		DATE = 12/9/11	REVISED -		FED. ROAD DIST. NO. ILLINOIS FED. AID PROJECT						
				SCALE:	SHEET NO. OF SHEETS	STA. 14+00.00 TO STA. 14+50.00					