

BY: _____ DATE: _____
 SURVEYED: _____
 FINAL SURVEY: _____
 NOTE BOOK: _____
 NO.: _____

BY: _____ DATE: _____
 SURVEYED: _____
 ORIGINAL SURVEY: _____
 NOTE BOOK: _____
 NO.: _____

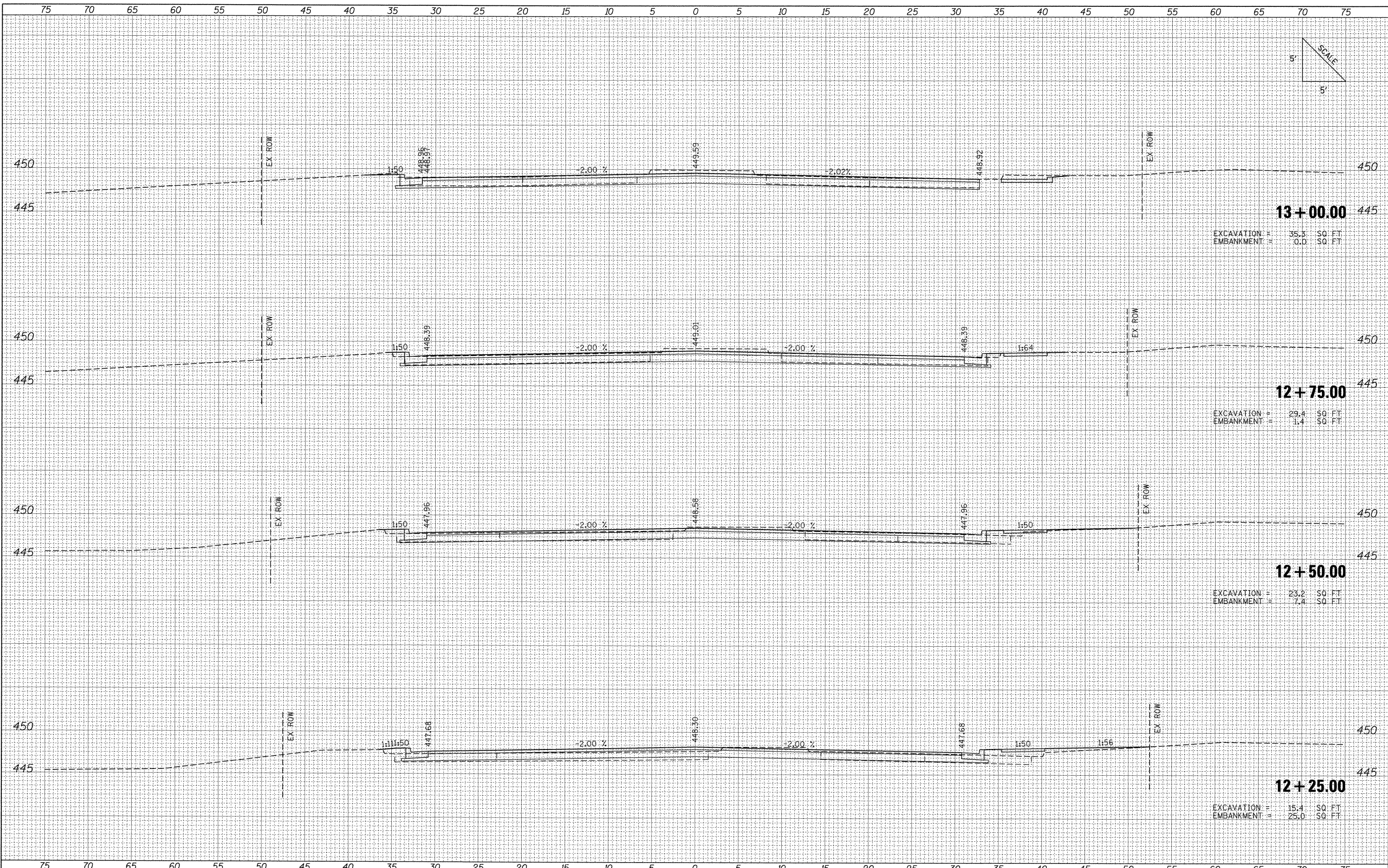
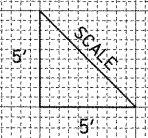

FILE NAME = I:\dot\0906603\draw\CADD_Sheets\0998859-sht-13-Marathon.dgn	USER NAME = Matt Overbey	DESIGNED - BMB	REVISED -	STATE OF ILLINOIS DEPARTMENT OF TRANSPORTATION	PROPOSED CROSS SECTIONS MARATHON DRIVE			F.A. RTE. 331	SECTION (IX-1) VB-1, B-1, N-4, R-3	COUNTY WILLIAMSON	TOTAL SHEETS 367	SHEET NO. 364
PLOT SCALE = 5,0000 "/ IN.	PLOT DATE = 12/13/2011	DRAWN - RAH	REVISED -		SCALE:	SHEET NO. OF SHEETS	STA. 12+25.00 TO STA. 13+00.00	CONTRACT NO. 98859				
CHECKED - SPH	DATE - 12/9/11	CHECKED - SPH	REVISED -		ILLINOIS FED. AID PROJECT							
DATE - 12/9/11	REVISED -	DATE - 12/9/11	REVISED -									