

NOTES:

1. IN ACCORDANCE WITH ARTICLE 259 OF THE SPECIAL PROVISIONS, APPROXIMATELY 127,000 C.Y. OF CEMENT KILN DUST (CKD) SHALL BE PLACED IN LIFTS WITHIN THE MINE REFUSE EXCAVATION AS IT IS PLACED IN ITS PLAN LOCATION IN REFUSE PILE 2 (SOUTH). APPROXIMATELY 43,000 C.Y. OF CKD ARE STOCKPILED ON TOP OF REFUSE PILE 1 (NORTH) AND MUST BE TRANSPORTED BY THE CONTRACTOR TO REFUSE PILE 2 FOR PLACEMENT. CKD DELIVERY TO THE REFUSE PILE 2 AREA IS ONGOING AND WILL CONTINUE UNTIL THE TOTAL OF APPROXIMATELY 127,000 C.Y. ARE ON THE PROJECT SITE. THE CONTRACTOR SHALL BE RESPONSIBLE FOR PROVIDING ACCESS AND COORDINATING DELIVERY FOR THE CKD. CEMENT KILN DUST PLACEMENT SHALL NOT BE MEASURED FOR PAYMENT, BUT SHALL BE CONSIDERED INCIDENTAL TO THE MINE REFUSE EXCAVATION.
2. DUE TO THE PRESENCE OF A LARGE NUMBER OF BOULDERS IN THE BORROW EXCAVATION AREA, A 10% SHRINKAGE FACTOR WAS ADDED TO ACCOUNT FOR THE ROCKS. THIS IS IN ADDITION TO A 12% SHRINKAGE FACTOR ASSUMED FOR THE SOIL. BOULDERS REMOVED FROM THE PILE ARE TO BE WINDROWED OR PILED ALONG THE BORROW AREA PERIMETER, OR AS DIRECTED BY THE ENGINEER.
3. THE DEPARTMENT WILL HAVE A SEPARATE ROAD IMPROVEMENT PROJECT UNDERWAY WHILE THIS RECLAMATION PROJECT IS OCCURRING. THE CONTRACTOR SHALL COMPLY WITH ARTICLE 105.08 OF THE I.D.O.T. "STANDARD SPECIFICATIONS FOR ROAD AND BRIDGE CONSTRUCTION". THE SHOOTING RANGE ROAD AND HAULAGE LANE ROAD WILL BE SURFACED AS PART OF THE ROAD IMPROVEMENT PROJECT. TEMPORARY ROAD CROSSINGS SHALL BE NECESSARY TO PROTECT ANY NEWLY SURFACED ROADS. ANY TEMPORARY ROAD CROSSINGS THAT MAY BE REQUIRED SHALL BE CONSTRUCTED ACCORDING TO ARTICLE 616 OF THE SPECIAL PROVISIONS AND DETAIL I SHOWN ON THIS SHEET. THE CONTRACTOR SHALL USE ONLY THE ROADS SHOWN ON THE PLANS (SEE SHEET 3) FOR MAJOR HAUL ROUTES FOR EARTH AND MINE REFUSE EXCAVATION. PROVIDENCE ROAD AND HAULAGE ROAD ARE PUBLIC ROADS UNDER JURISDICTION OF THE CARRIER MILLS TOWNSHIP ROAD COMMISSIONER. TRAFFIC CONTROL IN ACCORDANCE WITH THE STANDARD SHOWN OF SHEET 3 OF THE PLANS SHALL BE MAINTAINED AS DIRECTED BY THE ENGINEER. THE CONTRACTOR SHALL MAINTAIN SAFE LOCAL ACCESS TO HAULAGE ROAD AS MUCH AS POSSIBLE DURING THE CONSTRUCTION PERIOD. THE CONSTRUCTION SHALL BE SCHEDULED TO MINIMIZE INTERRUPTION OF TRAFFIC.
4. REFUSE PILE 1 (NORTH) HAS LARGE PREVIOUSLY CONSTRUCTED DE-WATERING TRENCHES THAT ARE NOT SHOWN ON THE PLAN TOPOGRAPHY OR CROSS SECTIONS. EXCAVATED MATERIAL FROM THE TRENCHES WAS PLACED ADJACENT TO THE TRENCH. THE VOLUME IS INCLUDED IN THE MINE REFUSE EXCAVATION QUANTITY.
5. ANY RAILROAD TIES ENCOUNTERED IN THE EXCAVATION SHALL BE NEATLY STACKED ON SITE, IN AN AREA APPROVED BY THE ENGINEER. ANY RAILS OR TIES SHALL NOT BE SALVAGED OR REMOVED FROM THE SITE. THE DEPARTMENT MAY HAVE A SEPARATE RAILROAD REMOVAL PROJECT UNDERWAY WHILE THIS RECLAMATION PROJECT IS OCCURRING. THE CONTRACTOR SHALL COMPLY WITH ARTICLE 105.08 OF THE I.D.O.T. "STANDARD SPECIFICATIONS FOR ROAD AND BRIDGE CONSTRUCTION".
6. IN ACCORDANCE WITH THE STORM WATER POLLUTION PREVENTION PLAN, THE CONTRACTOR SHALL INSTALL THE PERIMETER EROSION BARRIER PRIOR TO THE COMMENCEMENT OF ANY GRADING WORK.

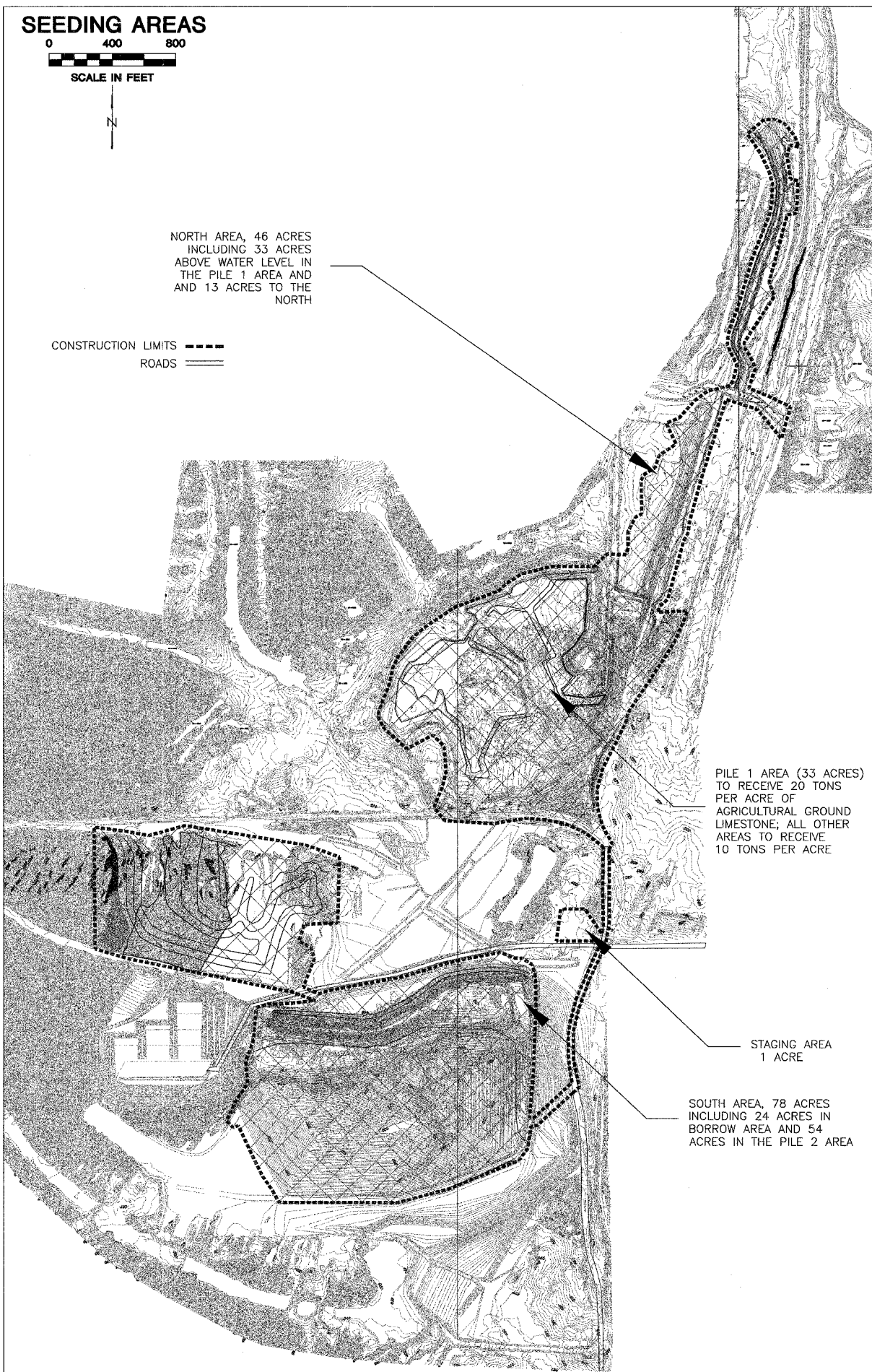
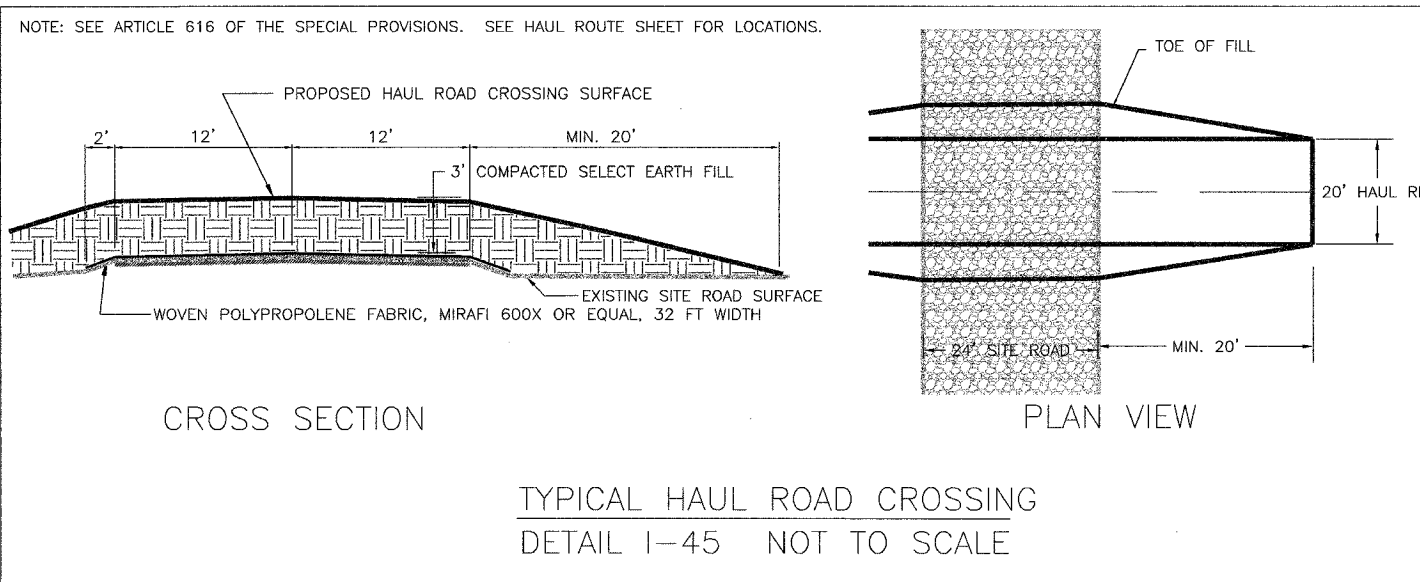
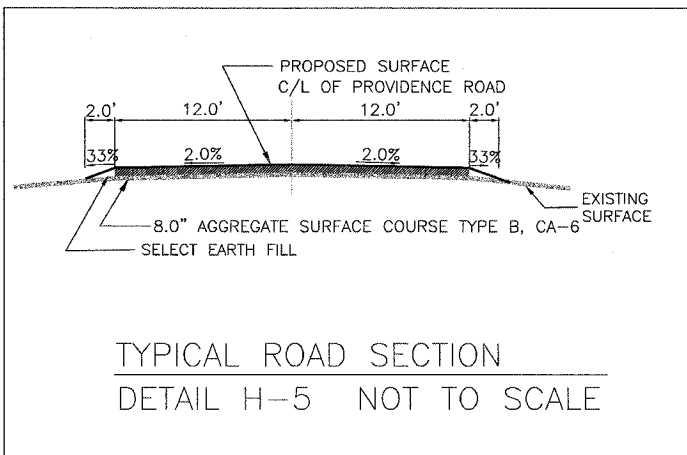
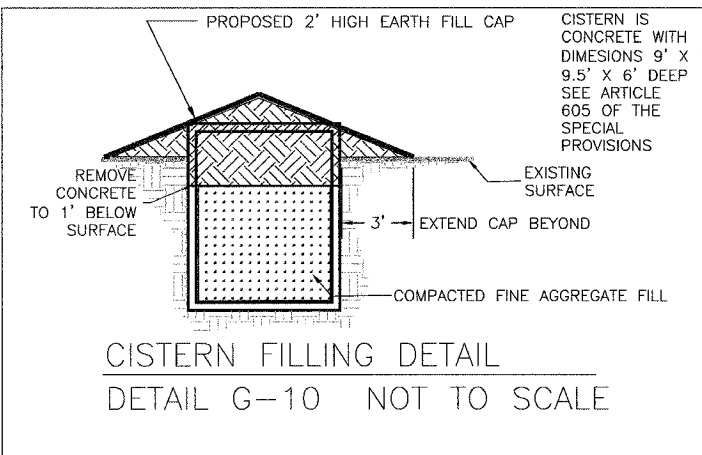

State of Illinois
 Department of Natural Resources

Sahara C.C. #6 Phase V
 Reclamation Project
 AML-GSIE-0317
 Saline County

Drawn By: M.T. 11-2005
 Checked By: J.P. 01/10/06
 2/19/06

Notes
 Sheet 43 of 45