

F.A.P. RTE.	SECTION	COUNTY	TOTAL SHEETS	SHEET NO.
330	91 Y-T	COOK	12	1

STATE OF ILLINOIS
DEPARTMENT OF TRANSPORTATION
DIVISION OF HIGHWAYS

PROPOSED HIGHWAY PLANS

FAP ROUTE 330: US 12 / 20 / 45 (MANNHEIM ROAD)
AT (1107 MANNHEIM RD.) NORTH OF IL 38 (ROOSEVELT RD.)

SECTION: 91Y - T
DRAINAGE IMPROVEMENT
COOK COUNTY
C-91-077-06

FOR INDEX OF SHEETS, SEE SHEET NO. 2

IMPROVEMENT IS LOCATED IN
THE VILLAGE OF WESTCHESTER

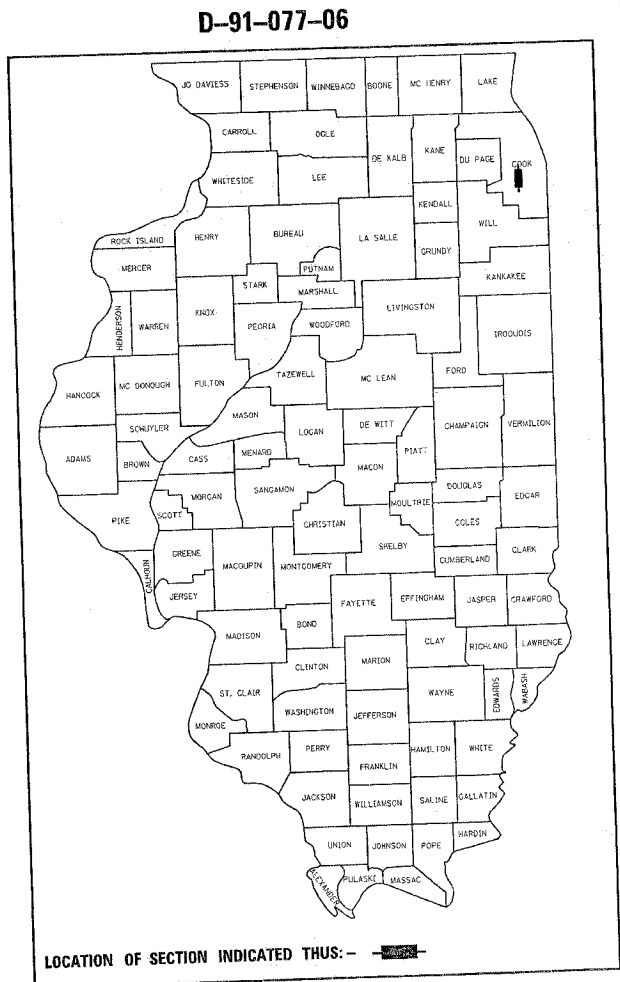

DISTRICT ONE DESIGN PLAN PREPARATION ENGINEER: KEN ENG / JENPAI CHANG (847) 705-4432

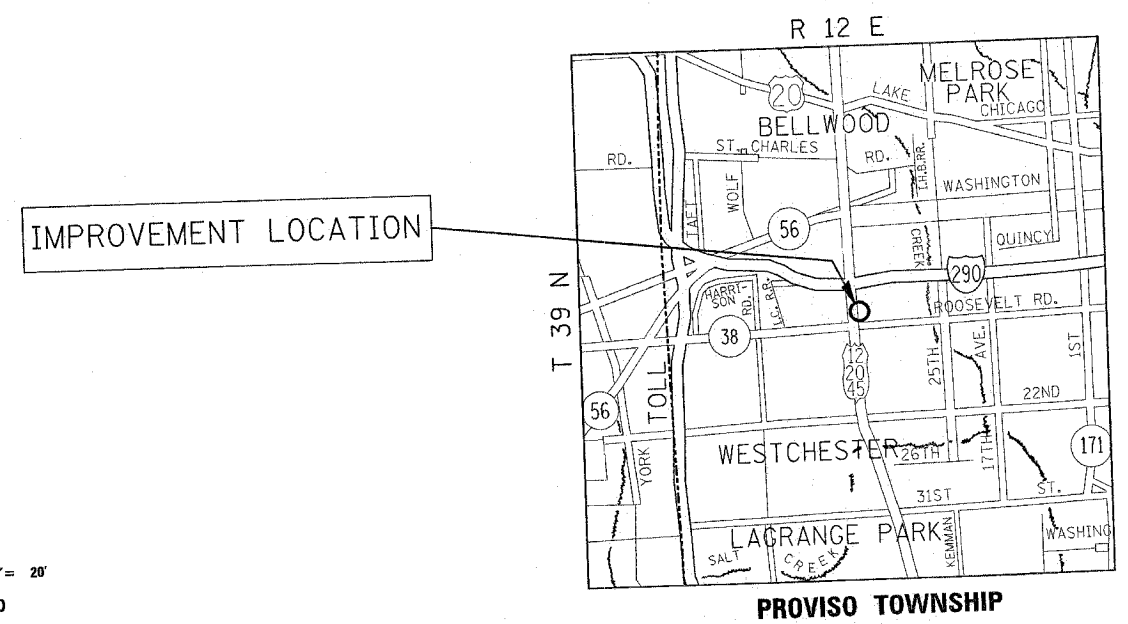

TRAFFIC DATA
2004 ADT = 44,800
POSTED SPEED LIMIT = 45 MPH

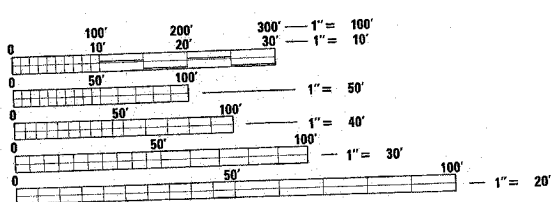

FULL SIZE PLANS HAVE BEEN PREPARED USING STANDARD ENGINEERING SCALES. REDUCED SIZED PLANS WILL NOT CONFORM TO STANDARD SCALES. IN MAKING MEASUREMENTS ON REDUCED PLANS, THE ABOVE SCALES MAY BE USED.

J.U.L.I.E.
JOINT UTILITY LOCATION INFORMATION FOR EXCAVATION
1-800-892-0123

STATE OF ILLINOIS
DEPARTMENT OF TRANSPORTATION
DIVISION OF HIGHWAYS

SUBMITTED Dec. 17 2005
Diane M. O'Keefe / CO
DEPUTY DIRECTOR OF HIGHWAYS, REGION ENGINEER

February 3, 2006
Mike Hine / RD
ENGINEER OF DESIGN AND ENVIRONMENT

February 3, 2006
Milton R. Sosa, P.E. / RD
DIRECTOR OF HIGHWAYS, CHIEF ENGINEER

PRINTED BY THE AUTHORITY
OF THE STATE OF ILLINOIS

CONTRACT NO. 60A59