

F.A.P. RFL	SECTION	COUNTY	TOTAL SHEETS	SHEET NO.
309	16R-2	WHITESIDE	547	126
STA. 1162+00 TO STA. 1168+00				
FED. ROAD DIST. NO. 2 ILLINOIS		FED. AID PROJECT		

YOUNG ENTERPRISES,
AN ILLINOIS PARTNERSHIP

JBKM INC.

MIDWEST INVESTMENTS, L.P.

60 FT. - PIPE CULVERTS, CLASS D,
TYPE 1 15" WITH METAL END SECTIONS 15"
STA. 1166+50.00, 42.49' LT., INV. = 639.72 TO
STA. 1167+0.00, 44.51' LT., INV. = 639.48

PARKING

MATCH LINE STA 1162+00

MATCH LINE STA 1168+00

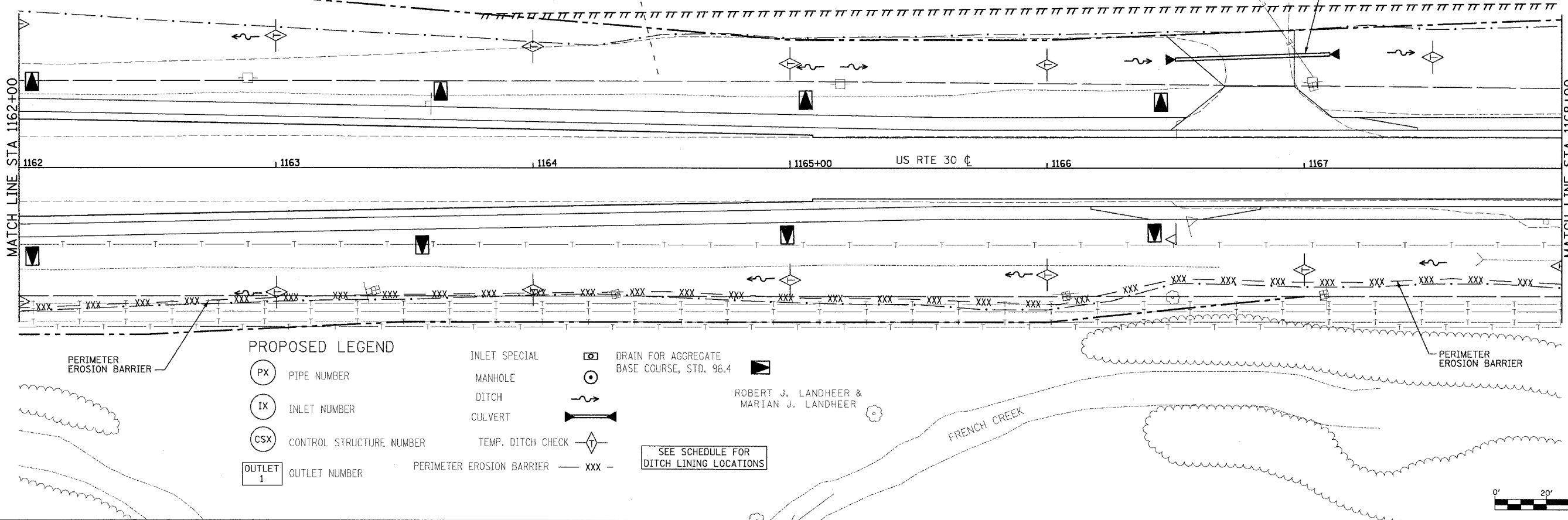

PROPOSED LEGEND

- (PX) PIPE NUMBER
- (IX) INLET NUMBER
- (CSX) CONTROL STRUCTURE NUMBER
- OUTLET 1 OUTLET NUMBER
- INLET SPECIAL
- MANHOLE
- DITCH
- CULVERT
- TEMP. DITCH CHECK
- PERIMETER EROSION BARRIER
- DRAIN FOR AGGREGATE BASE COURSE, STD. 96.4
- PERIMETER EROSION BARRIER

SEE SCHEDULE FOR
DITCH LINING LOCATIONS

ROBERT J. LANDHEER &
MARIAN J. LANDHEER

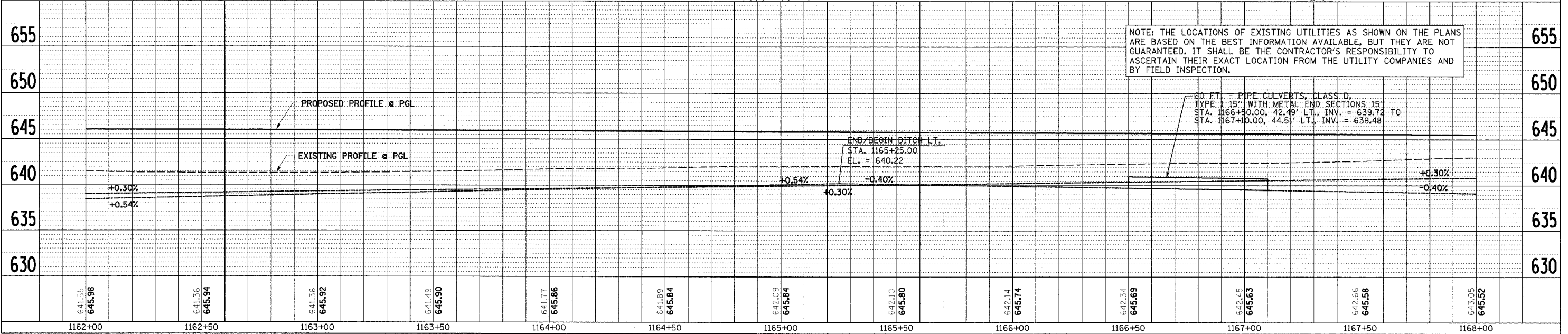
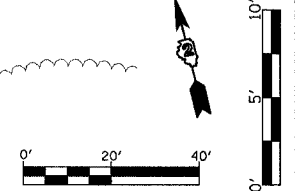

NOTE: THE LOCATIONS OF EXISTING UTILITIES AS SHOWN ON THE PLANS ARE BASED ON THE BEST INFORMATION AVAILABLE, BUT THEY ARE NOT GUARANTEED. IT SHALL BE THE CONTRACTOR'S RESPONSIBILITY TO ASCERTAIN THEIR EXACT LOCATION FROM THE UTILITY COMPANIES AND BY FIELD INSPECTION.

60 FT. - PIPE CULVERTS, CLASS D,
TYPE 1 15" WITH METAL END SECTIONS 15"
STA. 1166+50.00, 42.49' LT., INV. = 639.72 TO
STA. 1167+0.00, 44.51' LT., INV. = 639.48

DATE: _____ BY: _____

PROPOSED: _____
REVISED: _____
NOTED: _____
CHECKED: _____
DATE: _____

DATE: _____ BY: _____

PROFILE: _____
REVISED: _____
NOTED: _____
CHECKED: _____
DATE: _____

DATE: _____ BY: _____

PROFILES: _____
REVISED: _____
NOTED: _____
CHECKED: _____
DATE: _____

DRAINAGE AND EROSION CONTROL PLANS (US RTE 30)