

F.A.P. RTE.	SECTION	COUNTY	TOTAL SHEETS	SHEET NO.
309	16R-2	WHITESIDE	647	152
STA. 1108+00		TO STA. 1114+00		
FED. ROAD DIST. NO. 2 ILLINOIS FED. AID PROJECT				

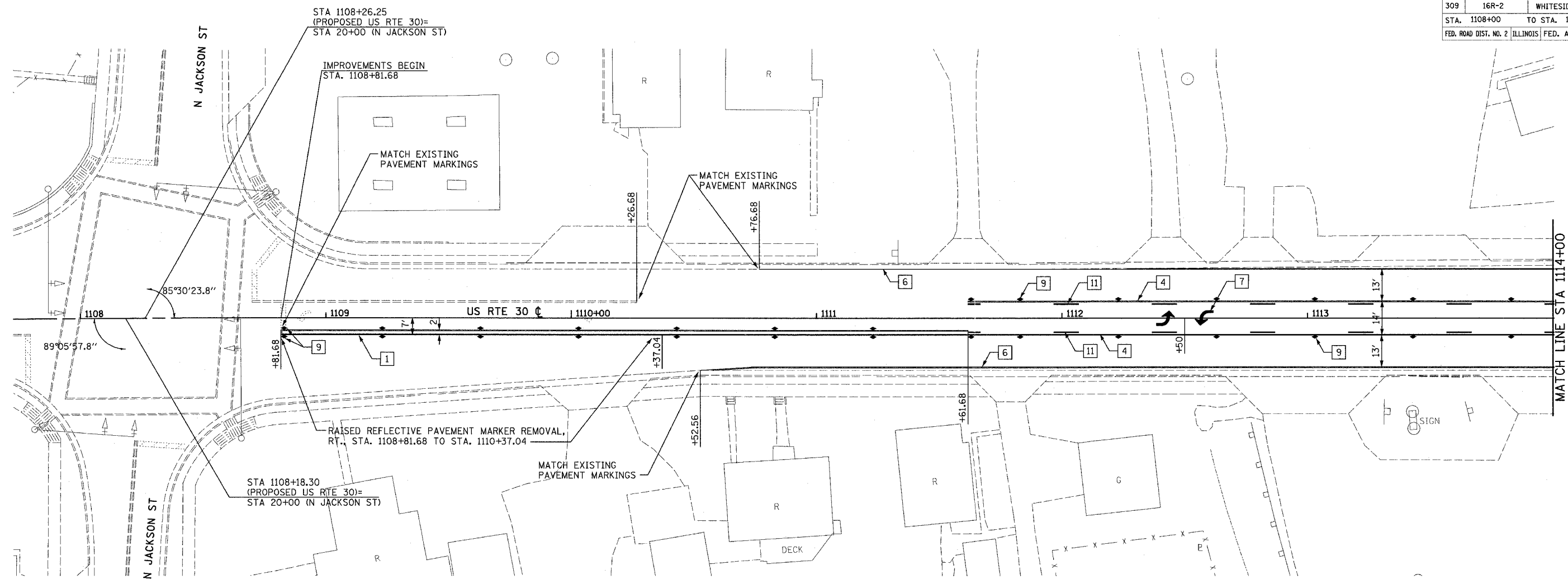

**LEGEND**

- 1 POLYUREA PAVEMENT MARKING TYPE I - LINE 4", DOUBLE YELLOW
- 2 POLYUREA PAVEMENT MARKING TYPE I - LINE 12", YELLOW DIAGONAL @ 20' O.C.
- 3 POLYUREA PAVEMENT MARKING TYPE I - LINE 24", WHITE STOP LINE
- 4 POLYUREA PAVEMENT MARKING TYPE I - LINE 4", YELLOW
- 5 POLYUREA PAVEMENT MARKING TYPE I - LINE 8", WHITE
- 6 PREFORMED PLASTIC PAVEMENT MARKING, TYPE B - LINE 4", WHITE
- 7 POLYUREA PAVEMENT MARKING TYPE I - LETTERS AND SYMBOLS, WHITE
- 8 ▷ RAISED REFLECTIVE PAVEMENT MARKER, ONE-WAY CRYSTAL
- 9 ◆ RAISED REFLECTIVE PAVEMENT MARKER, TWO-WAY AMBER
- 10 ► RAISED REFLECTIVE PAVEMENT MARKER, ONE-WAY AMBER
- 11 POLYUREA PAVEMENT MARKING TYPE I - LINE 4", YELLOW LANE LINE SKIP DASH

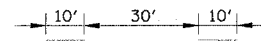

REVISIONS	
NAME	DATE

ILLINOIS DEPARTMENT OF TRANSPORTATION  
 PAVEMENT MARKING PLAN  
 FAP ROUTE 309 (US 30)  
 SECTION 16R-2  
 EAST CONTRACT  
 FROM 0.2 MILE EAST OF JACKSON ST.  
 TO FRENCH CREEK, WHITESIDE COUNTY

SCALE: 1=20  
 DATE 07/21/05  
 DRAWN BY CAM  
 CHECKED BY RDY