

Bench Mark: Chiseled "□" on Step at Station 1134+34.3, 49.50' Rt. Elevation = 667.39  
 Existing Structure: None

STATE OF ILLINOIS  
 DEPARTMENT OF TRANSPORTATION

ROUTE NO.	SECTION	COUNTY	TOTAL SHEETS	SHEET NO.	SHEET NO. 1
F.A.P. 309	16R-2	WHITESIDE	647	172	11 SHEETS
FED. ROAD DIST. NO. 4	ILL. DIST.	FED. AID PROJECT			

Contract No. 64969

DESIGN SPECIFICATIONS

2002 AASHTO Standard Specifications For Highway Bridges

DESIGN STRESSES

FIELD UNITS

$f'_c = 3,500$  psi  
 $f_y = 60,000$  psi (reinforcement)  
 $f_y = 36,000$  psi (M270 Gr. 36 structural steel)

CURVE DATA

PI STA. 1135+73.94  
 $\Delta = 0^\circ 28' 00.78''$  (RT)  
 $D = 0^\circ 03' 30.10''$   
 $R = 98,174.99'$   
 $T = 400.00'$   
 $L = 799.99'$   
 $E = 0.8149'$   
 $L.C. = 799.99'$   
 P.C. STA. = 1131+73.94  
 P.T. STA. = 1139+73.93

INDEX OF SHEETS

Sht. #	Title
1	General Plan
2	Section, Profile Grade, and Drain Details
3	General Notes, Details, & Total Bill of Material
4	Soldier Pile Wall Panel 1
5	Soldier Pile Wall Panel 2
6	Soldier Pile Wall Panel 3
7	Concrete Facing for Soldier Pile Walls
8-11	Boring Logs

Notes:

1. See Sht. 2 for Section A-A.

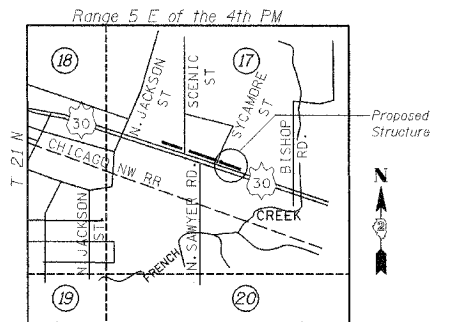

LOCATION SKETCH

GENERAL PLAN  
 RETAINING WALL NO. 2  
 U.S. RTE. 30 (LINCOLN HIGHWAY)  
 EAST OF SYCAMORE ST.  
 F.A.P. ROUTE 309 SECTION 16 R-2  
 WHITESIDE COUNTY  
 STA. 1131+71.68 TO  
 STA. 1133+44.95 (LT.)  
 STRUCTURE NO. 098-7002

**STS CONSULTANTS**  
 111 NE Jefferson Ave.  
 Peoria, Illinois 61602  
 Ph: (309) 676-8464  
 Fax: (309) 676-5445  
 IL Design Firm Reg. No. 184-001518

LEGEND

- Existing Roadway
- Sign Post
- Power Pole
- Light Pole
- Telephone Pole
- Telephone Splice Box
- Telephone Double Handhole
- Fire Hydrant
- Manhole
- Inlet
- Existing Overhead Electric
- Existing Storm Sewer
- Construction Joint
- Expansion Joint
- Pile Designation
- Soil Borings

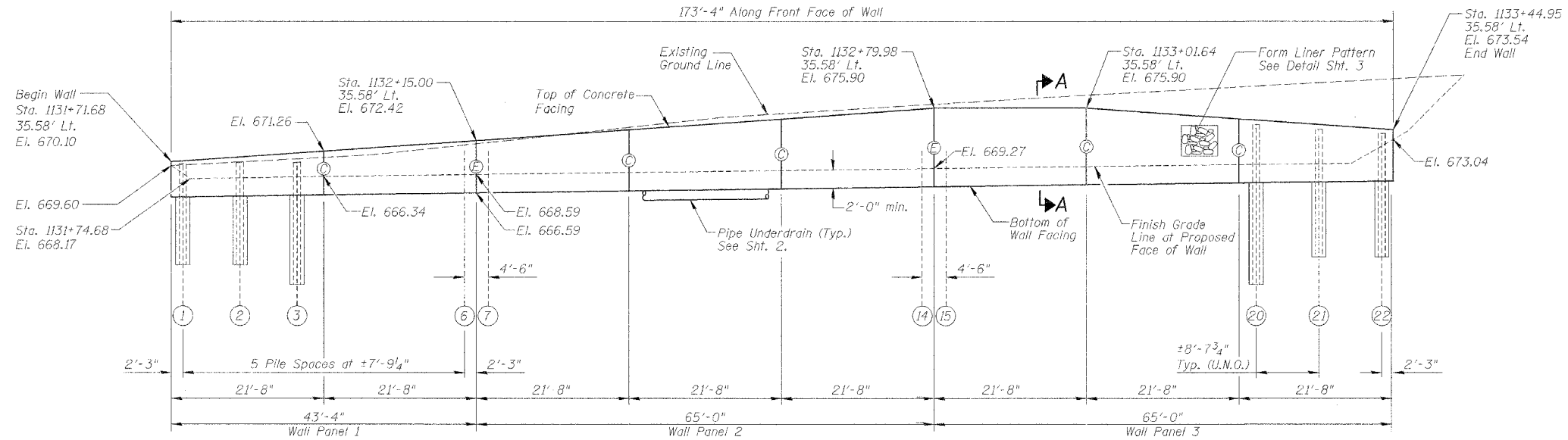

ELEVATION  
 (Looking North)

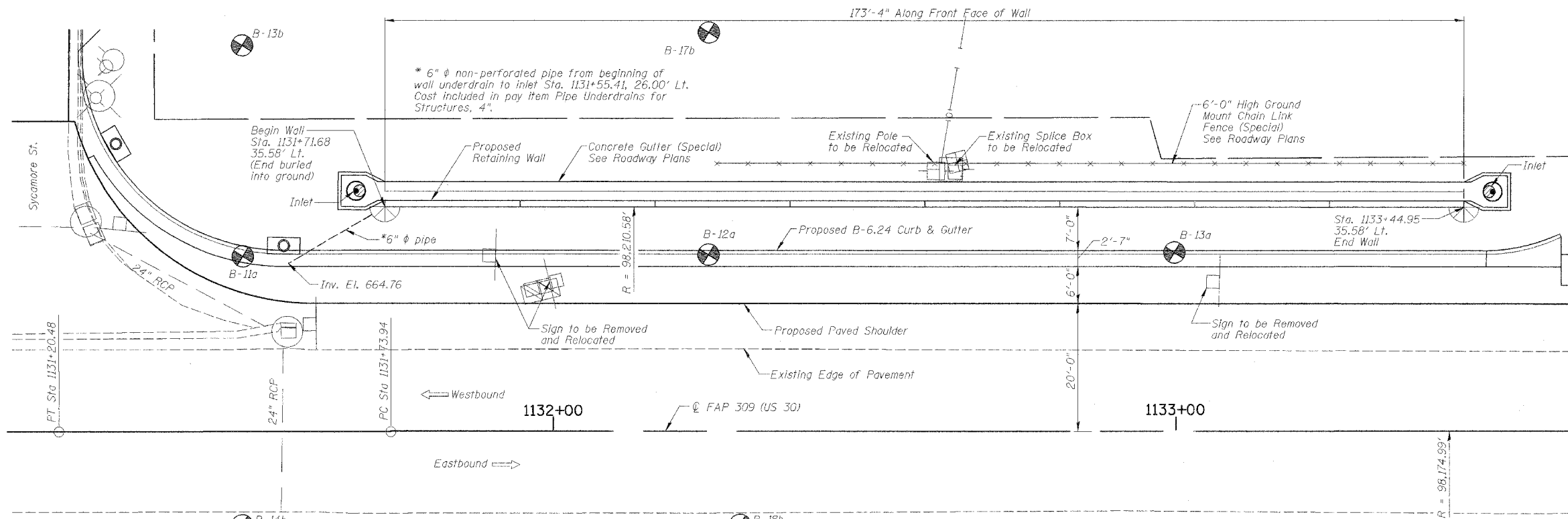

PLAN

Notes:

- Expansion joints shall be provided at 65'-0" intervals, U.N.O.
- Construction joints shall be provided at 21'-8" intervals. Reinforcing steel shall be placed continuously through construction joints.
- All offsets shown to face of wall at finish grade level from @ U.S. Rte. 30

DESIGNED	LLV
CHECKED	P.JL
DRAWN	MGM
CHECKED	LLV

APPROVED  
 FOR STRUCTURAL ADEQUACY ONLY

*Ralph C. Anderson*  
 ENGINEER OF BRIDGES AND STRUCTURES

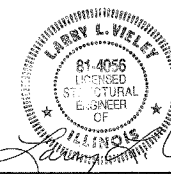

Larry L. Velej  
 Illinois Licensed Structural Engineer No. 081-004056  
 Lic. Expires: 11/30/06

12/08/05

Date