

STATE OF ILLINOIS
DEPARTMENT OF TRANSPORTATION

ROUTE NO.	SECTION	COUNTY	TOTAL SHEETS	SHEET NO.
F.A.P. 309	16R-2	WHITESIDE	647	173
FED. ROAD DIST. NO. 4	ILLINOIS	FED. AID PROJECT		

Contract No. 64969

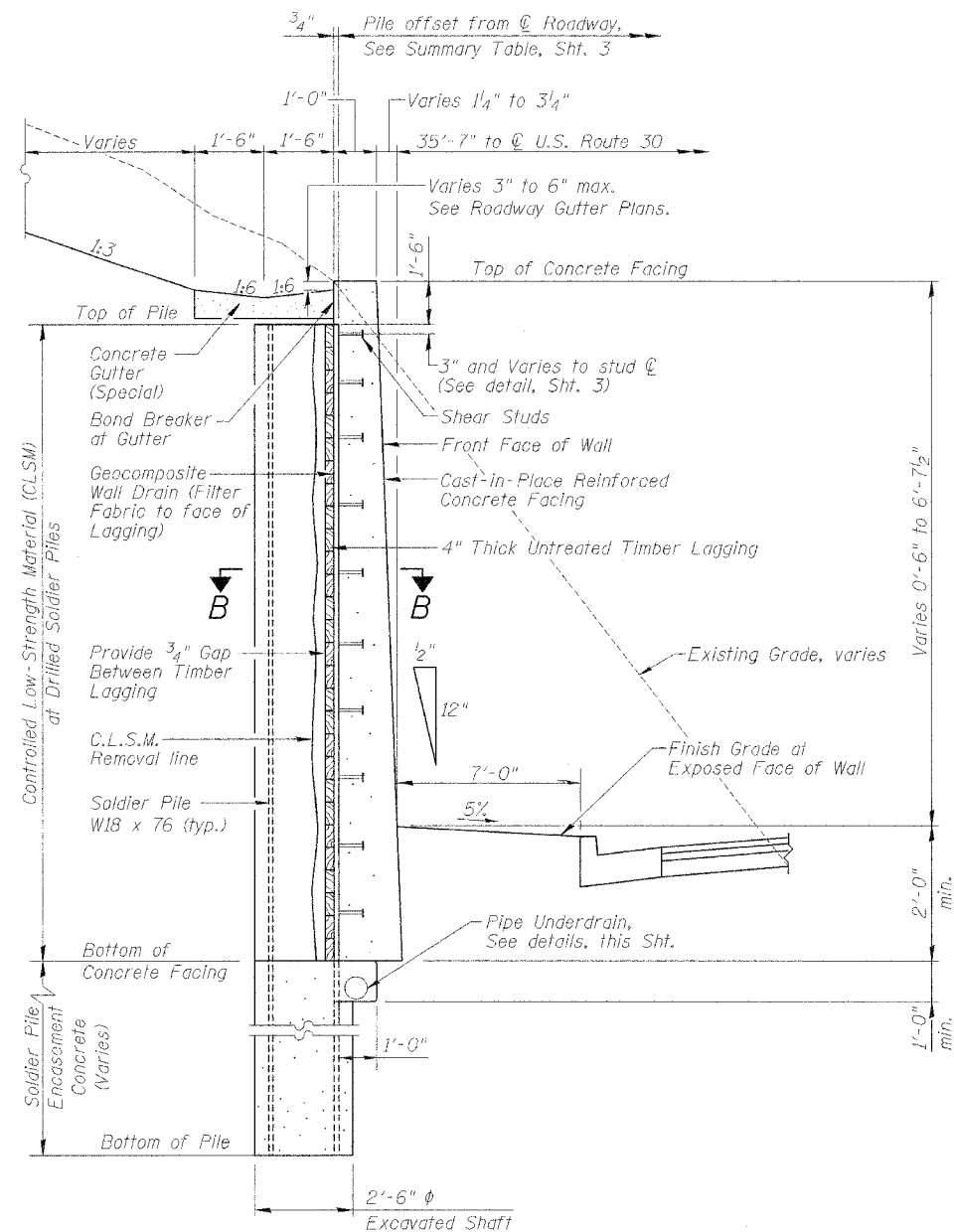

SECTION A-A
RETAINING WALL TYPICAL SECTION
See Sht. 3 for Section B-B.

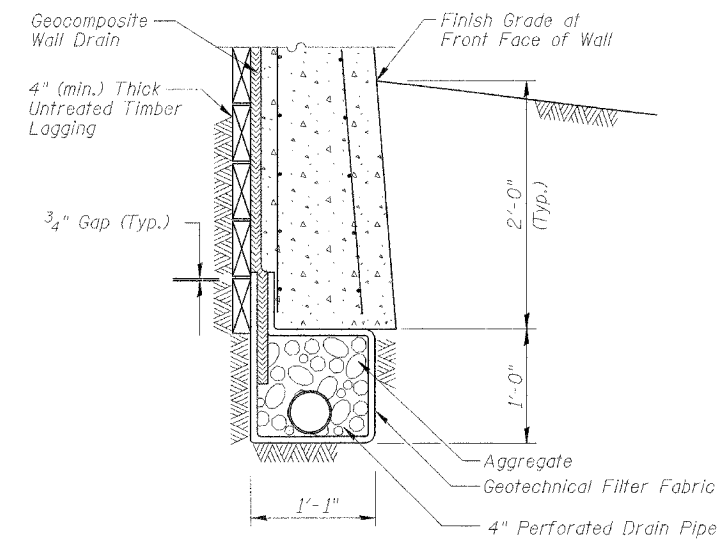

UNDERDRAIN DETAIL
(Between Soldier Piles)

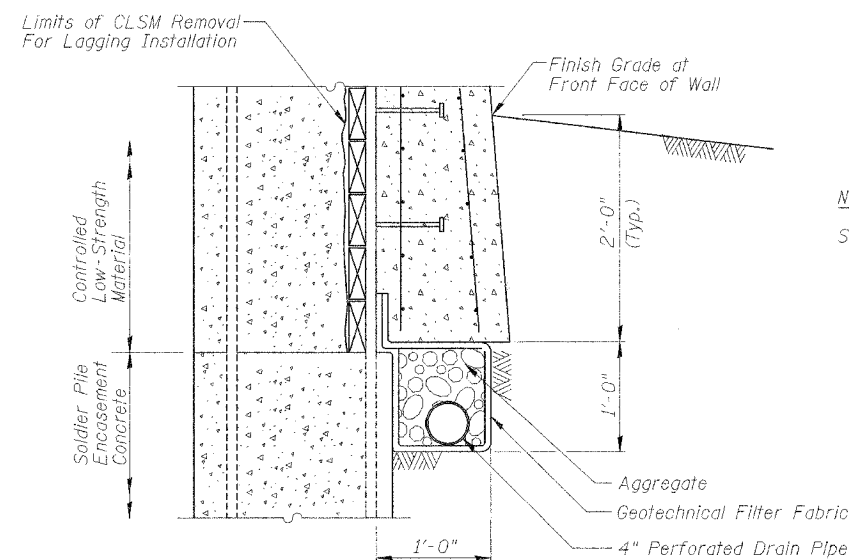

UNDERDRAIN DETAIL
(At Soldier Piles)

Note:
See Special Provision for Pipe Underdrains for Structures, 4".

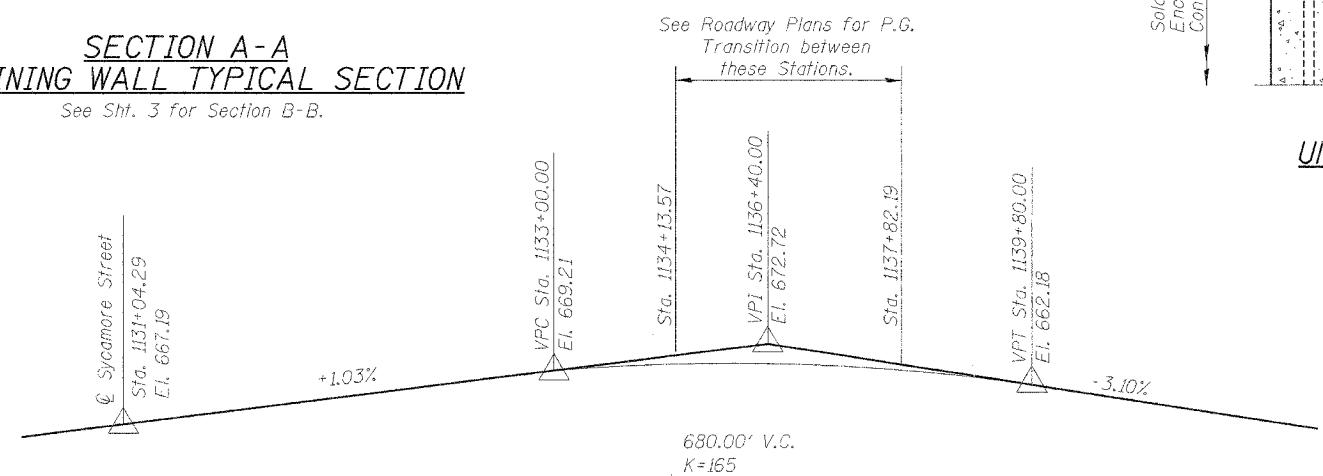

PROFILE GRADE U.S. RTE. 30
(Along Centerline of Roadway)

DESIGNED	LLV
CHECKED	PJL
DRAWN	MGM
CHECKED	LLV

SECTION, PROFILE GRADE AND DRAIN DETAILS
RETAINING WALL NO. 2
U.S. RTE. 30 (LINCOLN HIGHWAY)
EAST OF SYCAMORE ST.
F.A.P. ROUTE 309 SECTION 16 R-2
WHITESIDE COUNTY
STA. 1131+71.68 TO
STA. 1133+44.95 (LT.)
STRUCTURE NO. 098-7002

STS CONSULTANTS
111 NE Jefferson Ave.
Peoria, Illinois 61602
Ph (309) 676-8464
FAX (309) 676-5445
IL Design Firm Reg. No. 184-001518