

STATE OF ILLINOIS  
DEPARTMENT OF TRANSPORTATION

ROUTE NO.	SECTION	COUNTY	TOTAL SHEETS	SHEET NO.	SHEET NO. 2 5 SHEETS
F.A.P. 309	16R-2	WHITESIDE	547	184	
FED. ROAD DIST. NO. 2	ALLEGES	FED. AID PROJECT			

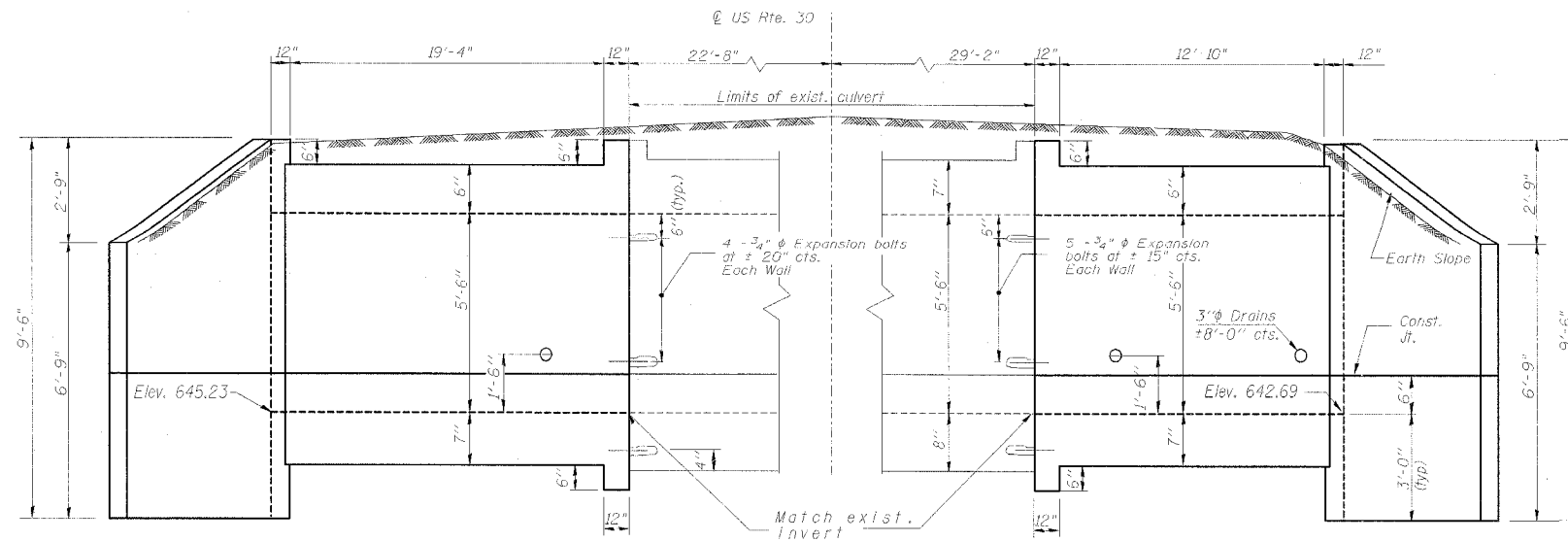

ELEVATION

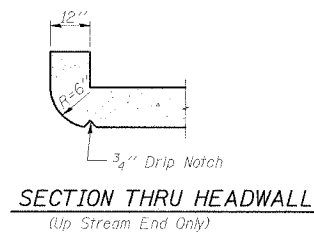

BILL OF MATERIAL

Bar	No.	Size	Length	Shape
a <sub>1</sub>	134	#5	6'-0"	U
a <sub>2</sub>	20	#4	4'-3"	—
d	10	#4	4'-6"	L
h	19	#5	21'-1"	—
h <sub>1</sub>	10	#4	21'-1"	—
h <sub>2</sub>	32	#5	11'-6"	—
h <sub>3</sub>	28	#5	8'-0"	—
h <sub>4</sub>	12	#6	4'-10"	—
h <sub>5</sub>	19	#5	14'-7"	—
h <sub>6</sub>	10	#4	14'-7"	—
v	98	#4	6'-0"	—
v <sub>1</sub>	16	#4	9'-0"	—
Concrete Box Culverts				Cu. Yd. 24.7
Reinforcement Bars				Pound 3,336
Expansion Bolts 3/4" φ				Each 38

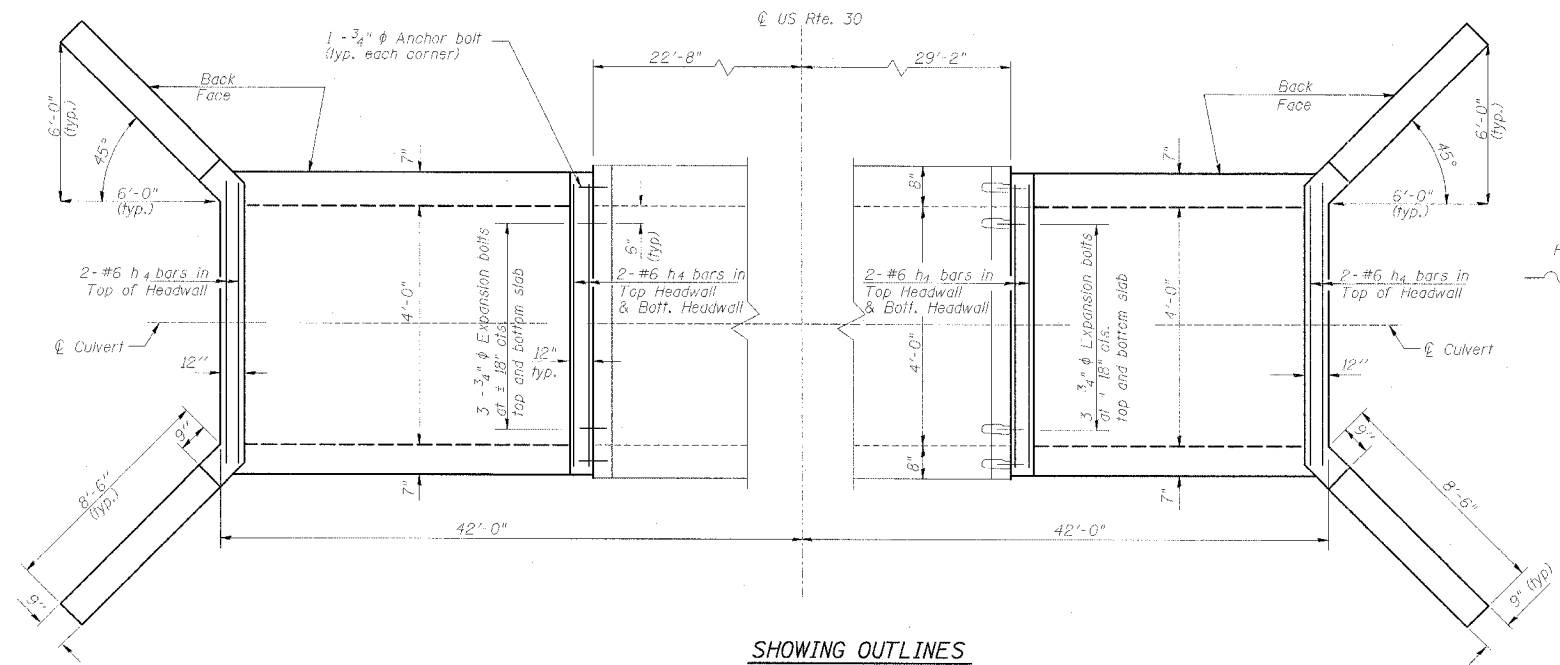

SHOWING OUTLINES

NOTE:  
Work this sheet with sheet 3 of 5.

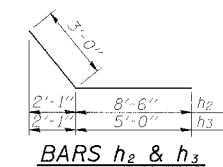

BARS h<sub>2</sub> & h<sub>3</sub>



BAR a<sub>1</sub>



BAR d

DESIGNED	GEK
CHECKED	LSA
DRAWN	GEK
CHECKED	LSA

CULVERT DETAILS  
US RTE. 30 - CATTLE PASS  
F.A.P. ROUTE 309 SECT. 16 R-2  
WHITESIDE COUNTY  
STATION 1146+76.26



111 W. Washington St., Suite 1750  
Chicago, IL 60602  
Ph.(312)628-3886  
Fax(312)628-3892  
IL Design Firm Registration  
No. 184-001518