

STATE OF ILLINOIS
DEPARTMENT OF TRANSPORTATION

ROUTE NO.	SECTION	COUNTY	TOTAL SHEETS	SHEET NO.
F.A.P. 309	16R-2	WHITESIDE	547	190
FED. ROAD DIST. NO. 4	ILLINOIS	FED. AID PROJECT		

Contract # 64969

SHEET NO. 3
7 SHEETS

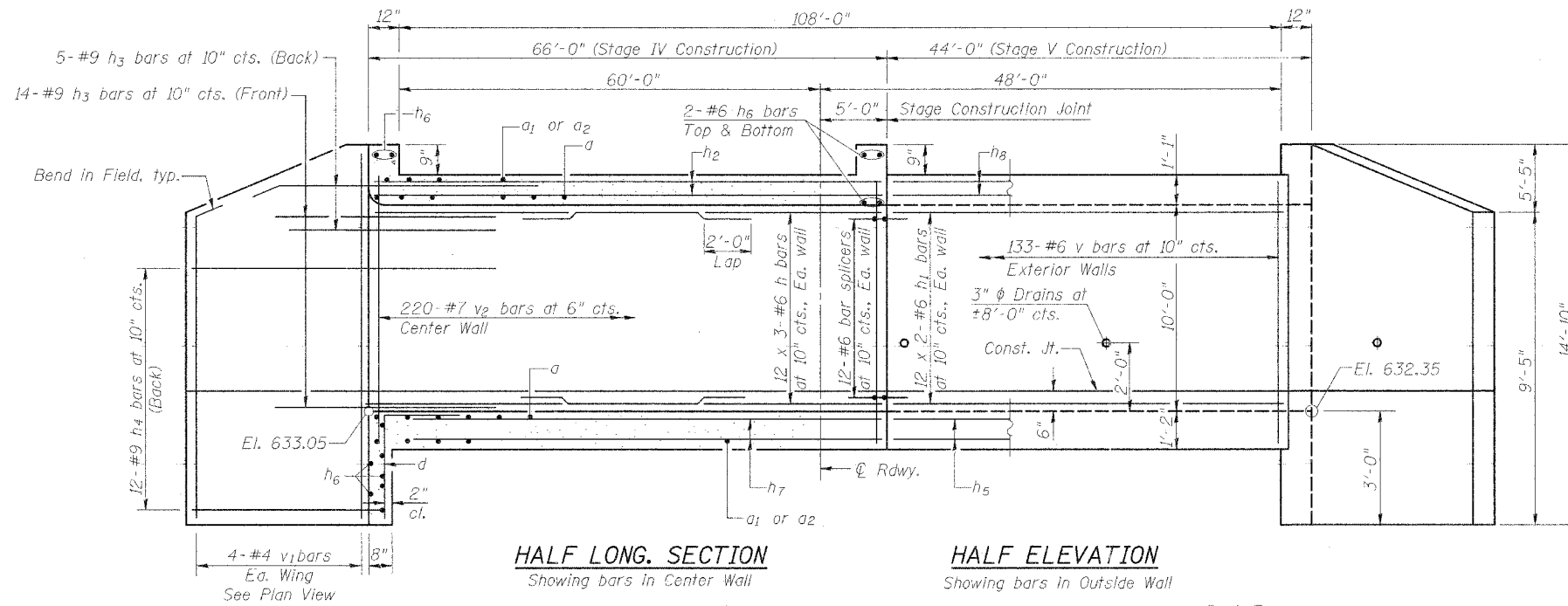

MIN. BAR LAPS

#5 = 1'-8"
#6 = 2'-0"

BILL OF MATERIAL

Bar	No.	Size	Length	Shape
a	220	#9	28'-8"	U
a1	266	#9	10'-0"	—
a2	228	#4	10'-1"	—
d	54	#4	4'-6"	L
h	108	#6	23'-3"	—
h1	72	#6	22'-10"	—
h2	162	#5	23'-0"	—
h3	76	#9	8'-0"	—
h4	48	#9	17'-9"	—
h5	128	#5	22'-8"	—
h6	18	#6	26'-0"	—
h7	192	#5	23'-0"	—
h8	108	#5	22'-8"	—
Concrete Box Culverts			Cu. Yd.	386.1
Reinforcement Bars			Pound	68,510

See Sht. 4 for Section A-A.
See Sht. 4 for Section Thru Culvert Barrel.

TOP AND BOTTOM SLAB LAYOUT
PLAN FOR TWO CELL CULVERT
US RTE. 30 OVER UNNAMED CREEK
F.A.P. ROUTE 309 SECT. 16R-2
WHITESIDE COUNTY
STATION 1158+14.82
STRUCTURE NO. 098-2025

STS CONSULTANTS
111 NE Jefferson Ave.
Peoria, Illinois 61602
Ph (309) 676-8464
FAX (309) 676-5445
IL Design Firm Reg. No. 64-00156

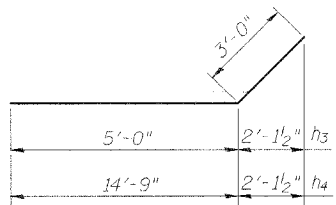

BARS h3 & h4

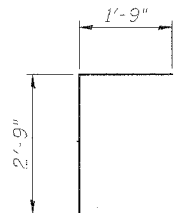

BAR d

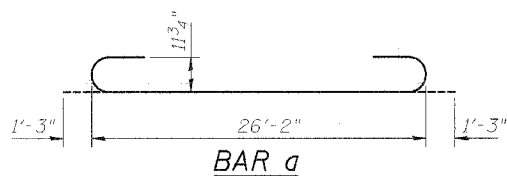

BAR a

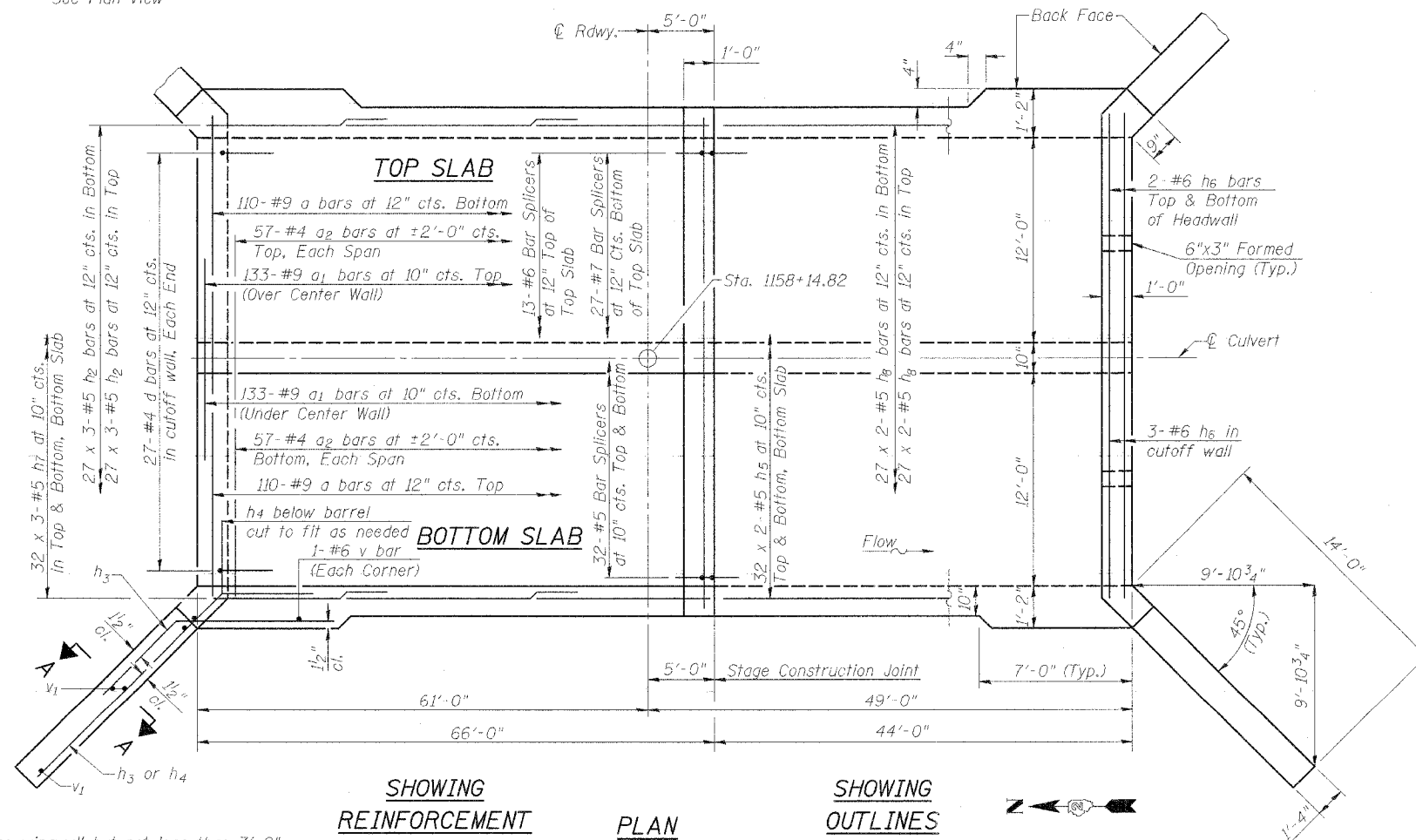

SHOWING REINFORCEMENT PLAN

SHOWING OUTLINES

DESIGNED	LLV
CHECKED	e
DRAWN	MGM
CHECKED	LLV

Notes:

- A distance of half the length of the wingwall but not less than 7'-0" of the barrel shall be poured monolithically with the wingwalls.
- Bars indicated thus 12 x 4-#5 etc. indicates 12 lines of #5 bars with 4 lengths per line.