

F.A.P. RTE.	SECTION	COUNTY	TOTAL SHEETS	SHEET NO.
309	16R-2	WHITESIDE	577	437
STA. 1129+00.00 TO STA. 1129+25.00			690	
FED. ROAD DIST. NO. 2 ILLINOIS FED. AID PROJECT				

IT SHALL BE THE CONTRACTOR'S RESPONSIBILITY TO ASCERTAIN THE LOCATIONS OF EXISTING WATER MAINS, GAS MAINS, SEWERS, ELECTRIC POWER LINES, TELEPHONE LINES AND OTHER UTILITIES FROM THE UTILITY COMPANIES AND BY FIELD INSPECTION.

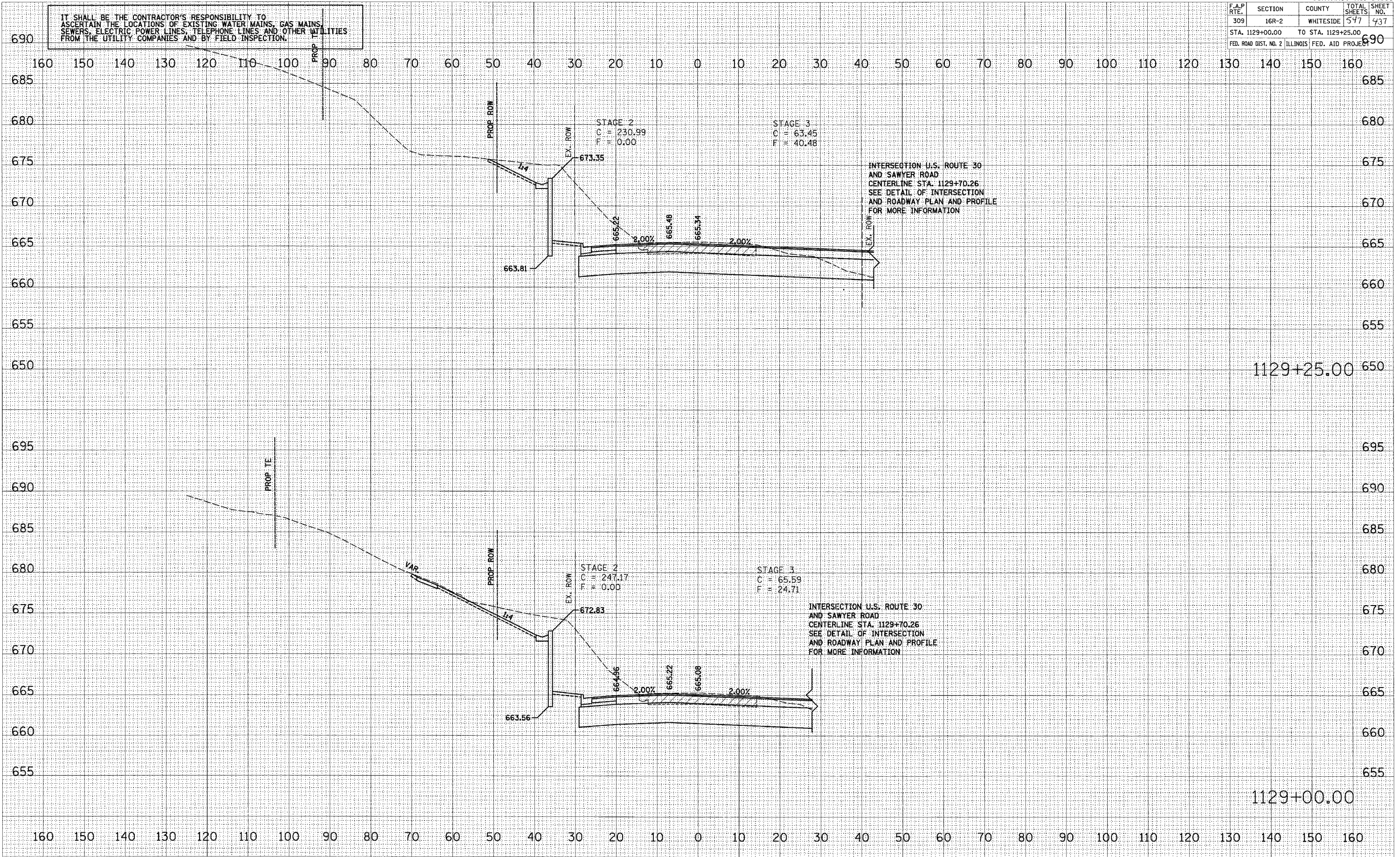

INTERSECTION U.S. ROUTE 30 AND SAWYER ROAD  
CENTERLINE STA. 1129+70.26  
SEE DETAIL OF INTERSECTION AND ROADWAY PLAN AND PROFILE FOR MORE INFORMATION

INTERSECTION U.S. ROUTE 30 AND SAWYER ROAD  
CENTERLINE STA. 1129+70.26  
SEE DETAIL OF INTERSECTION AND ROADWAY PLAN AND PROFILE FOR MORE INFORMATION

DATE	BY

DATE	BY

PLOT DATE = DATE  
FILE NAME = FILEL  
PLOT SCALE = SCALES  
USER NAME = USER