

F.A.P. RTE.	SECTION	COUNTY	TOTAL SHEETS	SHEET NO.
309	16R-2	WHITESIDE	577	457
STA. 1135+75.00		TO STA. 1135+75.10		
FED. ROAD DIST. NO. 2		ILLINOIS FED. AID PROJECT		

IT SHALL BE THE CONTRACTOR'S RESPONSIBILITY TO ASCERTAIN THE LOCATIONS OF EXISTING WATER MAINS, GAS MAINS, SEWERS, ELECTRIC POWER LINES, TELEPHONE LINES AND OTHER UTILITIES FROM THE UTILITY COMPANIES AND BY FIELD INSPECTION.

BY	DATE

BY	DATE

DATE	
FILE NAME	
PLOT SCALE	
USER NAME	

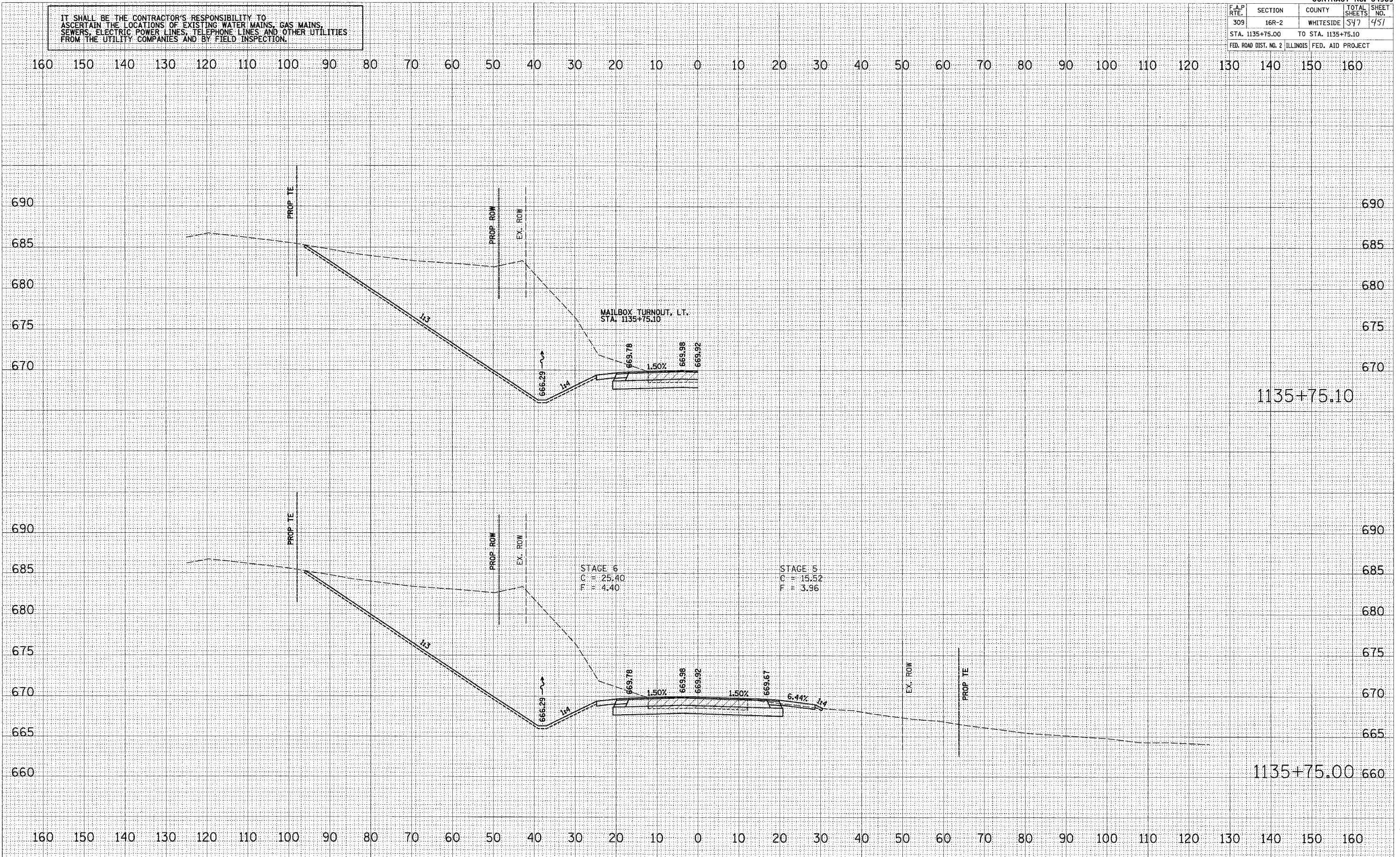

1135+75.10

1135+75.00